

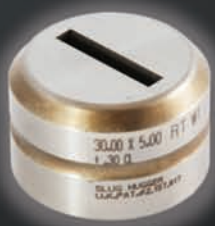

WILSON TOOL REPLACEMENT AMADA TOOLING

A Cost Effective
Solution for Long
Lasting Durability

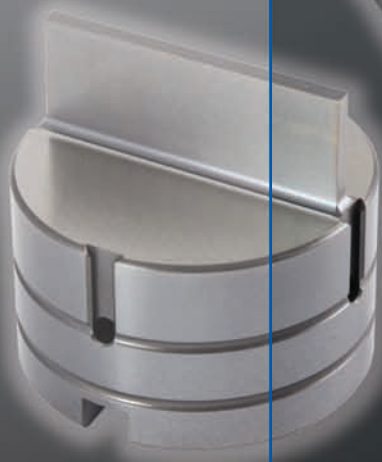

Terms and Conditions

Credit	All orders are subject to the approval of our credit department. If you are a new account, please furnish us with a bank reference and three supplier references. A credit limit will be imposed on new accounts until credit has been established.
Payment	Terms are net 30 days.
Cancellation	In the event an order is cancelled, charge will be made to cover labour, materials and overheads.
Returned Material	A handling charge of 25% is made on all standard parts returned for credit. Written permission and shipping instructions must be obtained before the return of any material. Special tooling cannot be returned.
Claims	All claims for shortages must be made within 3 days of the invoice date.
Prices	Prices and specifications subject to change without prior notice. E & OE. All prices are exclusive of VAT.

Table of Contents

Optima™ Coating	2
Ultima™ Tool Steel	3
Features and Benefits of Wilson Replacement Amada Tooling – Quick-Adjust A & B Stations	4
Features and Benefits of Wilson Replacement Amada Tooling – C, D & E Stations	5
Wilson Amada Style Quick Adjust A Station	6
Wilson Amada Style A Station	7
Wilson Amada Style Quick Adjust B Station	8
Wilson Amada Style B Station	9
Wilson Amada Style C Station	10
Wilson Amada Style D Station	11
Wilson Amada Style E Station	12
Wilson Amada ABS Tooling	13
Wilson Amada Style ABS Quick Adjust A Station	14
Wilson Amada Style ABS A Station	15
Wilson Amada Style ABS Quick Adjust B Station	16
Wilson Amada Style ABS B Station	17
Wilson Amada Style ABS C Station	18
Wilson Amada Style ABS Quick Release C Station	19
Wilson Amada Style ABS D Station	20
Wilson Amada Style ABS Quick Release D Station	21
Wilson Amada Style ABS E Station	22
Wilson Amada Style ABS Quick Release E Station	23
Close to Clamps Tooling	24
DuraDie	25
Replacement Insert Assembly	27
Punch Shims, Die Shims & Slug Ejectors	28
Non Standard Keying	29
Shear Options	30
Notes	31

Technology for Increased Tool Life

Optima Coating

The New Standard in Tooling Performance!

Optima™ is a proprietary TiCN (titanium carbo-nitride) coating that was custom engineered at our in-house coating facilities. It features unique properties that significantly enhance tooling performance. This coating, which is available only to Wilson Tool customers, provides a level of surface hardness, wear resistance and lubricity never before associated with coated or uncoated punch press tooling.

Some of the many benefits that you will enjoy with our Optima™ coating include:

- Longer tool life
- Increased wear resistance
- More hits between sharpenings
- Reduced adhesion (galling)
- Reduced slug pulling
- Reduced corner breakdown
- Improved special tooling performance
- Lower overall tooling costs
- In-house coating facilities allow us to deliver faster and maintain total quality control

Punch Life

Nibbling 14ga. (1.9mm) 304 Stainless Steel

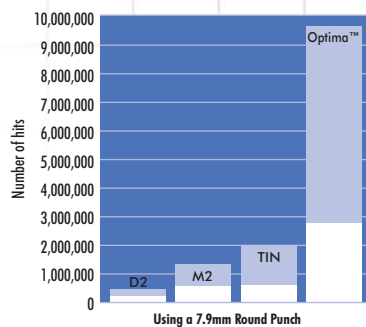

The white area indicates actual results achieved through three tool sharpenings of 0.25mm each. The complete graph indicates projected results with a total of 6mm removed for sharpening.

Material Adhesion

Square mm of Material Adhesion (Galling) on Punch Tips

Nibbling 12ga. (2.1mm) Aluminium

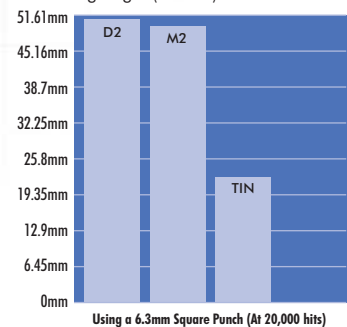

Number of Hits

Number of Hits Before First Sharpening

Nibbling 14ga. (1.9mm) 304 Stainless Steel

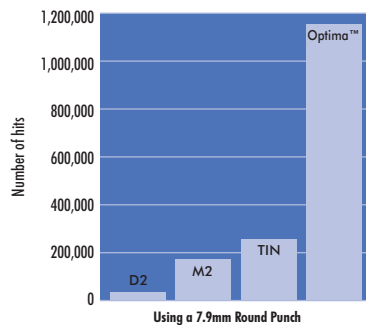

Tip Wear

Punch Tip Corner Wear

Nibbling 14ga. (1.9mm) 304 Stainless Steel

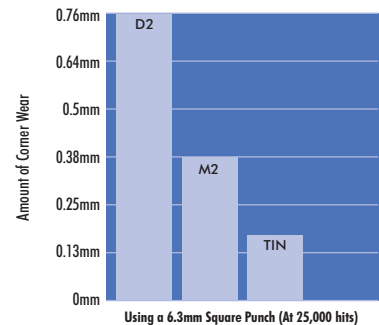

Optima

TECHNOLOGY AT THE CUTTING EDGE

Ultima Tool Steel

Boost Punching Productivity!

Tool Steel for Longer Life

When faced with demanding applications that require long-term wear resistance and toughness, turn to Wilson's new Ultima™ Premium Tool Steel for HP thick turret tooling. Ultima punches and dies are engineered to increase wear resistance by up to 100% over conventional tool steels.

A New Level of Performance

Ultima premium tool steel sets a new benchmark for durability and performance. Ultima punches and dies are designed to dramatically improve tool life when punching abrasive materials and materials with high tensile strength.

Ultima excels in applications in which punches and dies wear quickly and is ideal for long running tasks. The premium steel from which Ultima punches and dies are made significantly reduces micro chipping on the cutting edge. This micro chipping is most often where cutting edge failure begins.



Remarkable Downtime Reductions

With up to twice as long between re-grinds, Ultima premium steel significantly reduces downtime and tool replacement costs. Breaking, chipping, cracking, tool fatigue and other downtime problems are minimised, providing long term gains in productivity and profitability.

Ultima tools are especially useful for the toughest punch press applications, but are effective in any job. Viability can be determined by conducting a cost benefit analysis.

Maintenance and sharpening may differ from traditional tooling. Please check with your local Sales Engineer or the Salesdesk.

Ultima[™]
PREMIUM TOOL STEELS

Quick-Adjust A & B Stations

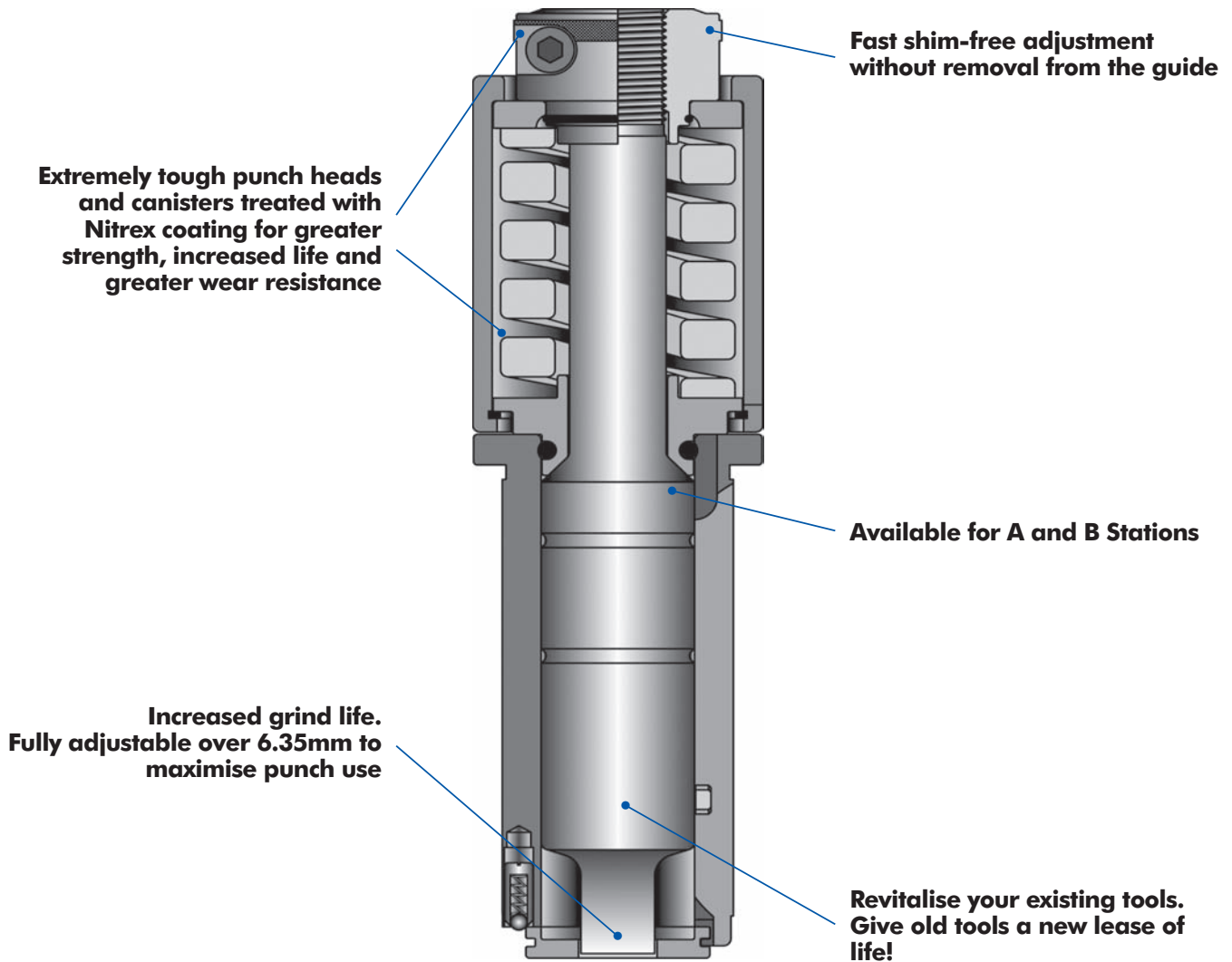

Features and Benefits of Wilson Replacement Amada Tooling

C, D & E Stations

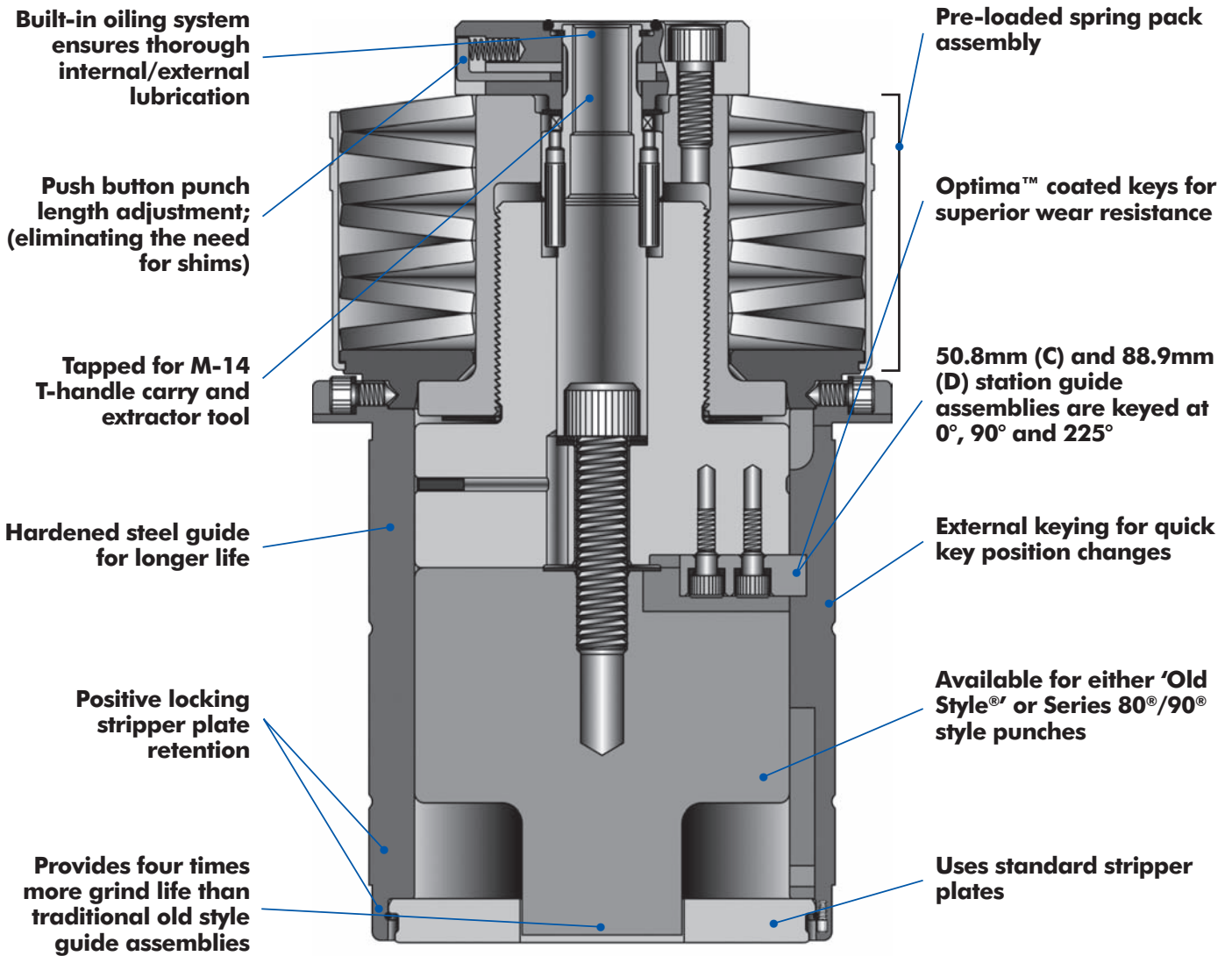

Wilson Amada Style Quick Adjust A Station

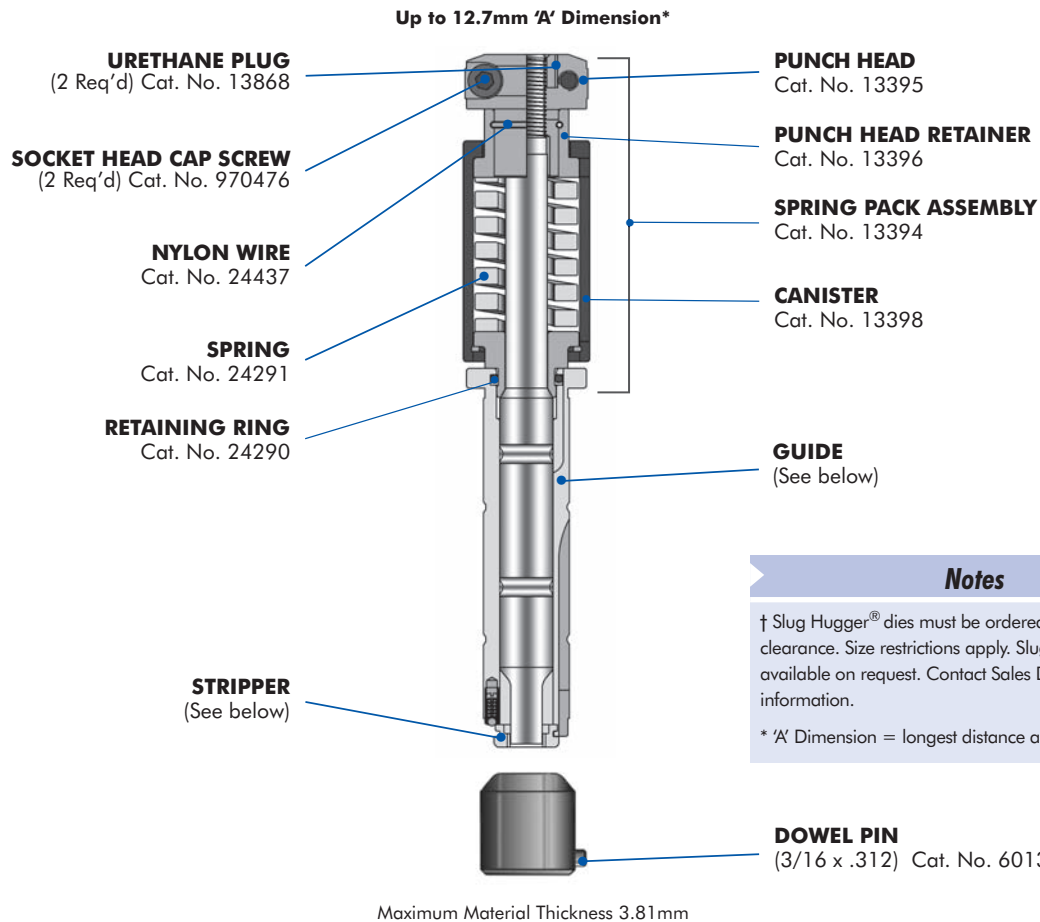

Notes

† Slug Hugger® dies must be ordered punch size plus clearance. Size restrictions apply. Slug Hugger 2 available on request. Contact Sales Desk for further information.

* 'A' Dimension = longest distance across shape.

Description		Cat. No.	Price
Punch & Guide Assembly	• Round	13425	
	• Shape Fitted	13427	
	• Optima® Add On	-	
Punches	• Round	2183	
	• Shape	2182	
	• Optima® Add On	-	
Guides	• Round	13065	
	• Shape (0°)	13066	
	• Shape (0° & 45°)	13067	
	• Shape (0° & 90°)	13068	
Stripper	• Round	13044	
	• Shape Fitted	13143	
Dies	• Round Slug Hugger®†	2192	
	• Round Standard	1808	
	• Shape Slug Hugger®†	2193	
	• Shape Standard	13801	
	• Ultima™ Add On (Round)	-	
	• Ultima™ Add On (Shape)	-	

12.7mm (A) Station Add Ons			
Add ons for Rounds			
Small Diameter	Punch	Die	Stripper
0.79 - 1.50mm			N/C
Clearance < 0.10mm			N/C
Add ons for Shapes			
Small Widths	Punch	Die	Stripper
0.79 - 1.0mm			N/C
Clearance < 0.10mm			N/C

Add to round or shape punch for extra straight before radius, extra back taper, or no back taper.

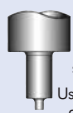
Stubby Style (A) Station Add Ons		
	Punch	Die
 Note: Must use stubby style die and guide with stubby style punch Use Standard Punch and Die Price Plus:	Round (2.3mm max dia.) add	Round add
	Shape add	Shape add

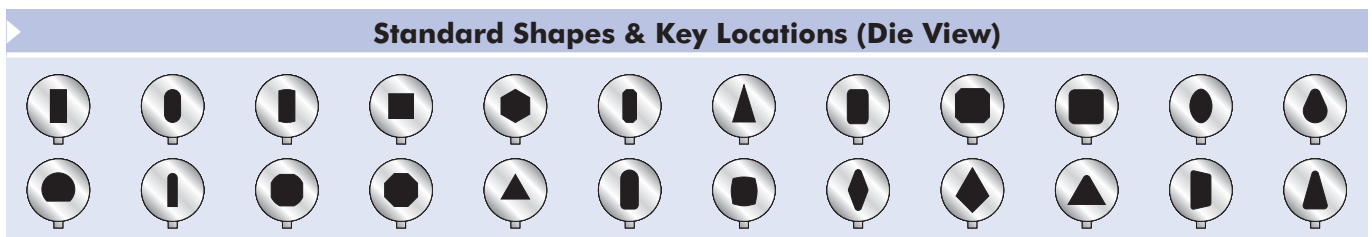

Wilson Amada Style A Station

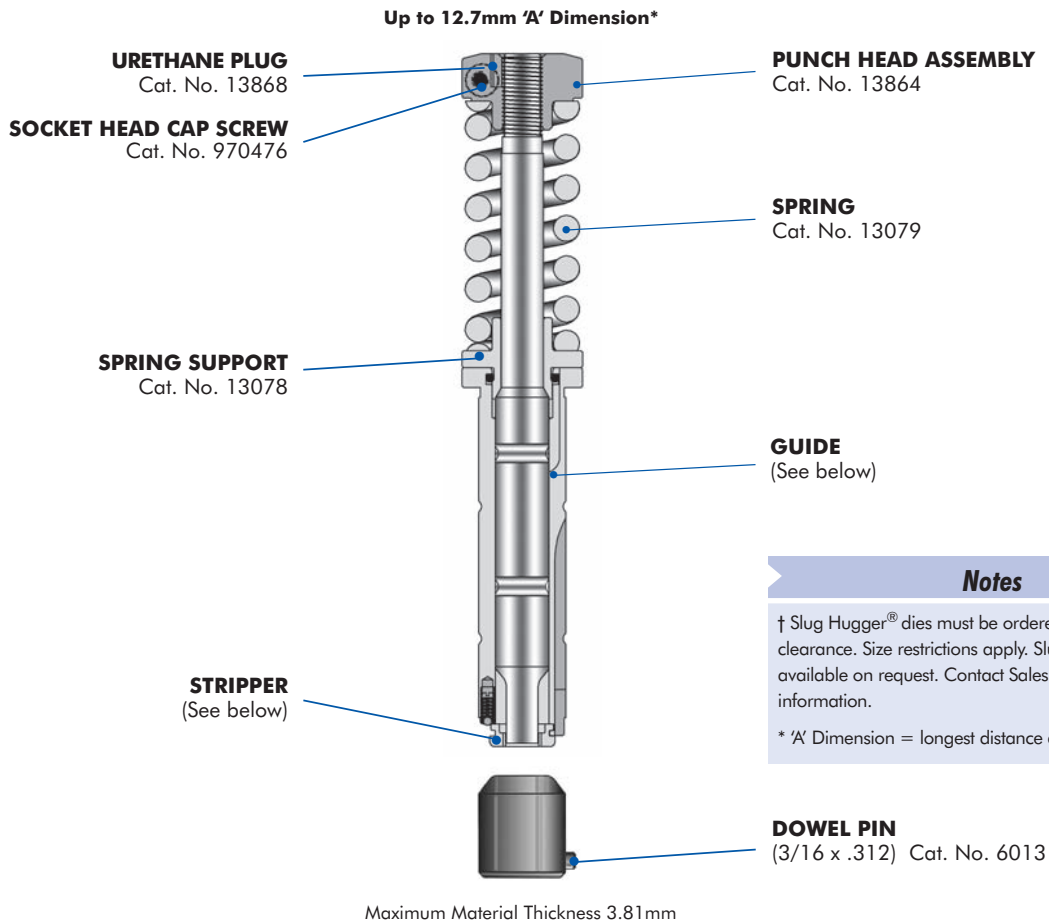

Notes

† Slug Hugger® dies must be ordered punch size plus clearance. Size restrictions apply. Slug Hugger 2 available on request. Contact Sales Desk for further information.

* 'A' Dimension = longest distance across shape.

Description		Cat. No.	Price
Punch & Guide Assembly	• Round	13057	
	• Shape Fitted	13059	
	• Optima® Add On	–	
Punches	• Round	2183	
	• Shape	2182	
	• Optima® Add On	–	
Guides	• Round	13065	
	• Shape (0°)	13066	
	• Shape (0° & 45°)	13067	
	• Shape (0° & 90°)	13068	
Stripper	• Round	13044	
	• Shape Fitted	13143	
Dies	• Round Slug Hugger®†	2192	
	• Round Standard	1808	
	• Shape Slug Hugger®†	2193	
	• Shape Standard	13801	
	• Ultima™ Add On (Round)	-	
• Ultima™ Add On (Shape)	-		

12.7mm (A) Station Add Ons			
Add ons for Rounds			
Small Diameter 0.79 - 1.50mm Clearance < 0.10mm	Punch	Die	Stripper N/C N/C
Add ons for Shapes			
Small Widths 0.79 - 1.0mm Clearance < 0.10mm	Punch	Die	Stripper N/C
Add † to round or shape punch for extra straight before radius, extra back taper, or no back taper.			

Stubby Style (A) Station Add Ons		
 <p>Note: Must use stubby style die and guide with stubby style punch Use Standard Punch and Die Price Plus:</p>	Punch	Die
	Round (2.3mm max dia.) add Shape add	Round add Shape add

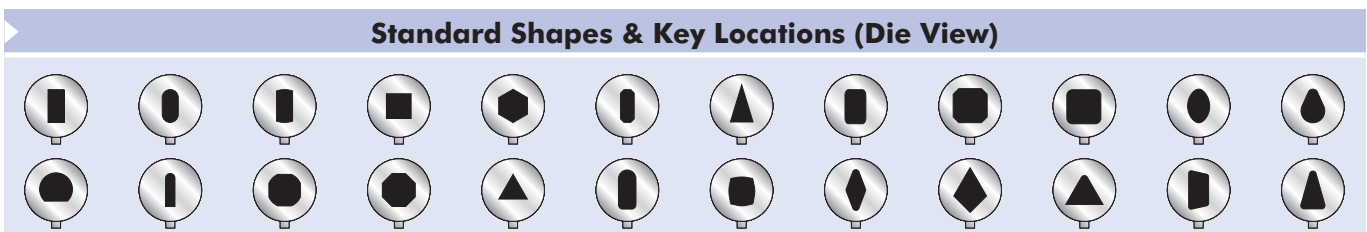

Wilson Amada Style Quick Adjust B Station

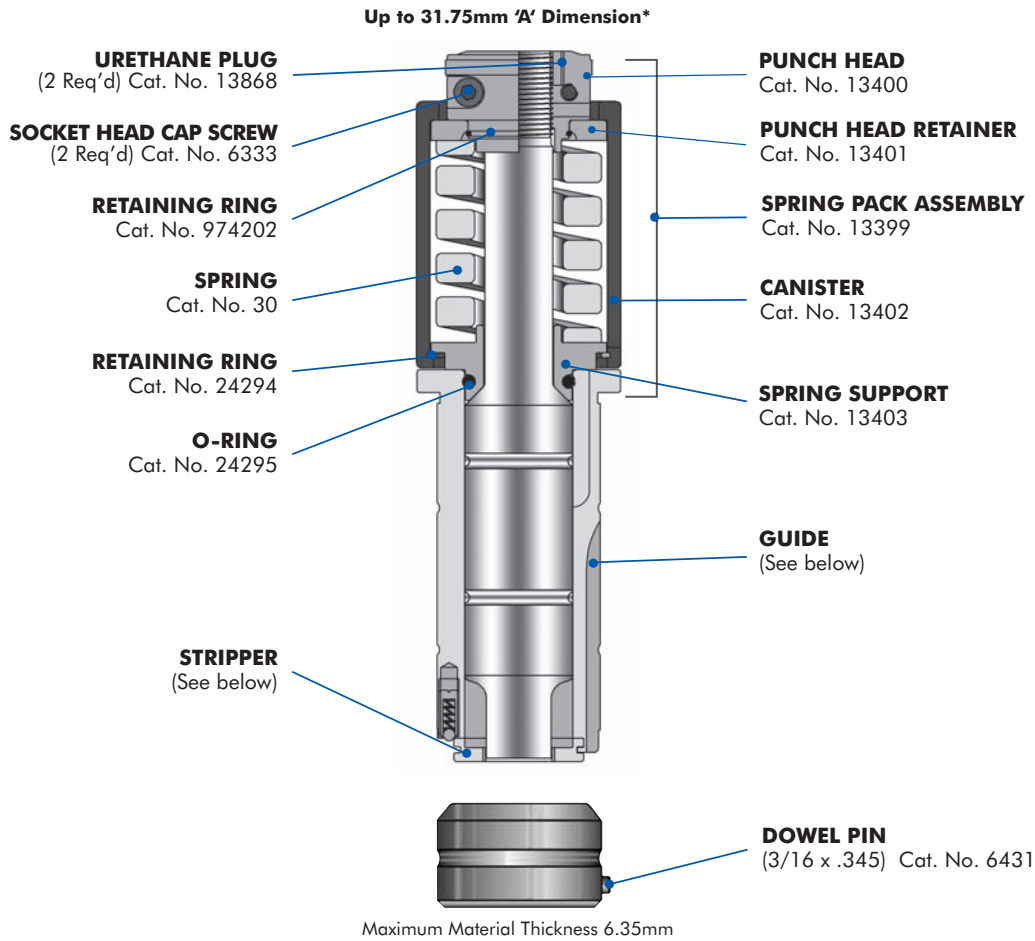

Description		Cat. No.	Price
Punch & Guide Assembly	• Round	13431	
	• Shape Fitted	13433	
	• Optima® Add On	-	
Punches	• Round	2185	
	• Shape	2184	
	• Optima® Add On	-	
Guides	• Round	13413	
	• Shape (0°)	13414	
	• Shape (0° & 45°)	13415	
	• Shape (0° & 90°)	13416	
Stripper	• Round	1890	
	• Shape Fitted	1917	
Dies	• Round Slug Hugger®†	2194	
	• Round Standard	2021	
	• Shape Slug Hugger®†	2195	
	• Shape Standard	13804	
	• Shape (0° & 45°) Positive	2263	
	• Shape (0° & 45°) Negative	2264	
	• Ultima™ Add On (Round)	-	
	• Ultima™ Add On (Shape)	-	

(B) Station Add Ons			
Add ons for Rounds			
Small Diameter 0.79 - 1.50mm Clearance < 0.10mm	Punch	Die	Stripper N/C N/C
Add ons for Shapes			
Small Widths 0.79 - 1.0mm 'A' Dimension* < 11.10mm Clearance < 0.10mm	Punch N/C	Die N/C	Stripper N/C N/C
Add to round or shape punch for extra straight before radius, extra back taper, or no back taper.			

Notes

† Slug Hugger® dies must be ordered punch size plus clearance. Size restrictions apply. Slug Hugger 2 available on request. Contact Sales Desk for further information.

* 'A' Dimension = longest distance across shape.

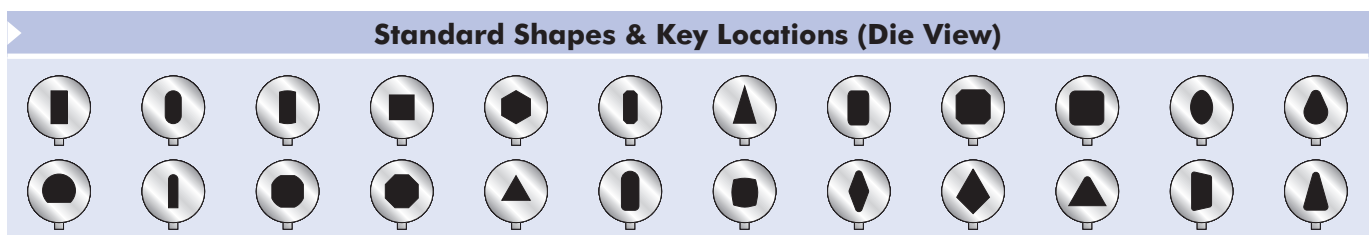

Wilson Amada Style B Station

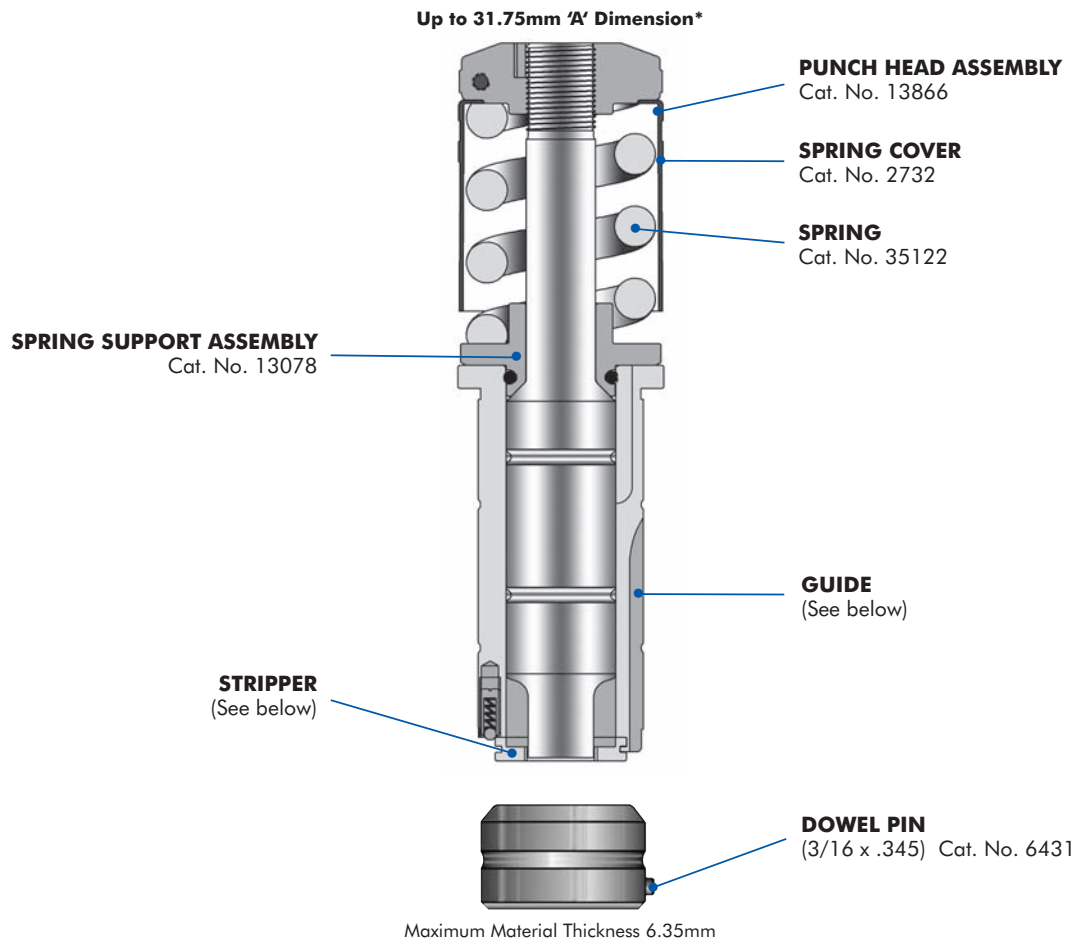

Description	Cat. No.	Price
Punch & Guide Assembly	• Round	13090
	• Shape Fitted	13092
	• Optima® Add On	—
Punches	• Round	2185
	• Shape	2184
	• Optima® Add On	—
Guides	• Round	13413
	• Shape (0°)	13414
	• Shape (0° & 45°)	13415
	• Shape (0° & 90°)	13416
Stripper	• Round	1890
	• Shape Fitted	1917
Dies	• Round Slug Hugger®†	2194
	• Round Standard®†	2021
	• Shape Slug Hugger	2195
	• Shape Standard	13804
	• Shape (0° & 45°) Positive	2263
	• Shape (0° & 45°) Negative	2264
	• Ultima™ Add On (Round)	—
	• Ultima™ Add On (Shape)	—

(B) Station Add Ons			
Add ons for Rounds			
Small Diameter 0.79 - 1.50mm Clearance < 0.10mm	Punch	Die	Stripper
			N/C N/C
Add ons for Shapes			
Small Widths 0.79 - 1.0mm 'A' Dimension* < 11.10mm Clearance < 0.10mm	Punch	Die	Stripper
	N/C	N/C	N/C N/C
Add to round or shape punch for extra straight before radius, extra back taper, or no back taper.			

Notes
† Slug Hugger® dies must be ordered punch size plus clearance. Size restrictions apply. Slug Hugger 2 available on request. Contact Sales Desk for further information.
* 'A' Dimension = longest distance across shape.

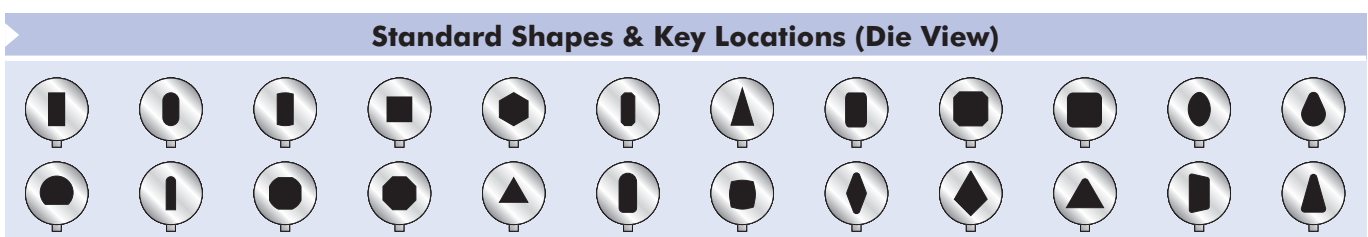

Wilson Amada Style C Station

STRIPPER RETAINED WITH WIRE LOCK RING OR STRIPPER CLIPS

Up to 50.8mm 'A' Dimension*

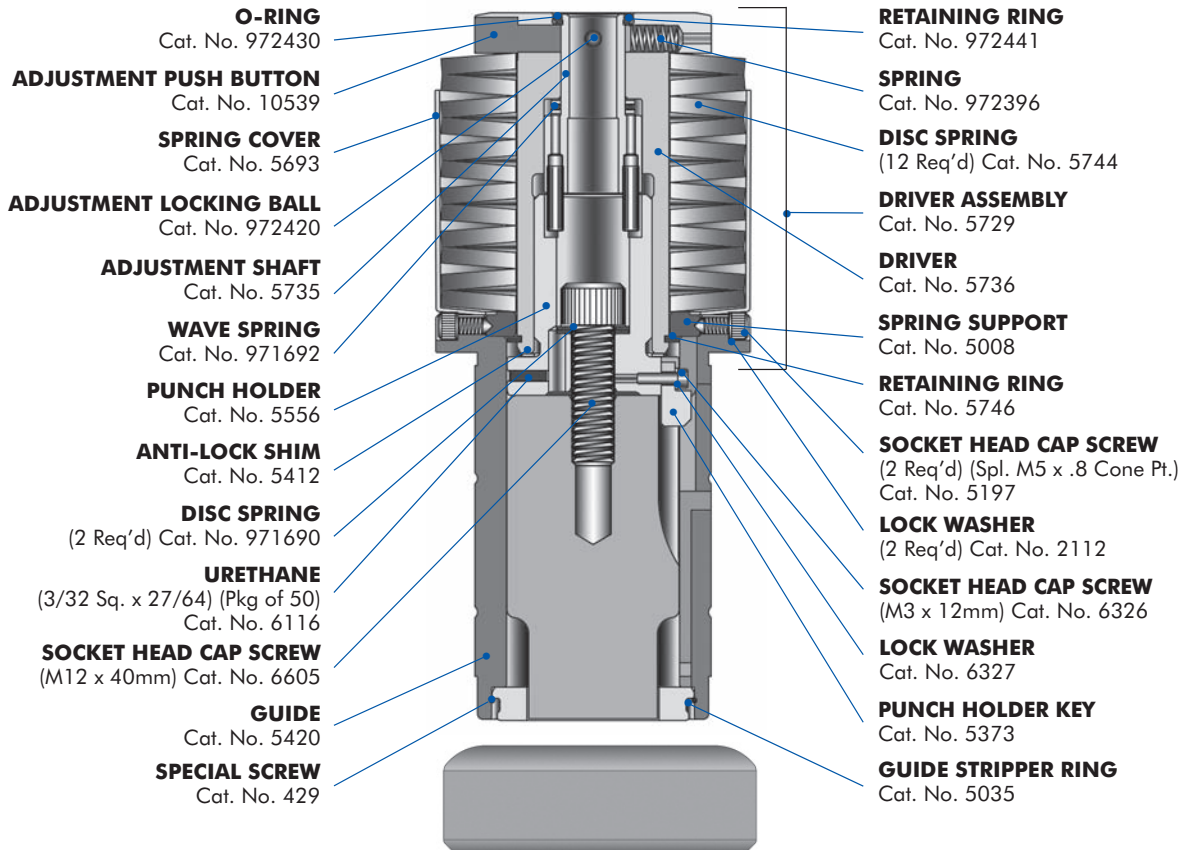

Maximum Material Thickness 6.35mm

Description		Cat. No.	Price
Guide Assembly	• Standard	5583	
	• Standard (LVD)	35191	
	• Standard WLS®	5592	
	• Standard WLS® (LVD)	35193	
Punches	• Round	1933	
	• Shape	1934	
	• Optima® Add On	—	
Strippers	• Round	1848	
	• Shape	1854	
Dies	• Round Slug Hugger®†	2196	
	• Round Standard	1850	
	• Shape Slug Hugger®†	2197	
	• Shape Standard	13807	
	• Ultima™ Add On (Round)	—	
	• Ultima™ Add On (Shape)	—	

50.8mm (C) Station Add Ons			
Add ons for Rounds			
Small Diameter < 25.4mm Clearance < 0.10mm	Punch	Die N/C	Stripper N/C N/C
Add ons for Shapes			
Small Widths 0.79 - 1.0mm 1.01 - 2.34mm Small 'A' Dimension* < 29.21mm 29.22 - 31.72 Clearance < 0.10mm	Punch N/C	Die N/C N/C N/C	Stripper N/C N/C N/C N/C
Add to round or shape punch for extra straight before radius, extra back taper, or no back taper.			

Notes
Standard guide assys. are keyed for shapes at 0°, 90° and 225°.
All punches will be shipped with no shear unless specified.
†Slug Hugger® dies must be ordered punch size plus clearance. Size restrictions apply. Slug Hugger 2 available on request. Contact Sales Desk for further information.
* 'A' Dimension = longest distance across shape.

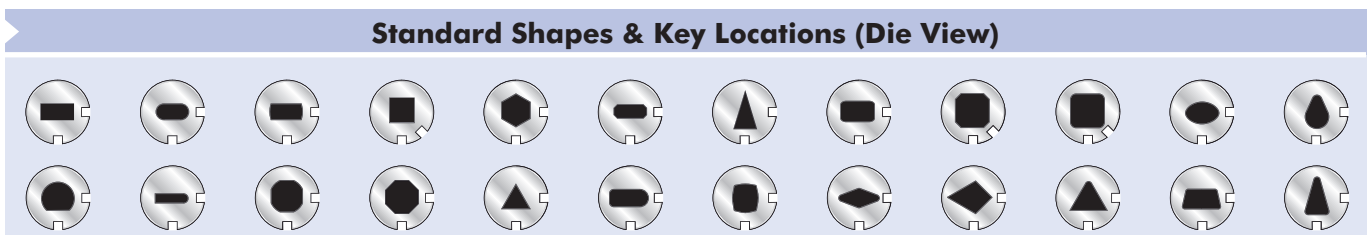

Wilson Amada Style D Station

STRIPPER RETAINED WITH WIRE LOCK RING OR STRIPPER CLIPS

Up to 88.9mm 'A' Dimension*

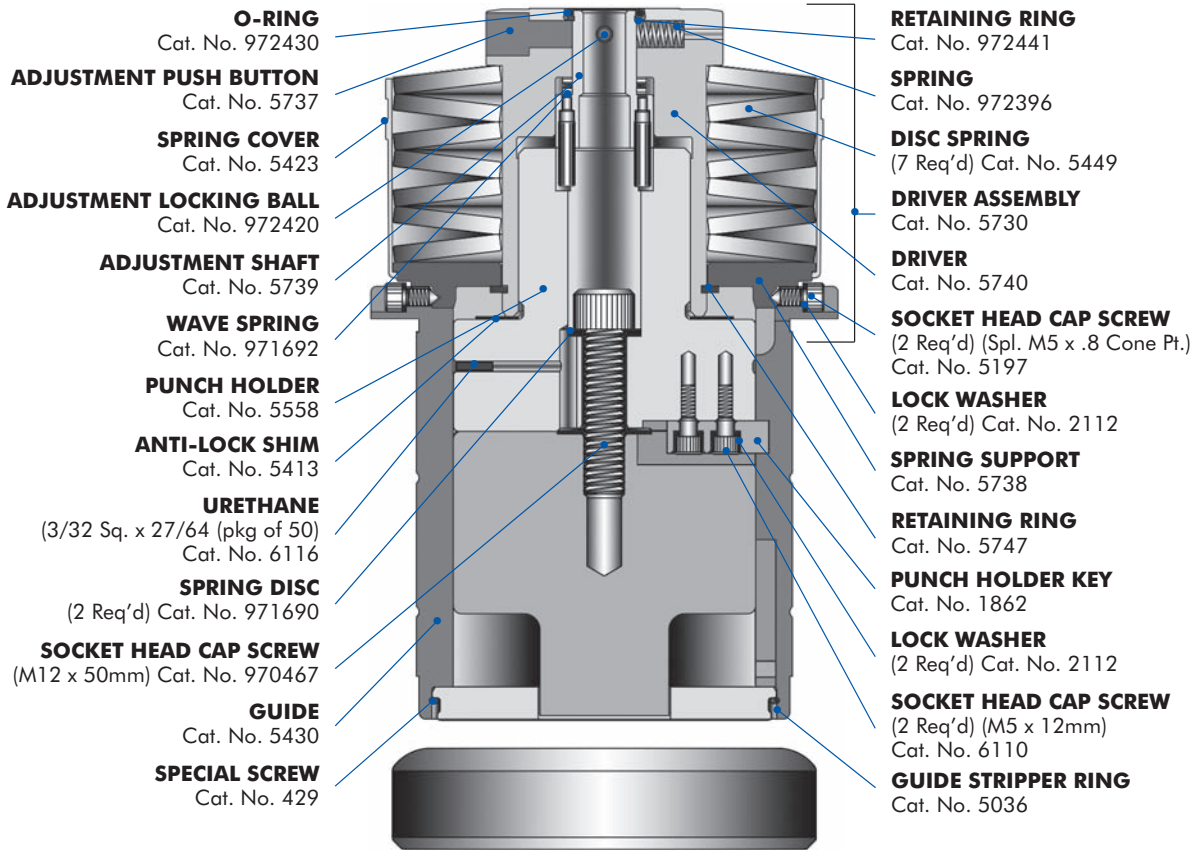

Maximum Material Thickness 6.35mm

Description		Cat. No.	Price
Guide Assembly	• Standard	5584	
	• Standard (LVD)	35198	
	• Standard WLS®	5593	
	• Standard WLS® (LVD)	35200	
Punches	• Round	1937	
	• Shape	1938	
	• Optima® Add On	—	
Strippers	• Round	1864	
	• Shape	1869	
Dies	• Round Slug Hugger®†	2198	
	• Round Standard	1865	
	• Shape Slug Hugger®†	2199	
	• Shape Standard	13810	
	• Ultima™ Add On (Round)	—	
	• Ultima™ Add On (Shape)	—	

88.9mm (D) Station Add Ons			
Add ons for Rounds			
Small Diameter	Punch	Die	Stripper
48.26mm 48.27 - 50.77mm Clearance < 0.10mm		N/C N/C	N/C N/C N/C
Add ons for Shapes			
Small Widths	Punch	Die	Stripper
0.79 - 1.0mm 1.01 - 2.34mm Small 'A' Dimension* < 48.26mm 48.27 - 50.77mm Clearance < 0.10mm	N/C	N/C N/C N/C	N/C N/C N/C N/C
Add to round or shape punch for extra straight before radius, extra back taper, or no back taper.			

Notes	
Standard guide assys. are keyed for shapes at 0°, 90° & 225°.	† Slug Hugger® dies must be ordered punch size plus clearance. Size restrictions apply. Slug Hugger 2 available on request. Contact Sales Desk for further information.
1.6mm Rooftop shear is given to all punches with 'A' dimension greater than 50.8mm, and width greater than 6.35mm, at no extra charge.	* 'A' Dimension = longest distance across shape.
All punches 6.35mm and under in width will be shipped with no shear unless specified.	

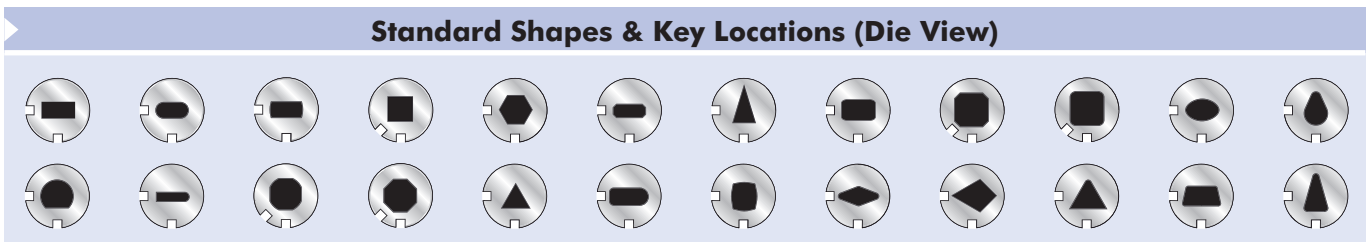

Wilson Amada Style E Station

STRIPPER RETAINED WITH WIRE LOCK RING OR STRIPPER CLIPS

Up to 114.3mm 'A' Dimension*

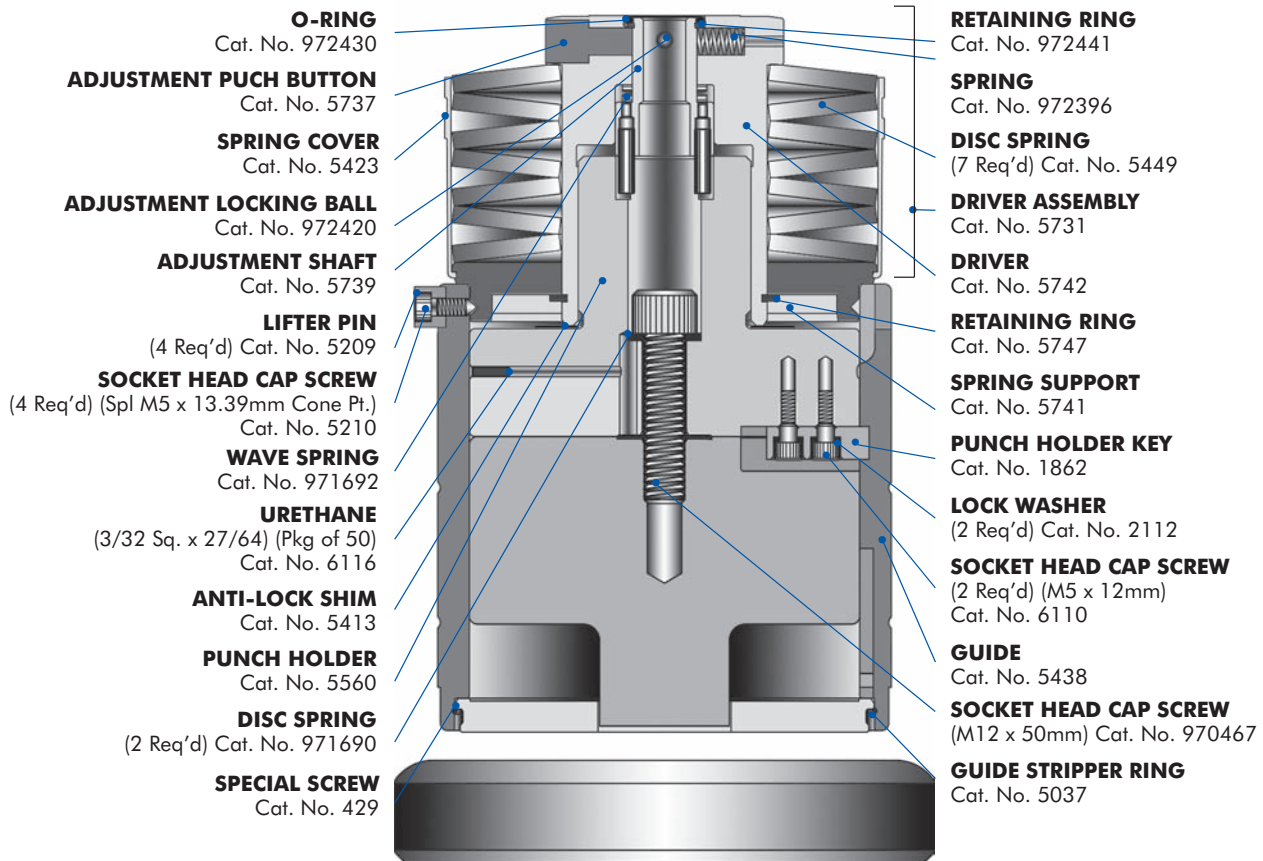

Maximum Material Thickness 6.35mm

Description		Cat. No.	Price
Guide Assembly	• Standard	5585	
	• Standard WLS®	5594	
Punches	• Round	1941	
	• Shape	1942	
	• Optima® Add On	—	
Strippers	• Round	1877	
	• Shape	1882	
Dies	• Round Slug Hugger®†	2200	
	• Round Standard	1878	
	• Shape Slug Hugger®†	2201	
	• Shape Standard	13817	
	• Ultima™ Add On (Round)	—	
	• Ultima™ Add On (Shape)	—	

114.3mm (E) Station Add Ons			
Add ons for Rounds			
Small Diameter < 86.36mm 86.37 - 88.87mm Clearance < 0.10mm	Punch	Die N/C N/C	Stripper N/C N/C N/C
Add ons for Shapes			
Small Widths 0.79 - 1.0mm 1.01 - 2.34mm Small 'A' Dimension* < 86.36mm 86.37 - 88.87mm Clearance < 0.10mm	Punch N/C	Die N/C N/C N/C	Stripper N/C N/C N/C
Add to round or shape punch for extra straight before radius, extra back taper, or no back taper.			

Notes
Standard guide assys. are keyed for shapes at 0° & 90°.
1.6mm Rooftop shear is given to all punches with 'A' dimension greater than 50.8mm, and width greater than 6.35mm, at no extra charge.
All punches 6.35mm and under in width will be shipped with no shear unless specified.
† Slug Hugger® dies must be ordered punch size plus clearance. Size restrictions apply. Slug Hugger 2 available on request. Contact Sales Desk for further information.
* 'A' Dimension = longest distance across shape.

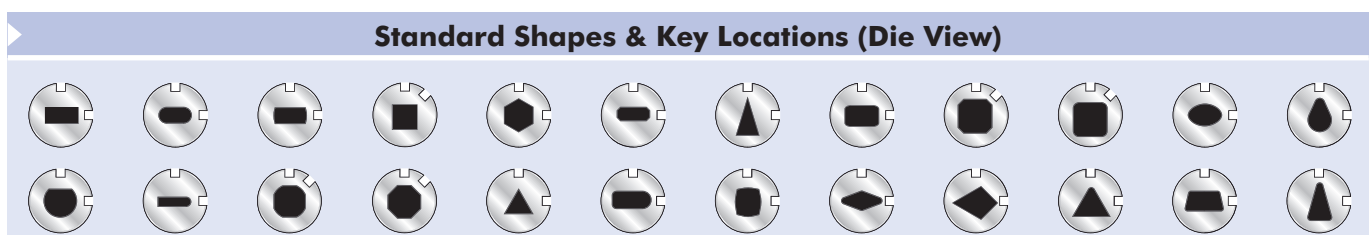

Wilson Amada® Style ABS Punches, Bolt-on Strippers and Punch Assemblies now available from Wilson Tool.



Punches, guides and strippers are fully compatible and interchangeable with Amada® original ABS tooling.

Description		Cat. No.	Price
Bolt-on Strippers	C Station		
	• Round	13629	
	• Shape	13630	
	D Station		
	• Round	13631	
	• Shape	13632	
E Station			
• Round	13633		
• Shape	13634		

Bolt-on strippers are available for Amada® manufactured holders only.

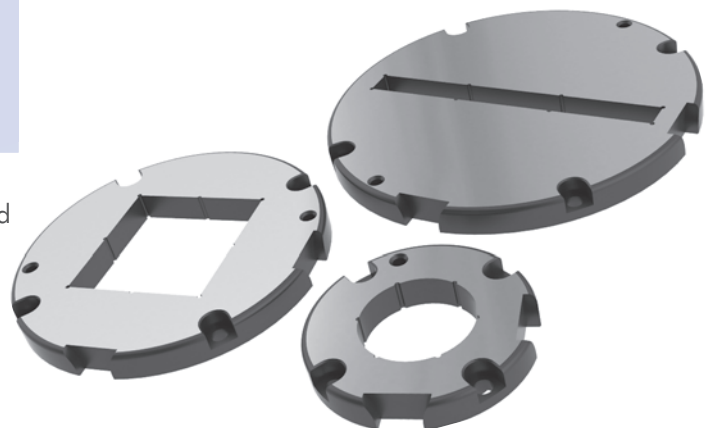

Wilson Amada Style ABS Quick Adjust A Station

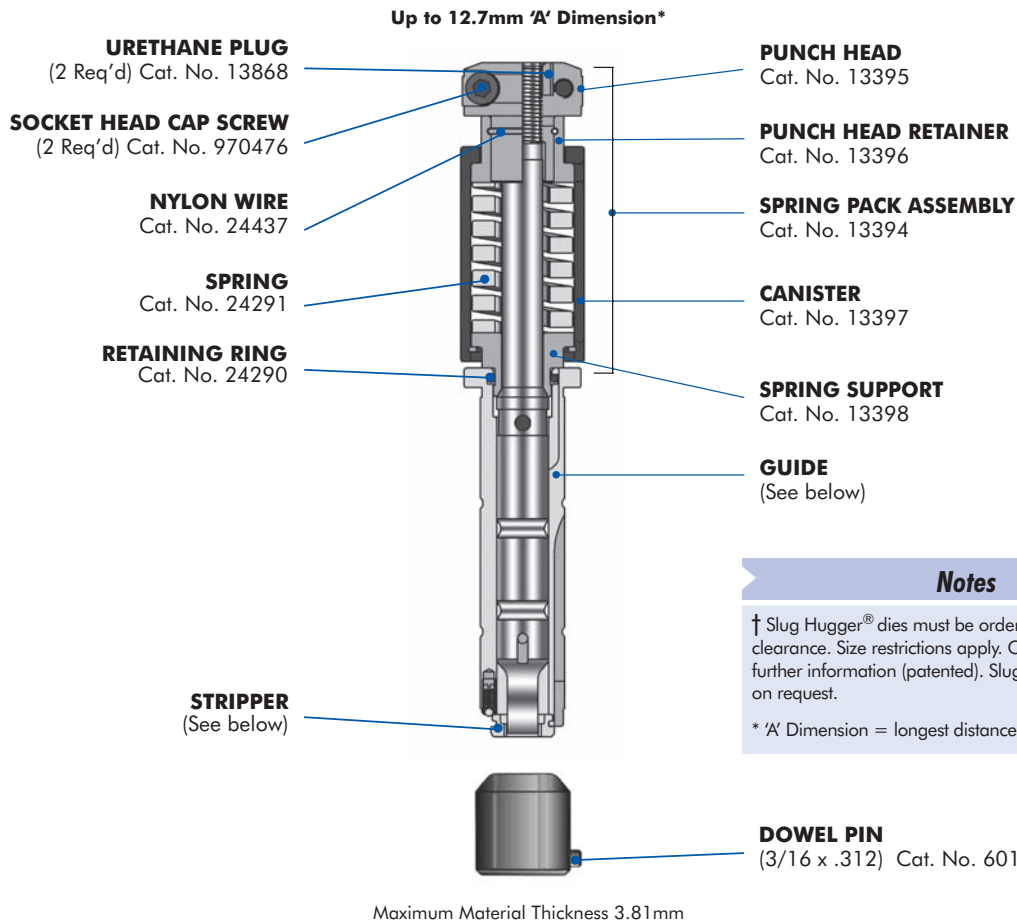

Notes

† Slug Hugger® dies must be ordered punch size plus clearance. Size restrictions apply. Contact Sales Desk for further information (patented). Slug Hugger 2 available on request.

* 'A' Dimension = longest distance across shape.

Maximum Material Thickness 3.81mm

Description		Cat. No.	Price
Punch & Guide Assembly	• Round	13823	
	• Shape Fitted	13824	
	• Optima® Add On	-	
Punches	• Round	13827	
	• Shape	13870	
	• Optima® Add On	-	
Guides	• Round	13073	
	• Shape (0°)	13074	
	• Shape (0° & 45°)	13075	
	• Shape (0° & 90°)	13076	
Stripper	• Round	13045	
	• Shape Fitted	13152	
Dies	• Round Slug Hugger®†	2192	
	• Round Standard	1808	
	• Shape Slug Hugger®†	2193	
	• Shape Standard	13801	
	• Ultima™ Add On (Round)	-	
	• Ultima™ Add On (Shape)	-	

12.7mm (A) Station Add Ons

Add ons for Rounds

Small Diameter	Punch	Die	Stripper
0.79 - 1.50mm			N/C
Clearance < 0.10mm			N/C

Add ons for Shapes

Small Widths	Punch	Die	Stripper
0.79 - 1.0mm			N/C
Clearance < 0.10mm			N/C

Add to round or shape punch for extra straight before radius, extra back taper, or no back taper.

Stubby Style (A) Station Add Ons



Note: Must use stubby style die and guide with stubby style punch
Use Standard Punch and Die Price Plus:

Punch	Die
Round (2.3mm max dia.) add	Round add
Shape add	Shape add

Standard Shapes & Key Locations (Die View)

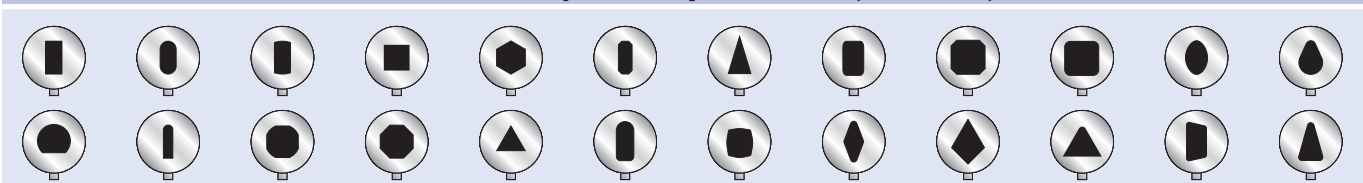

Wilson Amada Style ABS A Station

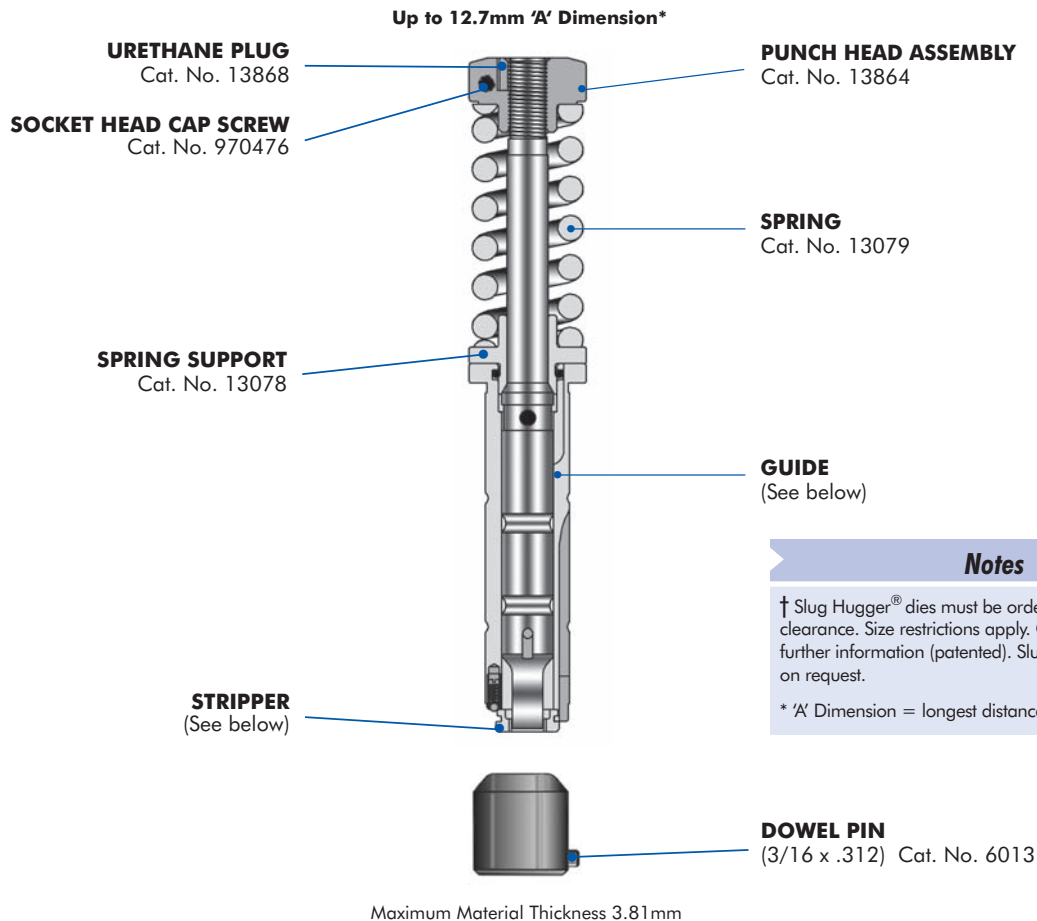

Notes

† Slug Hugger® dies must be ordered punch size plus clearance. Size restrictions apply. Contact Sales Desk for further information (patented). Slug Hugger 2 available on request.

* 'A' Dimension = longest distance across shape.

Description		Cat. No.	Price
Punch & Guide Assembly	• Round	13856	
	• Shape Fitted	13858	
	• Optima® Add On	-	
Punches	• Round	13827	
	• Shape	13870	
	• Optima® Add On	-	
Guides	• Round	13073	
	• Shape (0°)	13074	
	• Shape (0° & 45°)	13075	
	• Shape (0° & 90°)	13076	
Stripper	• Round	13045	
	• Shape Fitted	13152	
Dies	• Round Slug Hugger®†	2192	
	• Round Standard	1808	
	• Shape Slug Hugger®†	2193	
	• Shape Standard	13801	
	• Ultima™ Add On (Round)	-	
	• Ultima™ Add On (Shape)	-	

12.7mm (A) Station Add Ons			
Add ons for Rounds			
Small Diameter	Punch	Die	Stripper
0.79 - 1.50mm			N/C
Clearance < 0.10mm			N/C
Add ons for Shapes			
Small Widths	Punch	Die	Stripper
0.79 - 1.0mm			N/C
Clearance < 0.10mm			N/C

Add to round or shape punch for extra straight before radius, extra back taper, or no back taper.

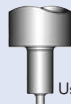
Stubby Style (A) Station Add Ons		
	Punch	Die
 Note: Must use stubby style die and guide with stubby style punch. Use Standard Punch and Die Price Plus.	Round (2.3mm max dia.) add	Round add
	Shape add	Shape add

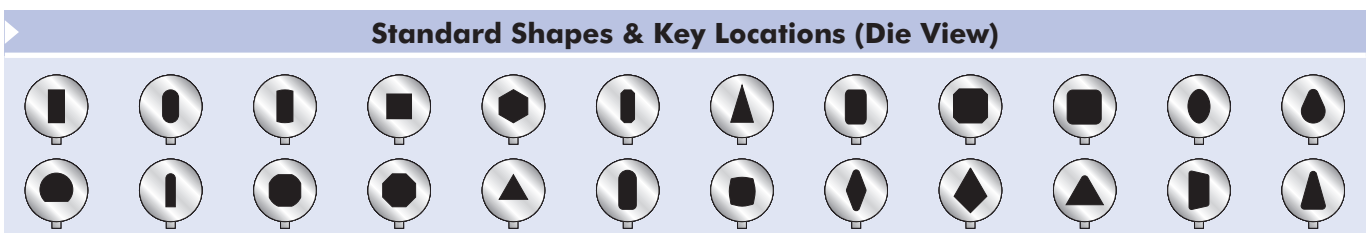

Wilson Amada Style ABS Quick Adjust B Station

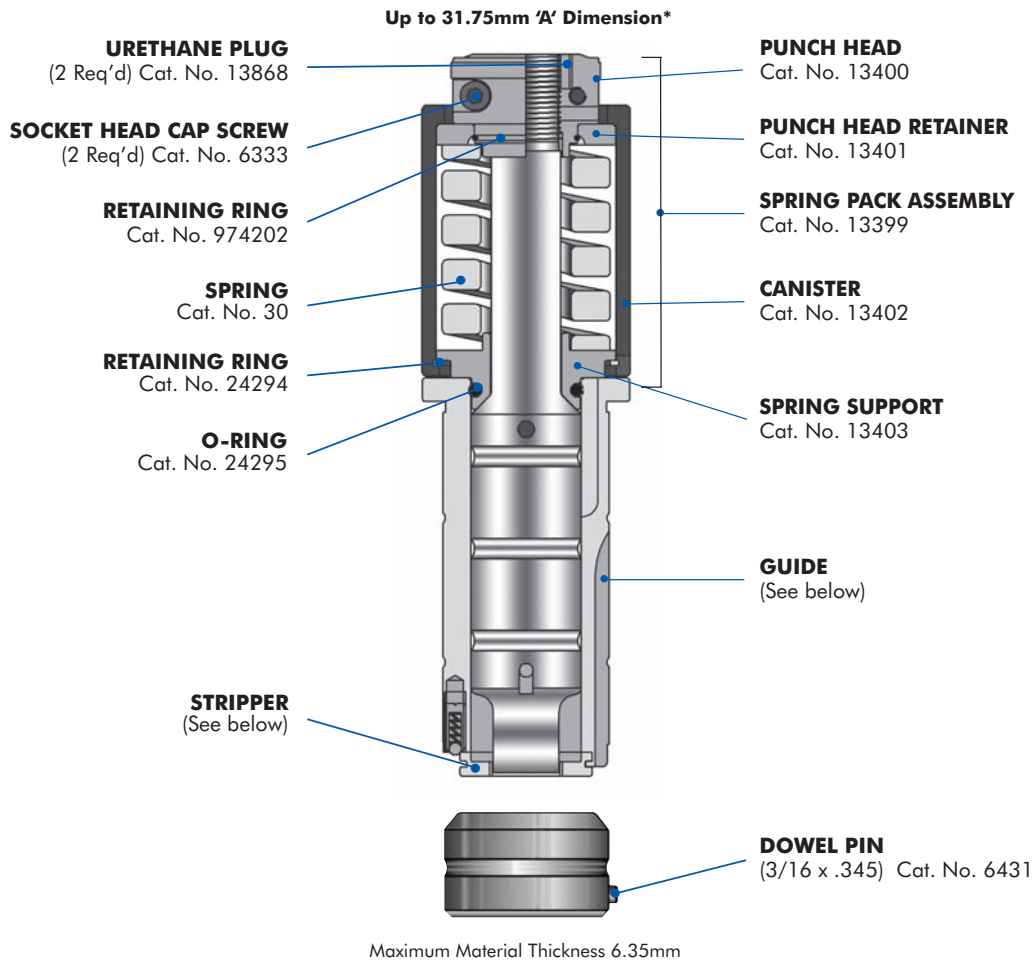

Description	Cat. No.	Price
Punch & Guide Assembly	• Round	13825
	• Shape Fitted	13826
	• Optima® Add On	-
Punches	• Round	13828
	• Shape	13872
	• Optima® Add On	-
Guides	• Round	13097
	• Shape (0°)	13098
	• Shape (0° & 45°)	13099
	• Shape (0° & 90°)	13100
Stripper	• Round	2433
	• Shape Fitted	2432
Dies	• Round Slug Hugger®†	2194
	• Round Standard	2021
	• Shape Slug Hugger®†	2195
	• Shape Standard	13804
	• Ultima™ Add On (Round)	-
	• Ultima™ Add On (Shape)	-

(B) Station Add Ons			
Add ons for Rounds			
Small Diameter 0.79 - 1.50mm Clearance < 0.10mm	Punch	Die	Stripper N/C N/C
Add ons for Shapes			
Small Widths 0.79 - 1.0mm 'A' Dimension* < 11.10mm Clearance < 0.10mm	Punch N/C	Die N/C	Stripper N/C N/C
Add to round or shape punch for extra straight before radius, extra back taper, or no back taper.			

Notes

† Slug Hugger® dies must be ordered punch size plus clearance. Size restrictions apply. Slug Hugger 2 available on request. Contact Sales Desk for further information.

* 'A' Dimension = longest distance across shape.

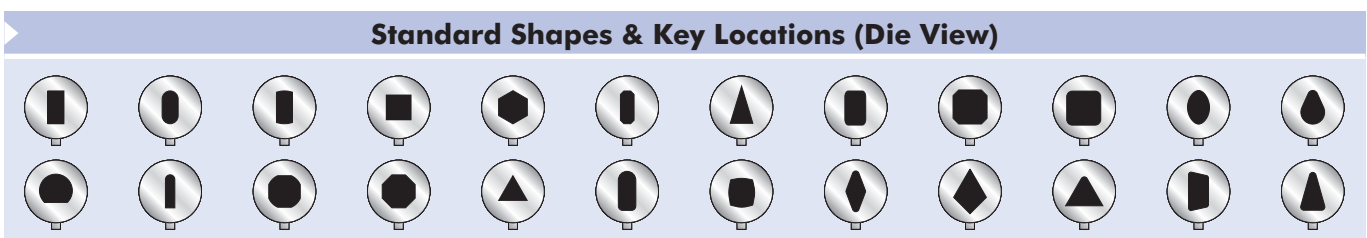

Wilson Amada Style ABS B Station

Up to 31.75mm 'A' Dimension*

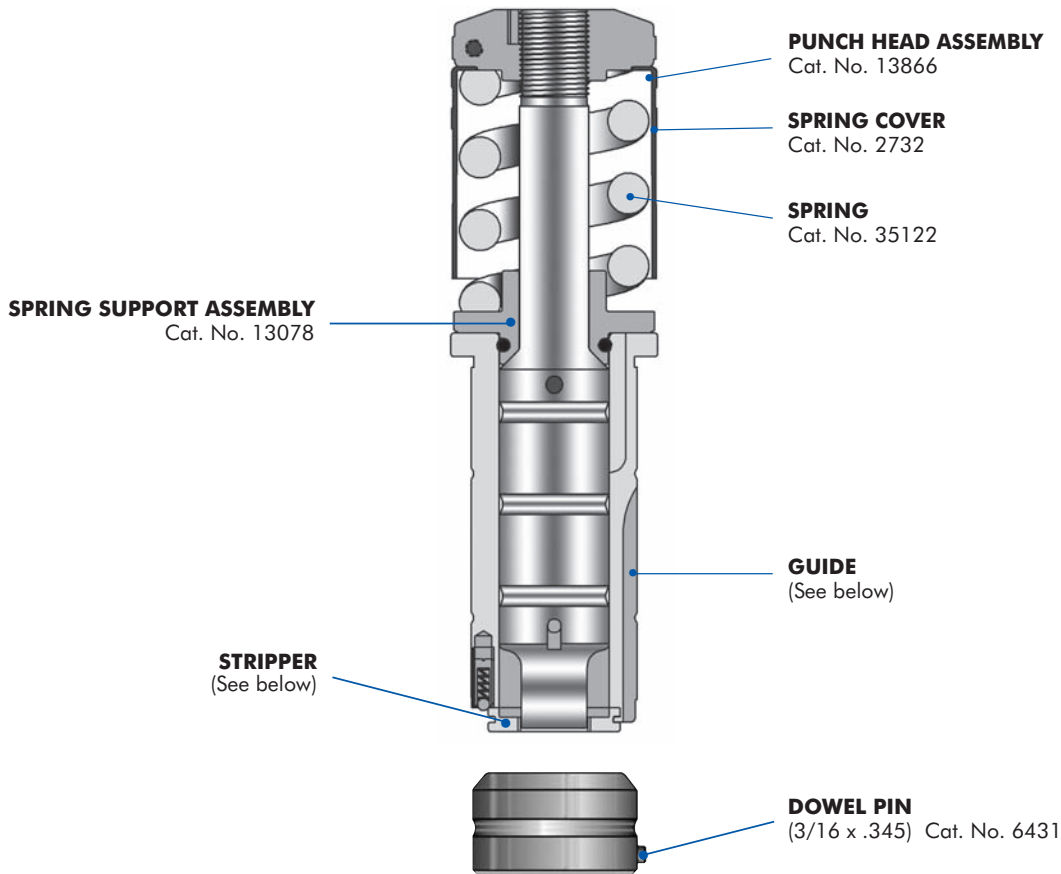

Maximum Material Thickness 6.35mm

Description		Cat. No.	Price
Punch & Guide Assembly	• Round	13860	
	• Shape Fitted	13862	
	• Optima® Add On	-	
Punches	• Round	13828	
	• Shape	13872	
	• Optima® Add On	-	
Guides	• Round	13097	
	• Shape (0°)	13098	
	• Shape (0° & 45°)	13099	
	• Shape (0° & 90°)	13100	
Stripper	• Round	2433	
	• Shape Fitted	2432	
Dies	• Round Slug Hugger®†	2194	
	• Round Standard	2021	
	• Shape Slug Hugger®†	2195	
	• Shape Standard	13804	
	• Ultima™ Add On (Round)	-	
	• Ultima™ Add On (Shape)	-	

(B) Station Add Ons			
Add ons for Rounds			
Small Diameter 0.79 - 1.50mm Clearance < 0.10mm	Punch	Die	Stripper
			N/C N/C
Add ons for Shapes			
Small Widths 0.79 - 1.0mm 'A' Dimension* < 11.10mm Clearance < 0.10mm	Punch	Die	Stripper
		N/C	N/C N/C
Add † to round or shape punch for extra straight before radius, extra back taper, or no back taper.			

Notes

† Slug Hugger® dies must be ordered punch size plus clearance. Size restrictions apply. Slug Hugger 2 available on request. Contact Sales Desk for further information.

* 'A' Dimension = longest distance across shape.

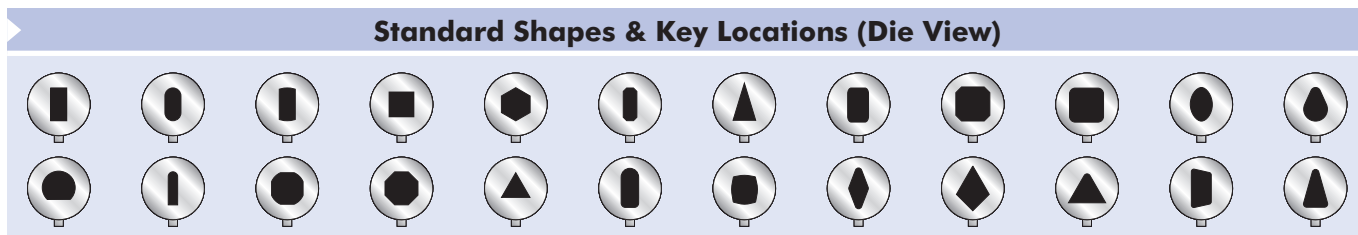

Wilson Amada Style ABS C Station

STRIPPER RETAINED WITH STRIPPER CLIPS Up to 50.8mm 'A' Dimension*

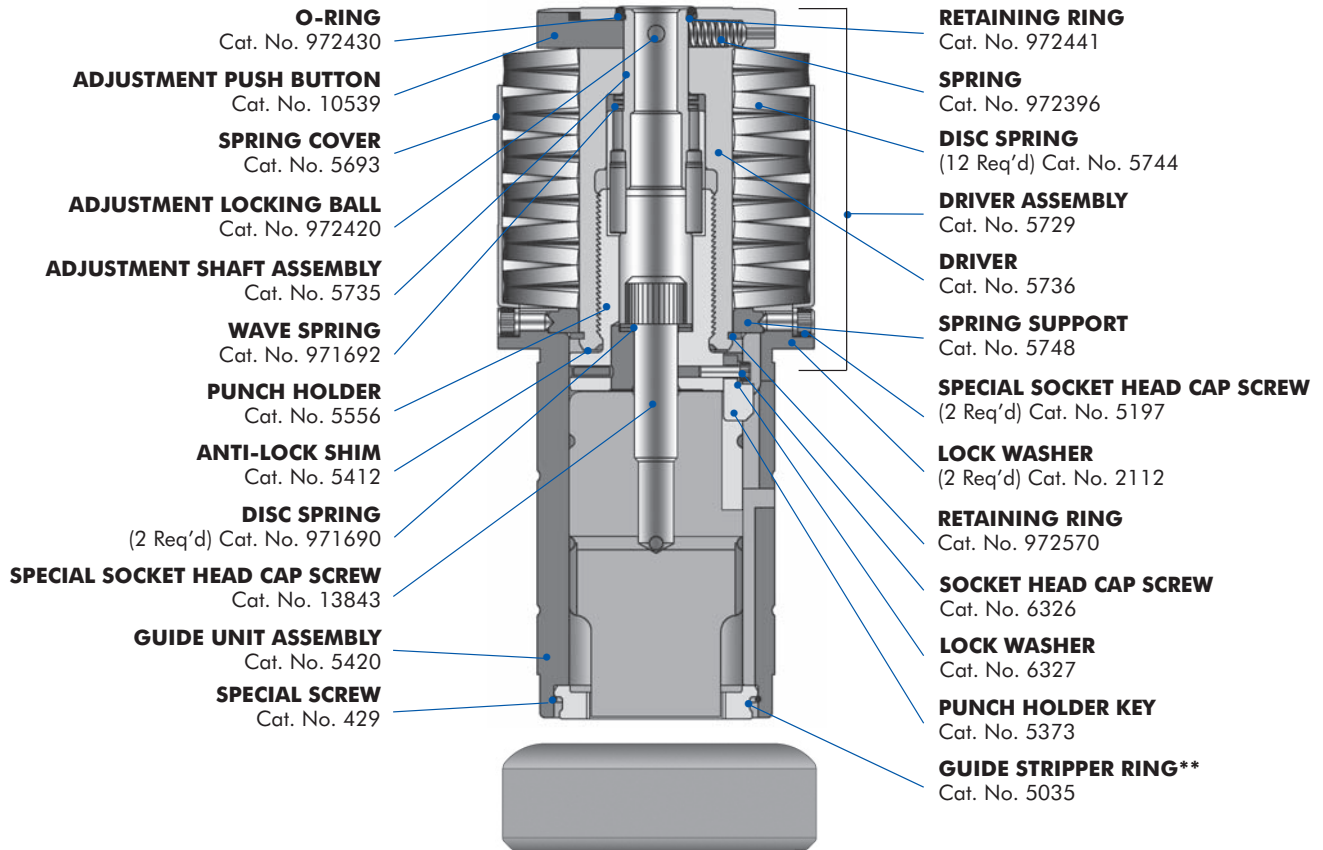

Maximum Material Thickness 6.35mm

Description	Cat. No.	Price
Guide Assembly	13084	
Punches	• Round	13614
	• Shape	13615
	• Optima® Add On	—
Strippers	• Round	5150
	• Shape	5151
Dies	• Round Slug Hugger®†	2196
	• Round Standard	1850
	• Shape Slug Hugger®†	2197
	• Shape Standard	13807
	• Ultima™ Add On (Round)	—
	• Ultima™ Add On (Shape)	—

50.8mm (C) Station Add Ons			
Add ons for Rounds			
Small Diameter < 25.4mm Clearance < 0.10mm	Punch	Die N/C	Stripper N/C N/C
Add ons for Shapes			
Small Widths 0.79 - 1.0mm 1.01 - 2.34mm Small 'A' Dimension** < 29.21mm 29.22 - 31.72 Clearance < 0.10mm	Punch N/C	Die N/C N/C N/C	Stripper N/C N/C N/C

Add to round or shape punch for extra straight before radius, extra back taper, or no back taper.

Notes
Standard guide assys. are keyed for shapes at 0°, 90° and 225°.
All punches will be shipped with no shear unless specified.
† Slug Hugger® dies must be ordered punch size plus clearance. Size restrictions apply. Slug Hugger 2 available on request. Contact Sales Desk for further information.
** Stripper ring must be used with 4X blanking screws Cat No. 5006 & washers 970485 for ABS (supplied and assembled). Cat No. 2810 pack of 4 stripper clips & screws supplied but not assembled as an alternative method to hold stripper.
* 'A' Dimension = longest distance across shape.

Standard Shapes & Key Locations (Die View)

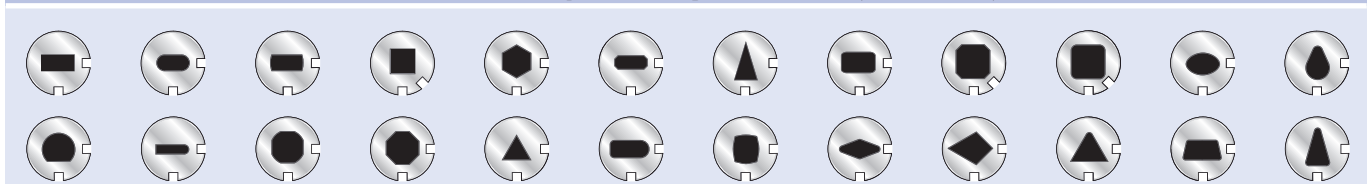

Wilson Amada Style ABS Quick Release C Station

WITH PUSH BUTTON STRIPPER RETENTION
Up to 50.8mm 'A' Dimension*

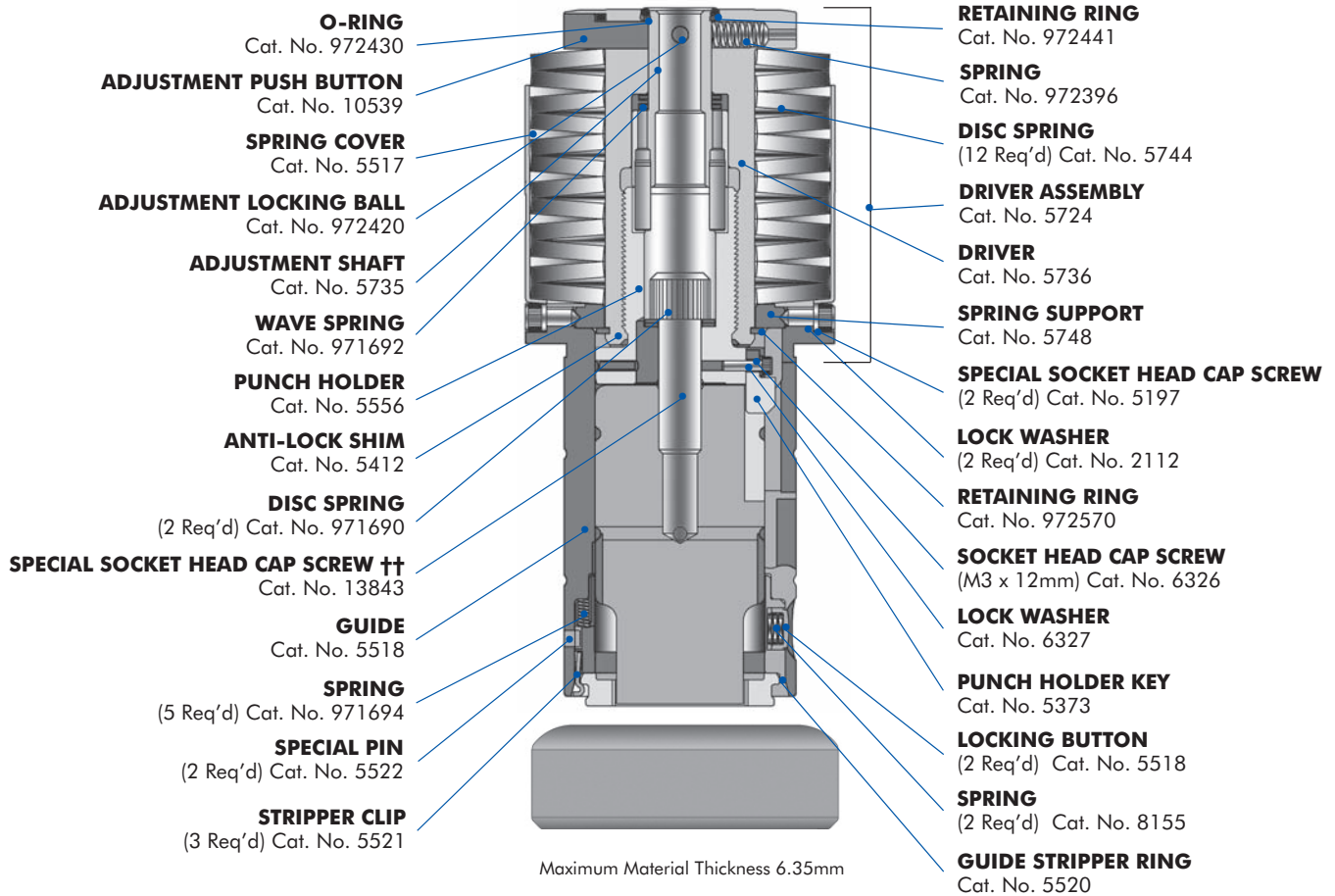

Description	Cat. No.	Price
Guide Assembly	13829	
Punches	<ul style="list-style-type: none"> • Round 13614 • Shape 13615 • Optima® Add On - 	
Strippers	<ul style="list-style-type: none"> • Round 5150 • Shape 5151 	
Dies	<ul style="list-style-type: none"> • Round Slug Hugger®† 2196 • Round Standard 1850 • Shape Slug Hugger®† 2197 • Shape Standard 13807 • Ultima™ Add On (Round) - • Ultima™ Add On (Shape) - 	

50.8mm (C) Station Add Ons			
Add ons for Rounds			
Small Diameter < 25.4mm Clearance < 0.10mm	Punch	Die N/C	Stripper N/C N/C
Add ons for Shapes			
Small Widths 0.79 - 1.0mm 1.01 - 2.34mm Small 'A' Dimension* < 29.21mm 29.22 - 31.72 Clearance < 0.10mm	Punch N/C	Die N/C N/C N/C	Stripper N/C N/C N/C
Add † to round or shape punch for extra straight before radius, extra back taper, or no back taper.			

Notes

Standard guide assys. are keyed for shapes at 0°, 90° and 225°.

All punches will be shipped with no shear unless specified.

† Slug Hugger® dies must be ordered punch size plus clearance. Size restrictions apply. Slug Hugger 2 available on request. Contact Sales Desk for further information.

†† M12 bolt Cat No. 6605 included but not assembled.

* 'A' Dimension = longest distance across shape.

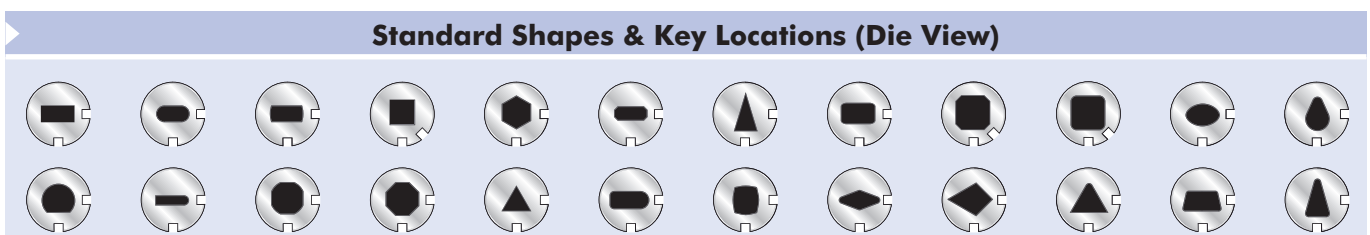

Wilson Amada Style ABS D Station

STRIPPER RETAINED WITH STRIPPER CLIPS

Up to 88.9mm 'A' Dimension*

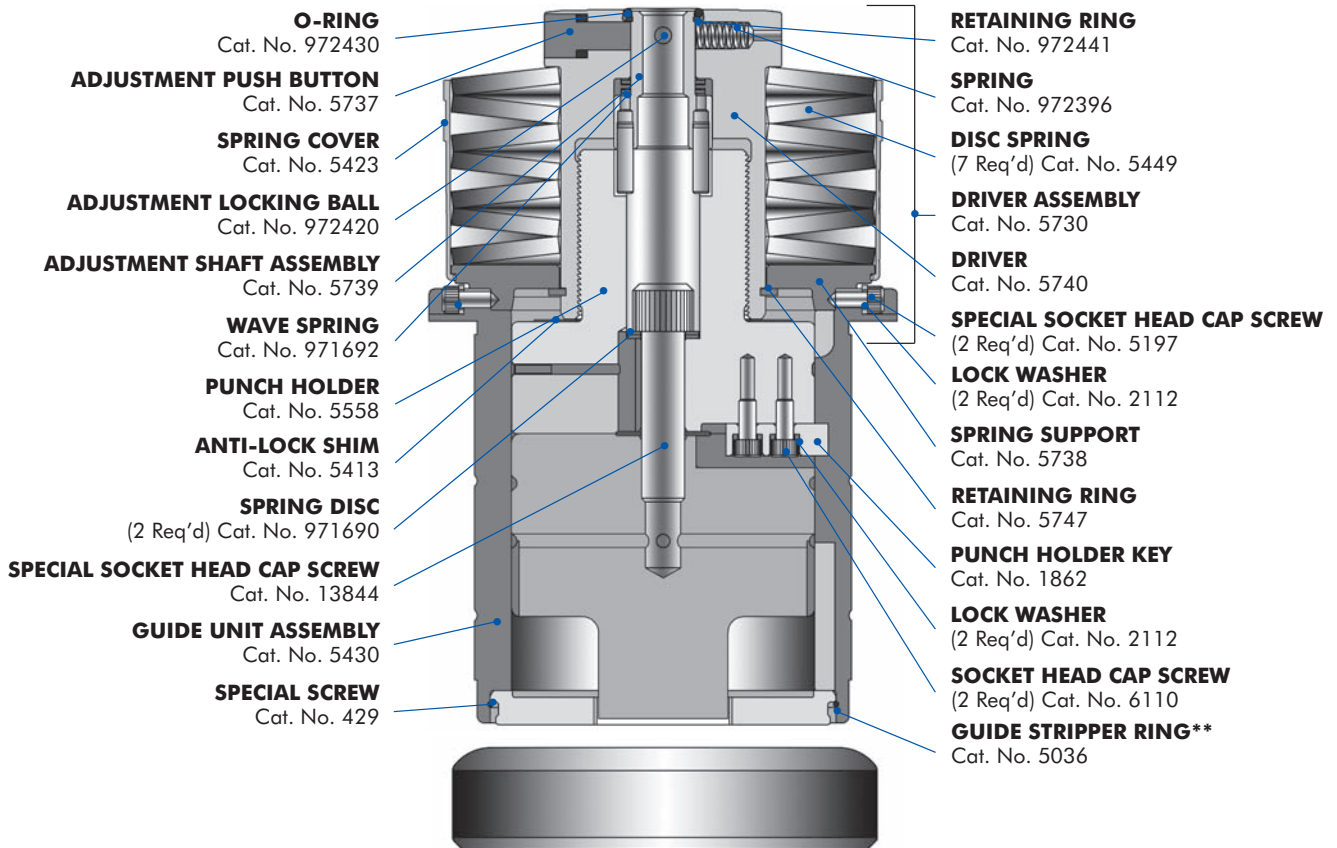

Maximum Material Thickness 6.35mm

Description	Cat. No.	Price
Guide Assembly	13085	
Punches	<ul style="list-style-type: none"> • Round 13616 • Shape 13617 • Optima® Add On - 	
Strippers	<ul style="list-style-type: none"> • Round 5152 • Shape 5153 	
Dies	<ul style="list-style-type: none"> • Round Slug Hugger®† 2198 • Round Standard 1865 • Shape Slug Hugger®† 2199 • Shape Standard 13810 • Ultima™ Add On (Round) - • Ultima™ Add On (Shape) - 	

88.9mm (D) Station Add Ons			
Add ons for Rounds			
Small Diameter 48.26mm 48.27 - 50.77mm Clearance < 0.10mm	Punch	Die N/C N/C	Stripper N/C N/C N/C
Add ons for Shapes			
Small Widths 0.79 - 1.0mm 1.01 - 2.34mm Small 'A' Dimension** < 48.26mm 48.27 - 50.77mm Clearance < 0.10mm	Punch N/C	Die N/C N/C N/C	Stripper N/C N/C N/C
Add to round or shape punch for extra straight before radius, extra back taper, or no back taper.			

Notes

Standard guide assys. are keyed for shapes at 0°, 90° and 225°.

All punches will be shipped with no shear unless specified.

†Slug Hugger® dies must be ordered punch size plus clearance. Size restrictions apply. Slug Hugger 2 available on request. Contact Sales Desk for further information.

** Stripper ring must be used with 4X blanking screws Cat No. 5006 & washers 970485 for ABS (supplied and assembled).
Cat No. 2810 pack of 4 stripper clips & screws supplied but not assembled as an alternative method to hold strippers.

* 'A' Dimension = longest distance across shape.

Standard Shapes & Key Locations (Die View)

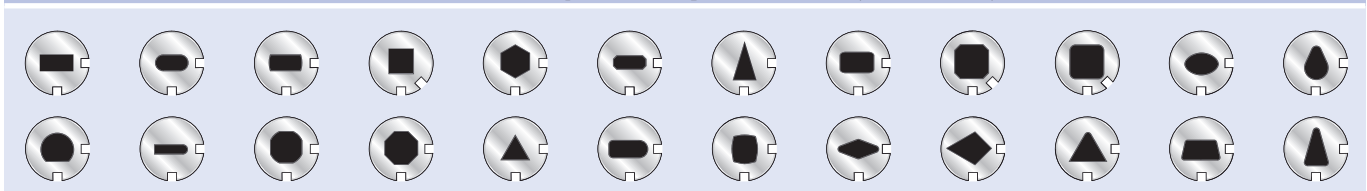

Wilson Amada Style ABS Quick Release D Station

WITH PUSH BUTTON STRIPPER RETENTION

Up to 88.9mm 'A' Dimension*

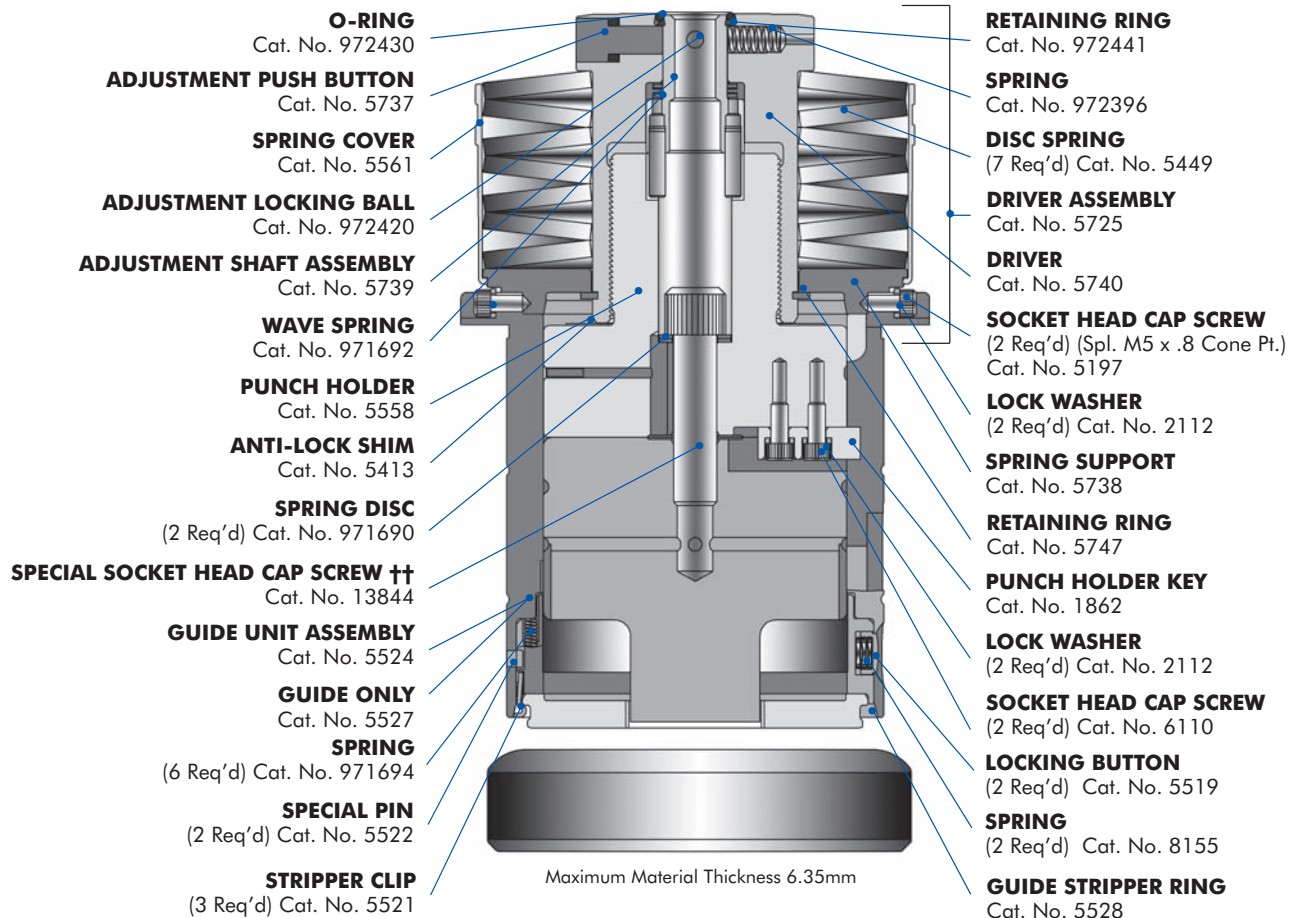

Description	Cat. No.	Price
Guide Assembly	13830	
Punches	• Round	13616
	• Shape	13617
	• Optima® Add On	—
Strippers	• Round	5152
	• Shape	5153
Dies	• Round Slug Hugger®†	2198
	• Round Standard	1865
	• Shape Slug Hugger®†	2199
	• Shape Standard	13810
	• Ultima™ Add On (Round)	—
	• Ultima™ Add On (Shape)	—

88.9mm (D) Station Add Ons				
Add ons for Rounds				
Small Diameter	Punch	Die	Stripper	
48.26mm		N/C	N/C	
48.27 - 50.77mm		N/C	N/C	
Clearance < 0.10mm				
Add ons for Shapes				
Small Widths	Punch	Die	Stripper	
0.79 - 1.0mm		N/C	N/C	
1.01 - 2.34mm	N/C	N/C	N/C	
Small 'A' Dimension* < 48.26mm		N/C	N/C	
48.27 - 50.77mm		N/C	N/C	
Clearance < 0.10mm				

Add † to round or shape punch for extra straight before radius, extra back taper, or no back taper.

Notes	
Standard guide assys. are keyed for shapes at 0°, 90° & 225°.	† Slug Hugger® dies must be ordered punch size plus clearance. Size restrictions apply. Slug Hugger 2 available on request. Contact Sales Desk for further information.
1.6mm Rooftop shear is given to all punches with 'A' dimension greater than 50.8mm, and width greater than 6.35mm, at no extra charge.	†† M12 bolt Cat No. 970467 included but not assembled.
All punches 6.35mm and under in width will be shipped with no shear unless specified.	* 'A' Dimension = longest distance across shape.

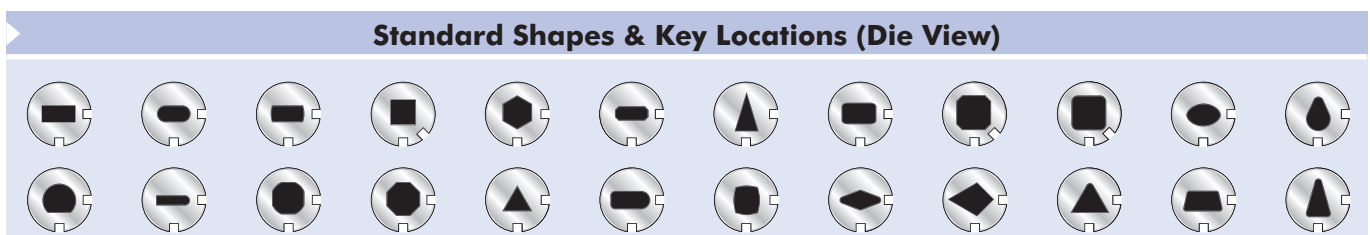

Wilson Amada Style ABS E Station

STRIPPER RETAINED WITH STRIPPER CLIPS

Up to 114.3mm 'A' Dimension*

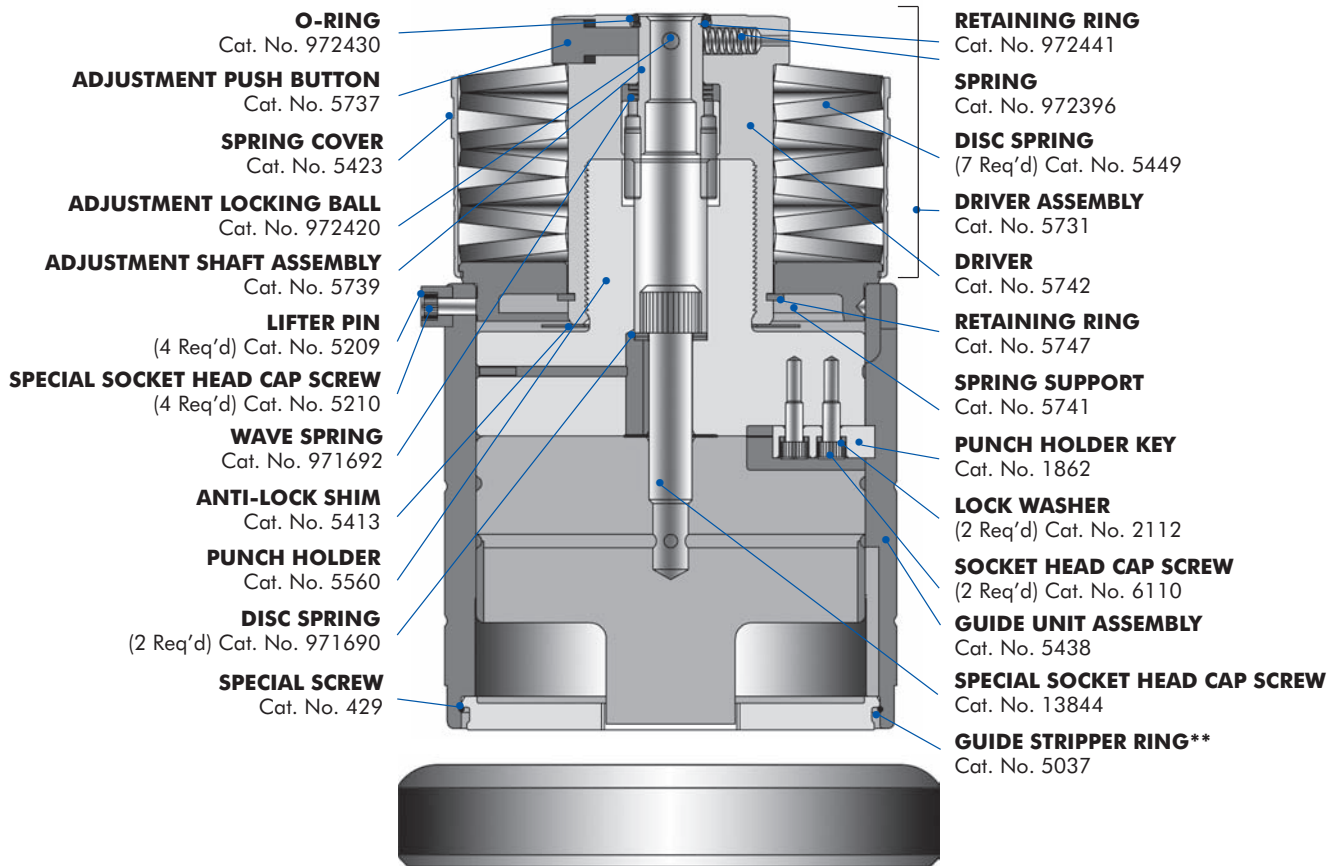

Maximum Material Thickness 6.35mm

Description	Cat. No.	Price
Guide Assembly	13088	
Punches	<ul style="list-style-type: none"> • Round 13618 • Shape 13619 • Optima® Add On - 	
Strippers	<ul style="list-style-type: none"> • Round 5154 • Shape 5155 	
Dies	<ul style="list-style-type: none"> • Round Slug Hugger®† 2200 • Round Standard 1878 • Shape Slug Hugger®† 2201 • Shape Standard 13817 • Ultima™ Add On (Round) - • Ultima™ Add On (Shape) - 	

114.3mm (E) Station Add Ons			
Add ons for Rounds			
Small Diameter < 86.36mm 86.37 - 88.87mm Clearance < 0.10mm	Punch	Die N/C N/C	Stripper N/C N/C N/C
Add ons for Shapes			
Small Widths 0.79 - 1.0mm 1.01 - 2.34mm Small 'A' Dimension** < 86.36mm 86.37 - 88.87mm Clearance < 0.10mm	Punch N/C	Die N/C N/C N/C	Stripper N/C N/C N/C
Add to round or shape punch for extra straight before radius, extra back taper, or no back taper.			
Notes			
Standard guide assys. are keyed for shapes at 0°, 90° and 225°.			
All punches will be shipped with no shear unless specified.			
†Slug Hugger® dies must be ordered punch size plus clearance. Size restrictions apply. Slug Hugger 2 available on request. Contact Sales Desk for further information.			
** Stripper ring must be used with 4X blanking screws Cat No. 5006 & washers 970485 for ABS (supplied with assembled).			
Cat No. 2810 pack of 4 stripper clips & screws supplied but not assembled as an alternative method to hold strippers.			
* 'A' Dimension = longest distance across shape.			

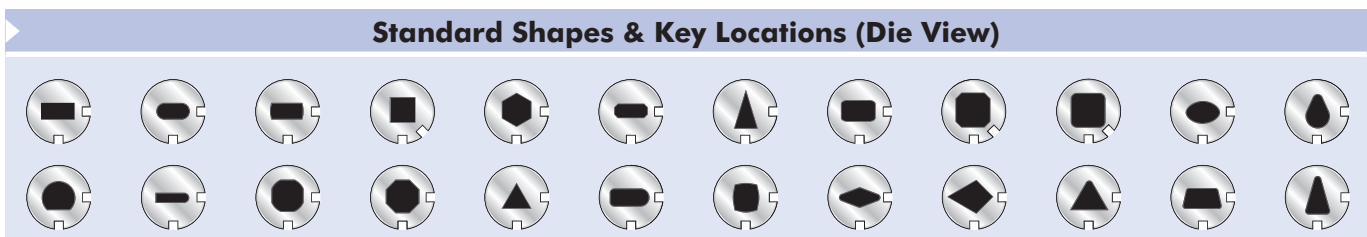

Wilson Amada Style ABS Quick Release E Station

WITH PUSH BUTTON STRIPPER RETENTION

Up to 114.3mm 'A' Dimension*

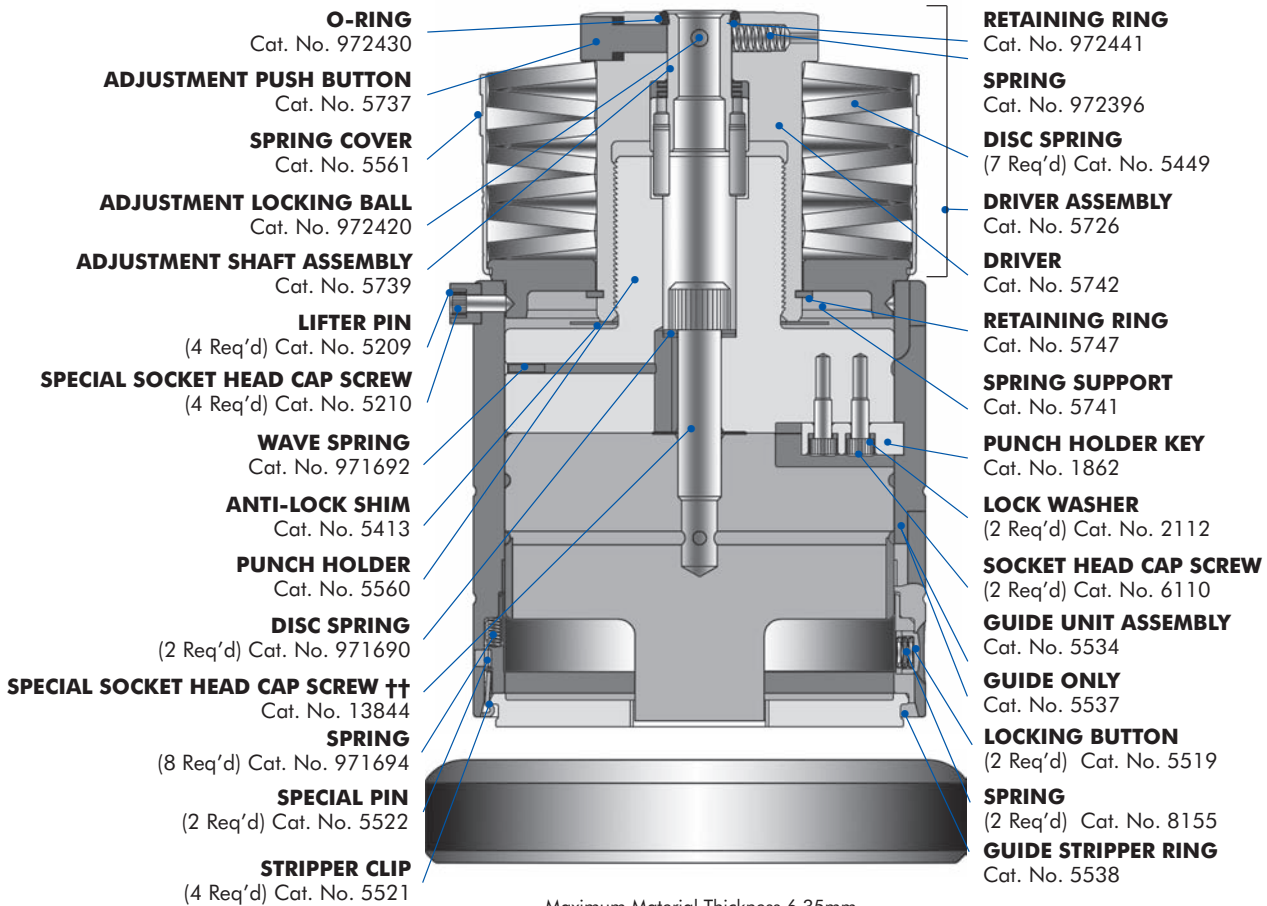

Maximum Material Thickness 6.35mm

Description	Cat. No.	Price
Guide Assembly	13831	
Punches	<ul style="list-style-type: none"> • Round 13618 • Shape 13619 • Optima® Add On - 	
Strippers	<ul style="list-style-type: none"> • Round 5154 • Shape 5155 	
Dies	<ul style="list-style-type: none"> • Round Slug Hugger®† 2200 • Round Standard 1878 • Shape Slug Hugger®† 2201 • Shape Standard 13817 • Ultima™ Add On (Round) - • Ultima™ Add On (Shape) - 	

114.3mm (E) Station Add Ons			
Add ons for Rounds			
Small Diameter < 86.36mm 86.37 - 88.87mm Clearance < 0.10mm	Punch	Die N/C N/C	Stripper N/C N/C N/C
Add ons for Shapes			
Small Widths 0.79 - 1.0mm 1.01 - 2.34mm Small 'A' Dimension* < 86.36mm 86.37 - 88.87mm Clearance < 0.10mm	Punch N/C	Die N/C N/C N/C	Stripper N/C N/C N/C
Add † to round or shape punch for extra straight before radius, extra back taper, or no back taper.			

Notes	
Standard guide assys. are keyed for shapes at 0° & 90°.	† Slug Hugger® dies must be ordered punch size plus clearance. Size restrictions apply. Slug Hugger 2 available on request. Contact Sales Desk for further information.
1.6mm Rooftop shear is given to all punches with 'A' dimension greater than 50.8mm, and width greater than 6.35mm, at no extra charge.	†† M12 bolt Cat No. 970467 included but not assembled.
All punches 6.35mm and under in width will be shipped with no shear unless specified.	* 'A' Dimension = longest distance across shape.

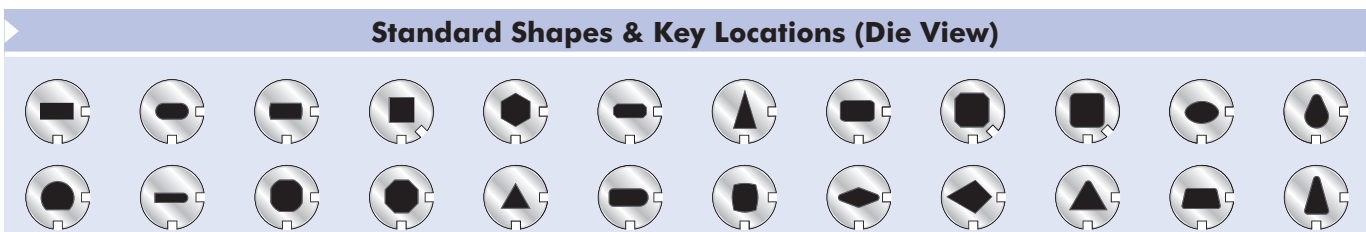

Close to Clamp Tooling



88.9mm (D) Station for punching close to clamps

Description	Cat. No.	Price
Dies		
• Slug Hugger®† (relief 2 sides, shp at 90°)	5157	
• Slug Hugger®† (relief 2 sides, shp at 0°-90°)	5330	
• Slug Hugger®† (relief 1 side, shp at 90°)	2464	
• Slug Hugger®† (relief 1 side, shp at 0°-90°)	5333	
• Standard (relief 2 sides, shp at 90°)	13814	
• Standard (relief 2 sides, shp at 0°-90°)	13813	
• Standard (relief 1 side, shp at 90°)	13812	
• Standard (relief 1 side, shp at 0°-90°)	13811	

114.3mm (E) Station for punching close to clamps

Description	Cat. No.	Price
Dies		
• Slug Hugger®† (relief 2 sides, shp at 90°)	5159	
• Slug Hugger®† (relief 2 sides, shp at 0°-90°)	5340	
• Slug Hugger®† (relief 1 side, shp at 90°)	2467	
• Slug Hugger®† (relief 1 side, shp at 0°-90°)	5343	
• Standard (relief 2 sides, shp at 90°)	13821	
• Standard (relief 2 sides, shp at 0°-90°)	13820	
• Standard (relief 1 side, shp at 90°)	13819	
• Standard (relief 1 side, shp at 0°-90°)	13818	

Notes

† Slug Hugger® dies must be ordered punch size plus clearance. Size restrictions apply. Contact Sales Desk for further information (patented).

* 'A' Dimension = longest distance across shape.

Slitting, complex shapes, clusters and close to clamps – DuraDie is the perfect solution for all these jobs

Slitting Solution

This is a special die holder assembly which provides you with the ideal slitting solution. The die inserts are fully supported by the die base and are hard wearing and economical to replace.

Problem Solving

The DuraDie assembly is also the perfect solution when you are punching complex two dimensional shapes and cluster patterns with small webs between holes. In fact the DuraDie system can help whenever die strength is an issue.

Shock Resistant

The aperture (which closely follows the profile in the die insert), is cut into the shock resistant die holder which fully supports the special die blade and the specially located shims.



Durable

With a die insert made using Ultima™, a special powdered tool steel, you will get more hits between regrinds and reduced downtime.

Practical & Economical

The complete assembly consists of a special die insert, a shim pack and a specially reinforced die holder. You can order duplicate die inserts for different materials and if you need to replace a worn die all you need is a new insert.

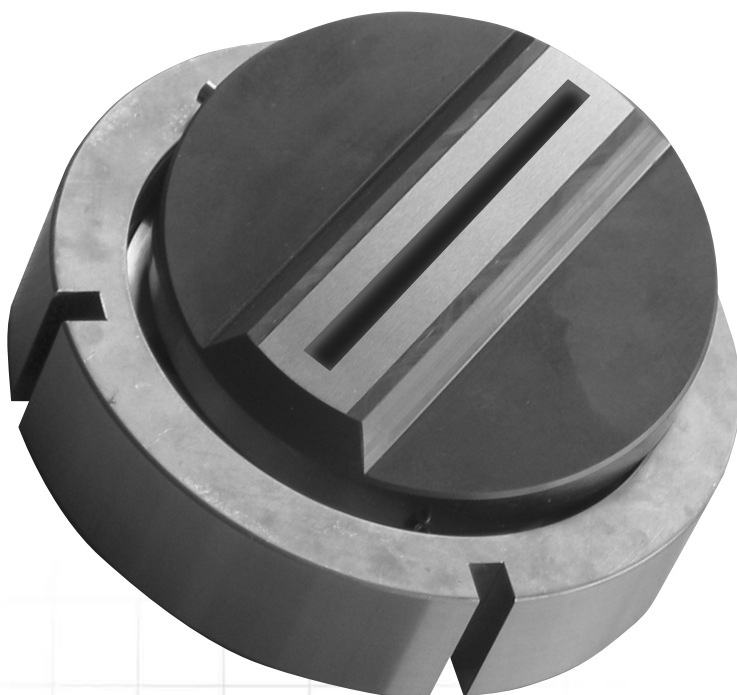

DURADIE
WILSON
TOOL

50.8mm (C) Station Slitting

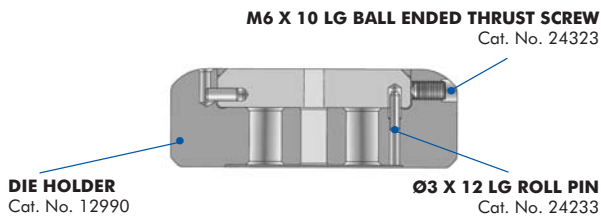

Description	Cat. No.	Price
Die Base Assembly (not including die blade)	12989	
Die Blade (Slughugger)	12992	
Shim Pack	12995	
Knockout Tool	24310	

Maximum length * = 51mm Maximum width * = 7mm *Subject to certain restrictions

88.9mm (D) Station Slitting



Description	Cat. No.	Price
Die Base Assembly (not including die blade)	13006	
Die Blade (Slughugger)	13009	
Shim Pack	13012	
Knockout Tool	24310	

Maximum length * = 86mm Maximum width * = 7mm *Subject to certain restrictions

88.9mm (D) Station Close to Clamps

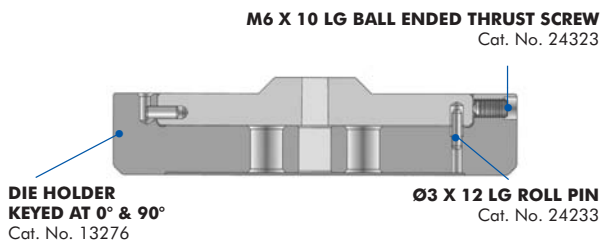

Description	Cat. No.	Price
Die Base Assembly 0&90° (not including die blade)	13276	
Die Blade – relieved on 1 side (Slughugger)	13280	
Die Blade – relieved on 2 sides (Slughugger)	13282	
Shim Pack	13012	
Knockout Tool	24310	

Maximum length * = 81mm Maximum width * = 7mm *Subject to certain restrictions

114.3mm (E) Station Slitting

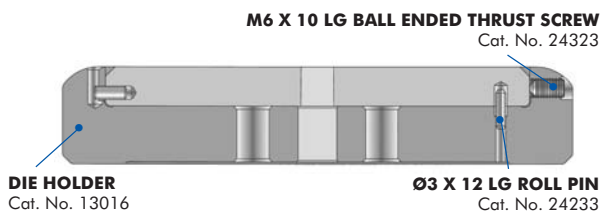

Description	Cat. No.	Price
Die Base Assembly (not including die blade)	13015	
Die Blade (Slughugger)	13014	
Shim Pack	13017	
Knockout Tool	24313	

Maximum length * = 111mm Maximum width * = 11mm *Subject to certain restrictions

114.3mm (E) Station Close to Clamps

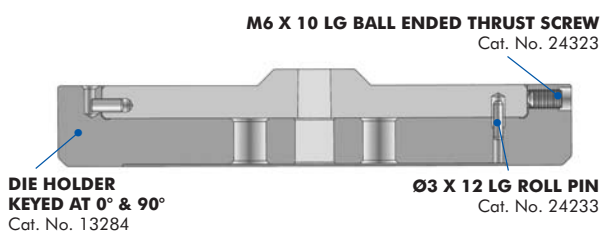

Description	Cat. No.	Price
Die Base Assembly 0&90° (not including die blade)	13284	
Die Blade – relieved on 1 side (Slughugger)	13288	
Die Blade – relieved on 2 sides (Slughugger)	13290	
Shim Pack	13017	
Knockout Tool	24313	

Maximum length * = 111mm Maximum width * = 11mm *Subject to certain restrictions

Replacement Insert Assembly

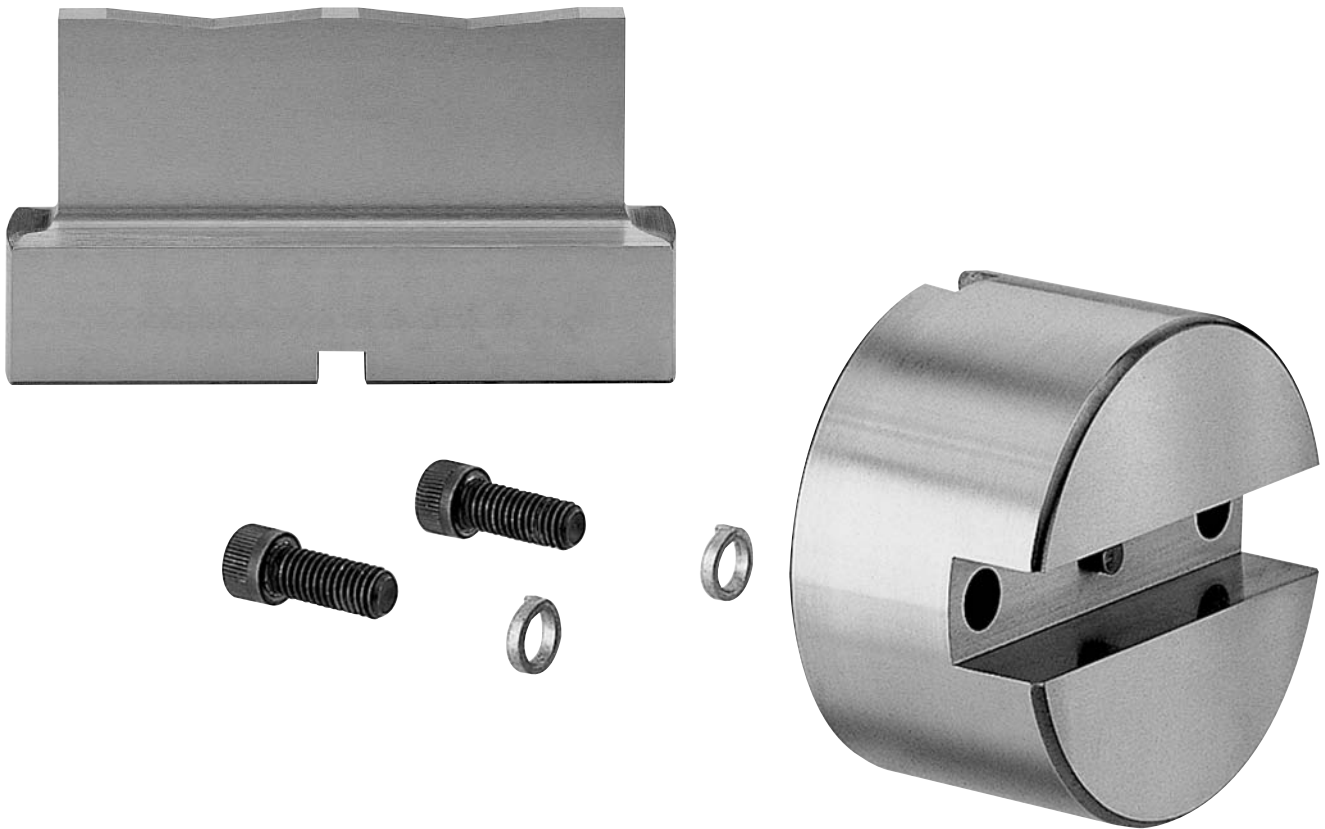

Replaceable Insert Assembly

Station	Body (1/2" - 13)		Body (M - 12)		Punch Insert		Set (1/2" - 13)		Set (M - 12)		
	Cat. No.	Price	Cat. No.	Price	Cat. No.	Price	Cat. No.	Price	Cat. No.	Price	
50.8mm (C)	2623		2625		2590		2568		2624		
88.9mm (D)	1966		2286		1967		1965		2372		
114.3mm (E)	1969		2287		1970		1968		2373		
Parts Description										Cat. No.	Price
Socket Head Cap Screw – 3/8" - 16 x 1-1/2" long (for 50.8mm (C) station)										6391	
Socket Head Cap Screw – 3/8" - 16 x 1-1/2" long (for 88.9mm (D) & 114.3mm (E) stations)										6019	
High Collar Lock Washer for 3/8" screw										2129	
Dowel Pin – 1/4" Dia. x 450" long (All stations)										6004	

Notes

- * Optima® is standard on punch inserts.
- * Blade insert punches under 9.53mm in width will be shipped with no shear unless specified.
- * Double Valley Shear is recommended for widths of 4.75mm up to 9.53mm and minimum lengths of 50.8mm when used for nibbling.
- * Undersized dimensions will incur additional charges. Please consult the fee schedule for the appropriate station to determine the charge.
- * See shear chart on page 30.
- * For widths less than 2.36mm, consult the sales desk.
- * Maximum width 19mm.
- * Inserts are available as obround to be used with rectangle dies, to eliminate 'Saw Tooth Effect'.

Punch Shims, Die Shims and Slug Ejectors

Die Shims			
Station	Quantity	Cat. No.	Price
0.25mm Thick – Individually			
12.7mm (A)	1	2101	
31.75mm (B)	1	2097	
50.8mm (C)	1	2089	
88.9mm (D)	1	2081	
114.3mm (E)	1	2073	
0.25mm Thick – Package			
12.7mm (A)	25	2208	
31.75mm (B)	25	2209	
50.8mm (C)	10	2210	
88.9mm (D)	5	2211	
114.3mm (E)	5	2212	
0.75mm Thick – Individually			
12.7mm (A)	1	2721	
31.75mm (B)	1	2723	
50.8mm (C)	1	2725	
88.9mm (D)	1	2727	
114.3mm (E)	1	2729	
0.75mm Thick – Package			
12.7mm (A)	25	2722	
31.75mm (B)	25	2724	
50.8mm (C)	10	2726	
88.9mm (D)	5	2728	
114.3mm (E)	5	2730	
1.5mm Thick – Individually			
12.7mm (A)	1	2104	
31.75mm (B)	1	2100	
50.8mm (C)	1	2092	
88.9mm (D)	1	2084	
114.3mm (E)	1	2076	
1.5mm Thick – Package			
12.7mm (A)	25	2172	
31.75mm (B)	25	2173	
50.8mm (C)	10	2174	
88.9mm (D)	5	2175	
114.3mm (E)	5	2176	

Punch Shims			
Station	Quantity	Cat. No.	Price
Individually			
12.7mm (A)	1	13080	
31.75mm (B)	1	152	
50.8mm (C)	1	2096	
88.9mm (D)	1	2088	
114.3mm (E)	1	2080	
Package			
31.75mm (B)	25	98	
50.8mm (C)	10	2169	
88.9mm (D)	5	2170	
114.3mm (E)	5	2171	

Slug Ejectors			
Square Urethane			
Hole Diameter in Punch	Quantity	Cat. No.	Price
3.2mm	50	6116	
4.8mm	50	6117	
9.5mm	50	6118	
12.7mm	50	6119	
Assortment	50	6410	

Non Standard Keying

When ordering shapes at non-standard angles, use the diagrams below to eliminate any confusion.

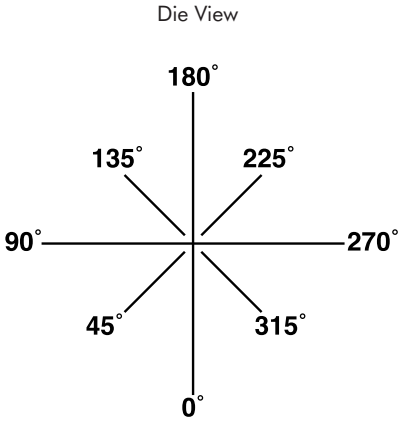

Front of Machine

Wilson Tool's keying diagram.

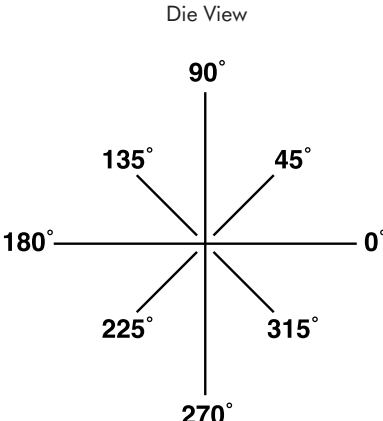

Front of Machine

This key location matches Amada's® turret punch press programming method.

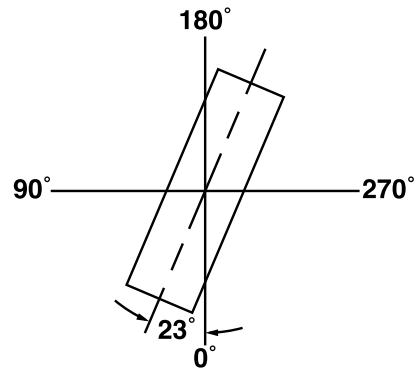

Example

Shape at 23°

Shape at single angles other than standard (Note: No additional charge on A & B Stations for shape at 45° increments)

Station	Punches	Dies	Guides or Strippers
12.7mm (A)	No Charge		No Charge
31.75mm (B)			Not Applicable
50.8mm (C)			Not Applicable
88.9mm (D)			Not Applicable
114.3mm (E)			Not Applicable

Standard Keying, plus extra pins or keys for shapes at other than 45° increments

Station	Punches	Dies	Guides or Strippers
12.7mm (A)	Not Available	Not Available	per key
31.75mm (B)	Not Available	Not Available	per key
50.8mm (C)	per pin	per key	Not Applicable
88.9mm (D)	per pin	per key	Not Applicable
114.3mm (E)	per pin	per key	Not Applicable

Standard Keying, plus extra pins or keys for shapes at 45° increments

Station	Punches		Dies		Guides or Strippers
	Available Options	Add On Price	Available Options	Add On Price	
12.7mm (A)	Not available	Not available	Not available	Not available	per key
31.75mm (B)	0° & 45°		0° & 45°		per key
	0° & 180°		0° & 180°		per key
50.8mm (C)	45° Increments	per pin	45° Increments	per key	Not applicable
88.9mm (D)	45° Increments	per pin	45° Increments	per key	Not applicable
114.3mm (E)	45° Increments	per pin	45° Increments	per key	Not applicable

Shear Options

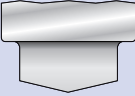
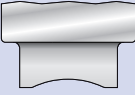
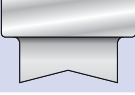
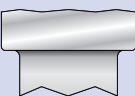
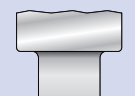
Type of Shear	Benefit	Limitation
 Rooftop	Best shear for punching at maximum tonnages.	When nibbling, bite must be 75% of punch dimension or excessive side loading will result.
 Concave or Double Concave	Best shear for nibbling because it inverts stresses.	The punch is less resistant to breakage when punching at high tonnages because of inverted stresses.
 Inverted Rooftop	Also good shear for nibbling because it inverts stresses.	More susceptible to breakage because of a sharp focal point for stresses – use with great care.
 Double Valley Shear	Best shear for nibbling when shape is long and narrow.	The punch is less resistant to breakage when punching at high tonnages because of inverted stresses.
 JK Shear	A special punch tip shear that allows you to punch high strength materials with a reduced risk of breakage.	Can only be used on punches up to 25.4mm diameter or 'A' dimension*.

Special Shears					
Station	'A' Dimensions*	Inverted Rooftop		Double Valley	
		Single Concave		Double Concave	
		1.6mm Shear	3.2mm Shear	1.6mm Shear	3.2mm Shear
31.75mm (B)	Within 31.75mm		N/A		N/A
50.8mm (C)	Within 50.8mm				
88.9mm (D)	Within 88.9mm				
114.3mm (E)	Within 114.3mm				

JK Shear	
Shape	Add on Price
Round	
Rectangle, Square, Hexagon Single 'D', Double 'D'	
Oround	

Die Clearance Selection Information			
Material	% Total Clearance		
	Minimum	Best	Maximum
Copper, 1/2 Hard	8	12	16
Brass, 1/2 Hard	6	11	16
Mild Steel	10	15	20
Steel 0.50C	12	18	24
Aluminium, Soft	5	10	15
Stainless Steel	15	20	25

% x Material Thickness = Total Clearance

Notes
<p>If specified: 3.2mm maximum rooftop shear can be given at N/C for any round or shape in 50.8mm (C), 88.9mm (D) or 114.3mm (E). For rooftop shear on any round or shape in 12.7mm (A) or 31.75mm (B) stations, add</p> <ul style="list-style-type: none"> • 1.6mm rooftop shear is given to all punches with 'A' dimension* greater than 50.8mm and width greater than 6.35mm at no extra charge. All punches 6.35mm and under in width will be shipped with no shear unless specified. <p>*'A' Dimension = longest distance across shape. **NOTE: In some instances, inverted rooftop is substituted for single and double concave shears.</p>

WILSON TOOL INTERNATIONAL (EUROPE) LTD

United Kingdom

European Headquarters

Stirling Road, South Marston
Industrial Estate, Swindon, Wiltshire
SN3 4TQ, United Kingdom
Tel (Free): 0800 373748
Tel: +44 (0)1793 831818
Fax (Free): 0800 373758
Fax: +44 (0)1793 831945
email: sales@wilsonstool.eu.com

France

Bat B, 51 Rue d'Ourdy,
77550 Réau, France
Tel: (Gratuit) 0800 10 29 00
Tel: +33 (0)1 64 13 47 80
Fax: (Gratuit) 0800 10 40 14
Fax: +33 (0)1 64 13 47 81
email: ventes@wilsonstool.eu.com

Germany

Gottlieb Daimler Str 2
31552 Rodenberg, Germany
Tel: (Frei) 00800 945 766 8665
Tel: +49 (0)5723 747 0
Fax: (Frei) 00800 945 766 329
Fax: +49 (0)5723 747 10
email: verkauf@wilsonstool.eu.com

Scandinavia

Ejby Industrivej 40
DK-2600 Glostrup, Denmark
Tel (Free): 80 20 20 24
Tel: +45 44 53 16 99
Fax (Free): 80 20 20 26
Fax: +45 44 53 06 07
email: salesdk@wilsonstool.eu.com

email: sales@wilsonstool.eu.com

Visit us online at: www.wilsonstool.com

United States

Worldwide Headquarters

12912 Farnham Avenue
White Bear Lake, MN 55110 USA
Tel (Free): 800 328 9646
Tel: (651) 426 9133
Fax (Free): 800 222 0002
Fax: (651) 426 9134
email: marketing@wilsonstool.com

Argentina

Wilson Tool International(r), Argentina
Von Wernicke 3041 PB
San Isidro, 1642 Buenos Aires
Argentina
Tel: +54 114 7634004
Fax: +54 114 5084190
email: ventasargentina@wilsonstool.com

China

No. 6 Building of 58
4018 Lane Huaning Road
Xinhuang Industry Park
201108 Shanghai, China
Tel: +86 21 51089638
Fax: +86 21 64422195
email: sales@wilsonstool.cn

Mexico

The Wilson Company SRL de CV
BLVD. Diaz Ordaz no 140 piso 20
Col. Santa Maria
Monterrey, Nuevo Leon
Mexico
C.P. 64650
Tel: 52 (81) 8865 4820
Fax: 52 (81) 8865 4599

South Africa

Wilson Tool South Africa Limited
Rynhurst Business Park
156 Pretoria Road, Rynfield
Benoni, 1501, Gauteng
Republic of South Africa
Tel: +27 877 217 875
Fax: 086 657 8629
email: simon.penney@wilsonstool.com



Distribuitor:



S.C. SM TECH SRL

Tehnologii și soluții pentru industria prelucrării tablelor

Tel: 0040-331-401599

Tel/Fax: 0040-231-515702

Tel Mob: 0040-745-528494

E-mail: [office \(at\) sm-tech.ro](mailto:office(at)sm-tech.ro)

Web:

www.sm-tech.ro

www.wilsonool.ro

Vă stăm la dispoziție cu plăcere cu orice informație sau ofertă pentru scule Wilson Tool destinate mașinii d-voastră de ștantat CNC sau preseii d-voastră abkant

