

Part Number	Pin Ø A	Pin Ø B	Length C	Length D
32640/32641	8mm	8mm	92mm	190mm

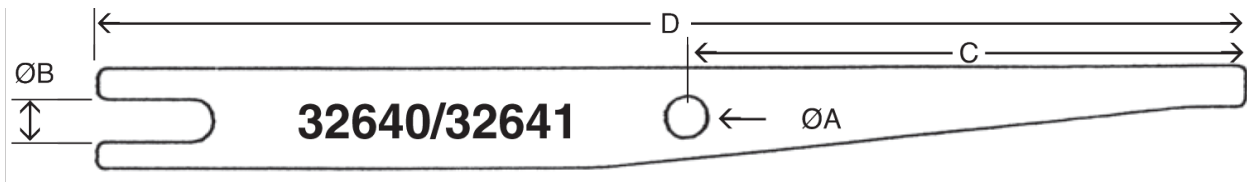

Reference page 13 of the Replacement Clamp Assemblies and Keys Catalogue, October 2012.

Part Number	Pin Ø A	Pin Ø B	Length C	Length D
32665/32666	6mm	5mm	57.5mm	183mm

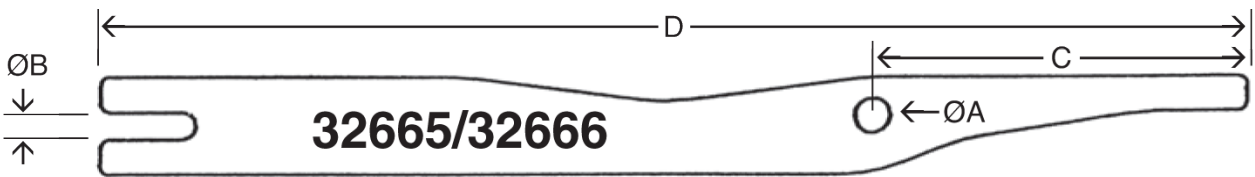

Reference page 7 & 19 of the Replacement Clamp Assemblies and Keys Catalogue, October 2012.

Part Number	Pin Ø A	Pin Ø B	Length C	Length D
32785	6mm	5mm	57.5mm	183mm

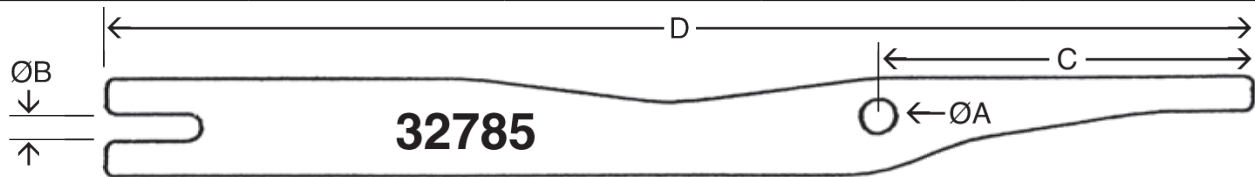

Reference page 25 of the Replacement Clamp Assemblies and Keys Catalogue, October 2012.

Part Number	Pin Ø A	Pin Ø B	Length C	Length D
32685/32686	6mm	5mm	65.5mm	190mm

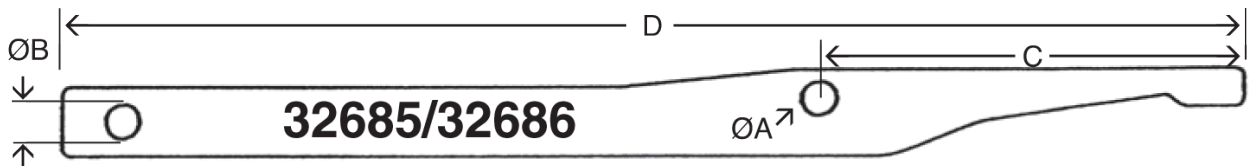

Reference page 21 of the Replacement Clamp Assemblies and Keys Catalogue, October 2012.

Part Number	Pin Ø A	Pin Ø B	Length C	Length D
32701/32702	6mm	5mm	65mm	195mm

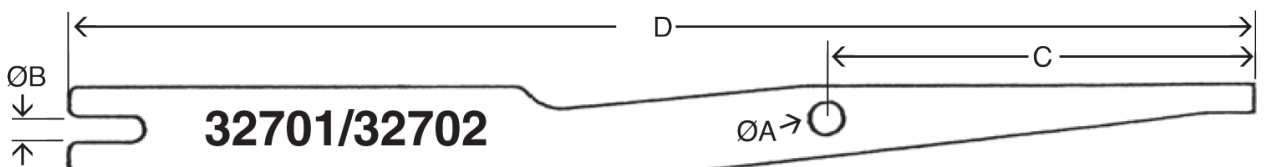

Reference page 17 of the Replacement Clamp Assemblies and Keys Catalogue, October 2012.

# Clamp Dimensions Reference Chart



Part Number	Pin Ø A	Pin Ø B	Length C	Length D
32728/32729	8mm	8mm	97.5mm	199mm

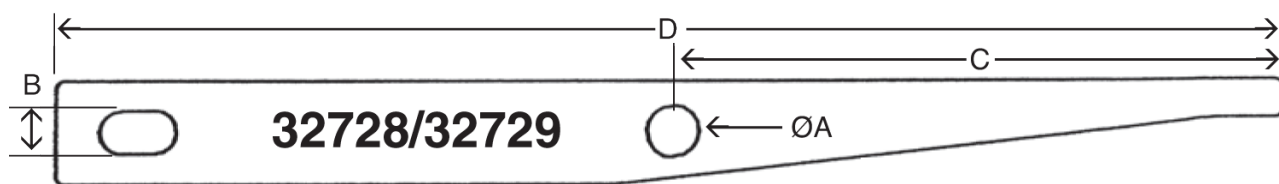

Reference page 9 of the Replacement Clamp Assemblies and Keys Catalogue, October 2012.

Part Number	Pin Ø A	Pin Ø B	Length C	Length D
32758/32759	6mm	5mm	58mm	195mm

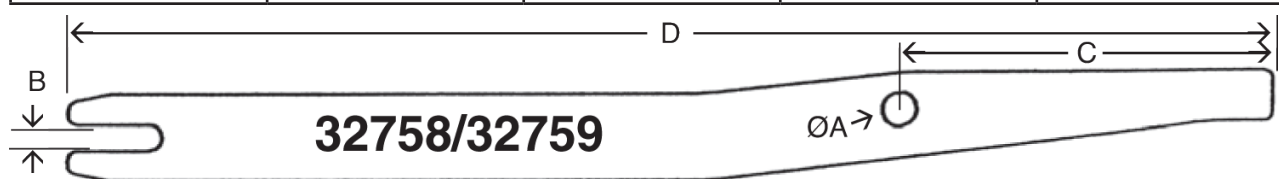

Reference page 15 of the Replacement Clamp Assemblies and Keys Catalogue, October 2012.

Part Number	Pin Ø A	Pin Ø B	Length C	Length D
32775/32776	6mm	5mm	55mm	175mm

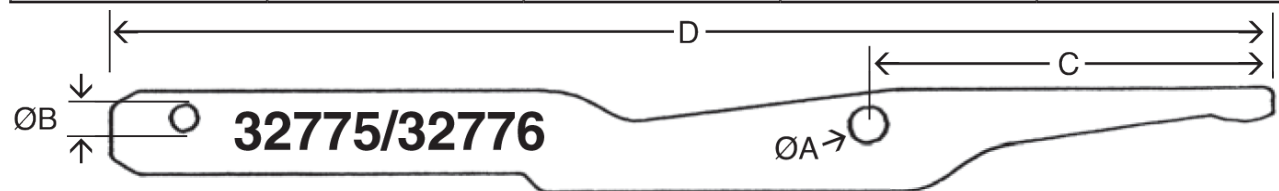

Reference page 23 of the Replacement Clamp Assemblies and Keys Catalogue, October 2012.

Part Number	Pin Ø A	Pin Ø B	Length C	Length D
32732	13mm	10mm	97.5mm	207mm

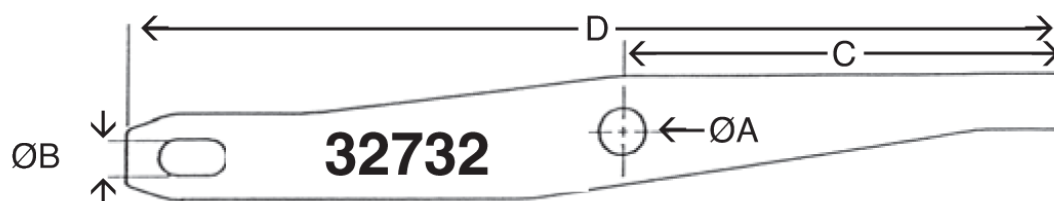

Reference page 11 & 27 of the Replacement Clamp Assemblies and Keys Catalogue, October 2012.

Distributor:  
 S.C. SM TECH S.R.L.  
[www.sm-tech.ro](http://www.sm-tech.ro)  
 office (at) sm-tech.ro  
 Tel : 0745-528494  
 Tel/Fax: 0231-515702