

WILSON THICK TURRET TOOLING

Distributor:
S.C. SM TECH S.R.L.
www.sm-tech.ro
office @ sm-tech.ro
Tel: 0331-401599
Tel : 0745-528494
Fax: 0374-091010



Solutions for Punch Press Tooling

Terms and Conditions

Order	Minimum order is
Credit	All orders are subject to the approval of our credit department. If you are a new account, please furnish us with a bank reference and three supplier references. A credit limit will be imposed on new accounts until credit has been established.
Payment	Terms are net 30 days.
Cancellation	In the event an order is cancelled, a charge will be made to cover labour, materials and overheads.
Returned Material	A handling charge of 25% is made on all standard parts returned for credit. Written permission and shipping instructions must be obtained before the return of any material. Special tooling cannot be returned.
Claims	All claims for shortages must be made within 3 days of the invoice date.
Prices	Prices and specifications subject to change without prior notice. E & OE. All prices are exclusive of VAT.

Distributor:
S.C. SM TECH S.R.L.
www.sm-tech.ro
office @ sm-tech.ro
Tel: 0331-401599
Tel : 0745-528494
Fax: 0374-091010



Wilson's **HPX Thick Turret Tooling** system is a revolutionary approach to punch press tooling. HPX delivers the most technologically advanced thick turret tooling on the market by incorporating Wilson's EXP™ punch technology into an assembly with HP2 adjustment and the ability to accept round or shaped punches. In addition, every EXP™ punch is made with Wilson Tool's exclusive Ultima® premium tool steel (as standard) resulting in twice the tool life of most standard punches.



Wilson's **HP Thick Turret Tooling** offers the same features as Basix with the addition of the easiest punch length adjustment in the industry. The HP2 spring pack assembly delivers fast and easy tool-less punch length adjustments, in or out of the machine.



Wilson's **Basix Thick Turret Tooling** is an affordable solution for fabricators looking to improve productivity and reduce tool replacement costs. Stronger tool steels and optional surface enhancements combine to make Wilson Basix the standard in low cost, high quality thick turret tooling.



Optima® is a proprietary TiCN (titanium carbide) coating which significantly enhances tooling performance. This coating provides a level of surface hardness, wear resistance and lubricity, which increases tool life, allows for more hits between sharpening resulting in lower overall tooling costs.



Ultima® Premium Tool Steel sets a new benchmark for durability and performance. When faced with demanding applications that require long-term wear resistance and toughness, Ultima® excels in dramatically improving tool life and increasing wear resistance. Ultima® can significantly reduce downtime between re-grinds, minimising cracking, chipping and breakages, providing long term gains in productivity and profitability.

Basix A Station	4
Basix B Station	5
HP A Station	6
HP B Station	7
HPX A Station	8
HPX B Station	9
Basix Heavy Duty A & B Stations	10
HP Heavy Duty A & B Stations	11
EXP A Station	12
EXP B Station	13
Wilson Standard C Station	14
Wilson Standard D Station	15
Wilson Standard E Station	16
HP C Station	17
HP D Station	18
HP E Station	19
Add On for Non-Standard Features	20
Dura-Blade D Station	21
Dura-Blade E Station	22
Dura-Die	23
Close to Clamps Tooling	24
Non-Standard Keying	25
Shear Options	26
Shims	27
HP Notcher Stripper Plate	28

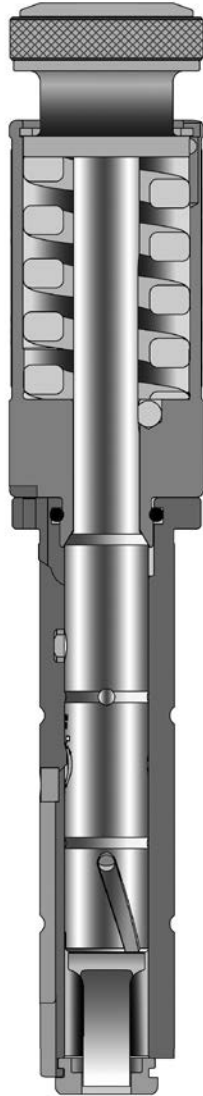

DESCRIPTION		HPX	
		CAT. NO.	PRICE
PUNCH & GUIDE ASSEMBLY Includes guide assembly, punch and stripper	Round	14026	
	Shape Optima® Coating	14012 -	
GUIDE ASSEMBLY Guide assembly only. Punch and stripper purchased separately, round or shape.		14027	
EXP™ PUNCH	Round	13904	
	Shape Optima® Coating	13905 -	
GUIDE	Round	13073	
	Shape (0°)	13074	
	Shape (0° & 45°)	13075	
	Shape (0° & 90°)	13076	
STRIPPER	Round	13045	
	Shape	13152	
DIE	Round Slug Hugger®*	2192	
	Round Standard	1808	
	Shape Slug Hugger®*	2193	
	Shape Standard	13801	
	Ultima® Add on (Round)	-	
	Ultima® Add on (Shape)	-	

NOTES:

Max 'A' Dim 12.7mm

Maximum Material Thickness 3.81mm

Compatible with ABS and non-ABS machines

*Slug Hugger® dies must be ordered punch size plus clearance. Size restrictions apply.

Additional charges may apply to non-standard features. See page 20.

For shims see page 27.

STANDARD SHAPES

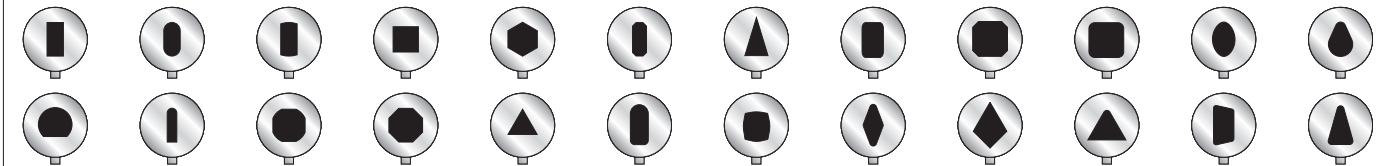

DESCRIPTION		HPX	
		CAT. NO.	PRICE
PUNCH & GUIDE ASSEMBLY Includes guide assembly, punch and stripper	Round	14029	
	Shape Optima® Coating	14018 -	
GUIDE ASSEMBLY Guide assembly only. Punch and stripper purchased separately, round or shape.		14030	
EXP™ PUNCH	Round	13916	
	Shape Optima® Coating	13917 -	
GUIDE	Round	13097	
	Shape (0°)	13098	
	Shape (0° & 45°)	13099	
	Shape (0° & 90°)	13100	
STRIPPER	Round	2433	
	Shape	2432	
DIE	Round Slug Hugger®*	2194	
	Round Standard	2021	
	Shape Slug Hugger®*	2195	
	Shape Standard	13804	
	Ultima® Add on (Round)	-	
	Ultima® Add on (Shape)	-	

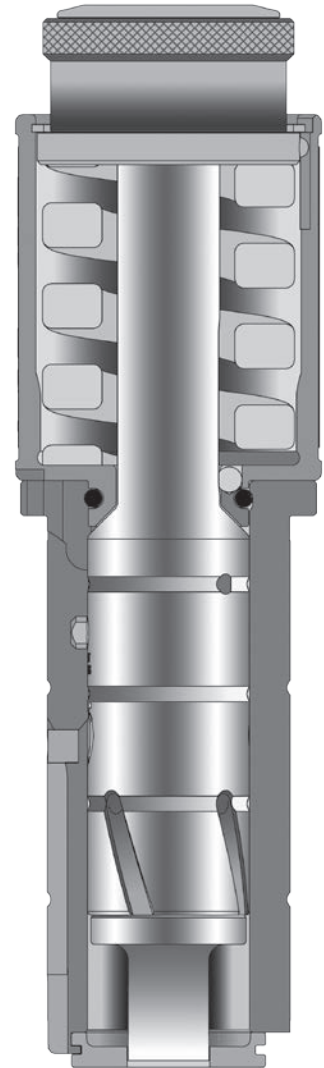

NOTES:

Max 'A' Dim 31.75mm

Maximum Material Thickness 6.35mm

Compatible with ABS and non-ABS machines

*Slug Hugger® dies must be ordered punch size plus clearance. Size restrictions apply.

Additional charges may apply to non-standard features. See page 20.

For shims see page 27.

STANDARD SHAPES											

HP A STATION

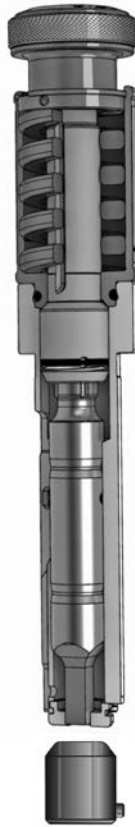

DESCRIPTION		HP SANDARD		HP ABS	
		CAT. NO.	PRICE	CAT. NO.	PRICE
HP PUNCH & GUIDE ASSEMBLY	Round	13767		13770	
	Shape	13769		13772	
	Optima® Coating	-		-	
	Ultima® Add on (Round)	-		-	
	Ultima® Add on (Shape)	-		-	
HP SPRING PACK ASSEMBLY		13735		13735	
PUNCH	Round	2405		2385	
	Shape	2406		2389	
	Optima® Coating	-		-	
	Ultima® Add on (Round)	-		-	
	Ultima® Add on (Shape)	-		-	
GUIDE	Round	2821		2835	
	Shape (0°)	2822		2836	
	Shape (0° & 45°)	2903		2907	
	Shape (0° & 90°)	2904		2908	
STRIPPER	Round	13044		13045	
	Shape	13143		13152	
DIE	Round Slug Hugger®*	2192		2192	
	Round Standard	1808		1808	
	Shape Slug Hugger®*	2193		2193	
	Shape Standard	13801		13801	
	Ultima® Add on (Round)	-		-	
	Ultima® Add on (Shape)	-		-	

NOTES:

Max 'A' Dim 12.7mm

Maximum Material Thickness 3.81mm

*Slug Hugger® dies must be ordered punch size plus clearance.
Size restrictions apply.

Additional charges may apply to non-standard features.
See page 20.

For shims see page 27.

STANDARD SHAPES

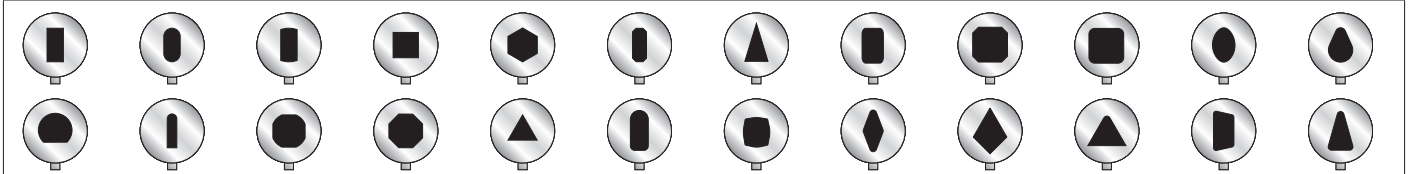

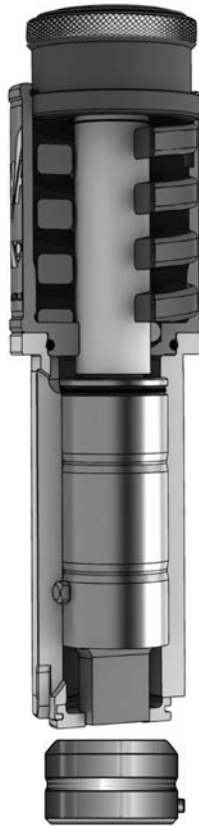

DESCRIPTION		HP STANDARD		HP ABS	
		CAT. NO.	PRICE	CAT. NO.	PRICE
HP PUNCH & GUIDE ASSEMBLY	Round	13779		13782	
	Shape	13781		13784	
	Optima® Coating	-		-	
	Ultima® Add on (Round)	-		-	
	Ultima® Add on (Shape)	-		-	
HP SPRING PACK ASSEMBLY		13729		13729	
PUNCH	Round	2407		2398	
	Shape	2408		2399	
	Optima® Coating	-		-	
	Ultima® Add on (Round)	-		-	
	Ultima® Add on (Shape)	-		-	
GUIDE	Round	2859		2881	
	Shape (0°)	2860		2882	
	Shape (0° & 45°)	2861		2883	
	Shape (0° & 90°)	2862		2884	
STRIPPER	Round	1890		2433	
	Shape	1917		2432	
DIE	Round Slug Hugger®*	2194		2194	
	Round Standard	2021		2021	
	Shape Slug Hugger®*	2195		2195	
	Shape Standard	13804		13804	
	Ultima® Add on (Round)	-		-	
	Ultima® Add on (Shape)	-		-	

NOTES:

Max 'A' Dim 31.75mm

Maximum Material Thickness 6.35mm

*Slug Hugger® dies must be ordered punch size plus clearance. Size restrictions apply.

Additional charges may apply to non-standard features. See page 20.

For shims see page 27.

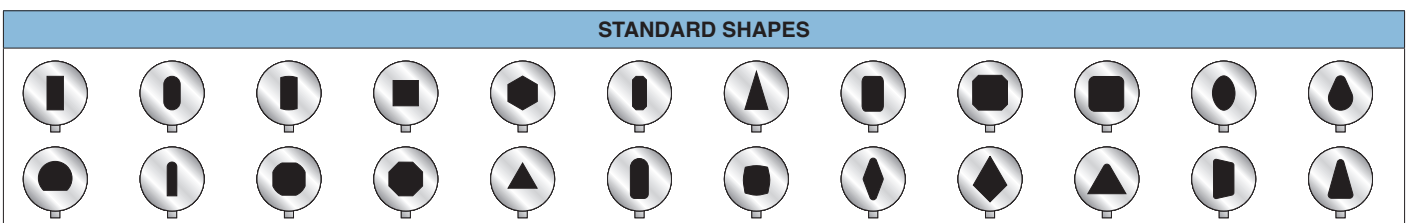

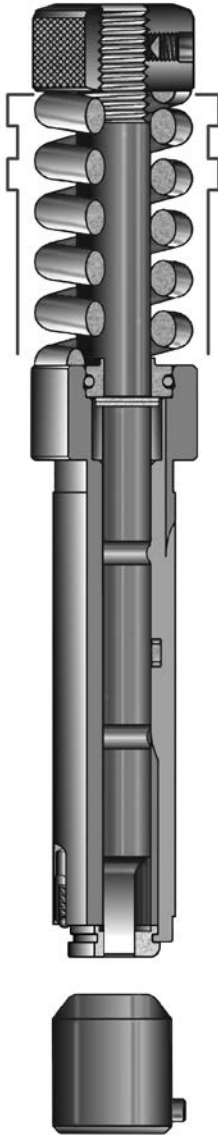

DESCRIPTION		BASIX	
		CAT. NO.	PRICE
PUNCH & GUIDE ASSEMBLY	Round	13453	
	Shape	13455	
	Optima® Coating	-	
PUNCH	Round	1807	
	Shape	1816	
	Optima® Coating	-	
GUIDE	Round	2821	
	Shape (0°)	2822	
	Shape (0° & 45°)	2903	
	Shape (0° & 90°)	2904	
STRIPPER	Round	13044	
	Shape	13143	
DIE	Round Slug Hugger®*	2192	
	Round Standard	1808	
	Shape Slug Hugger®*	2193	
	Shape Standard	13801	
	Ultima® Add on (Round)	-	
	Ultima® Add on (Shape)	-	

NOTES:

Max 'A' Dim 12.7mm

Maximum Material Thickness 3.81mm

*Slug Hugger® dies must be ordered punch size plus clearance.
Size restrictions apply.

Additional charges may apply to non-standard features.
See page 20.

For shims see page 27.

STANDARD SHAPES

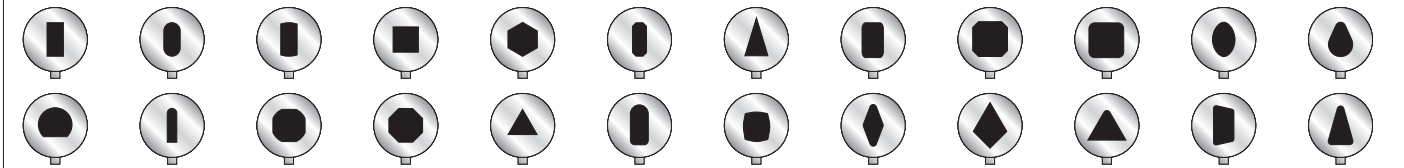

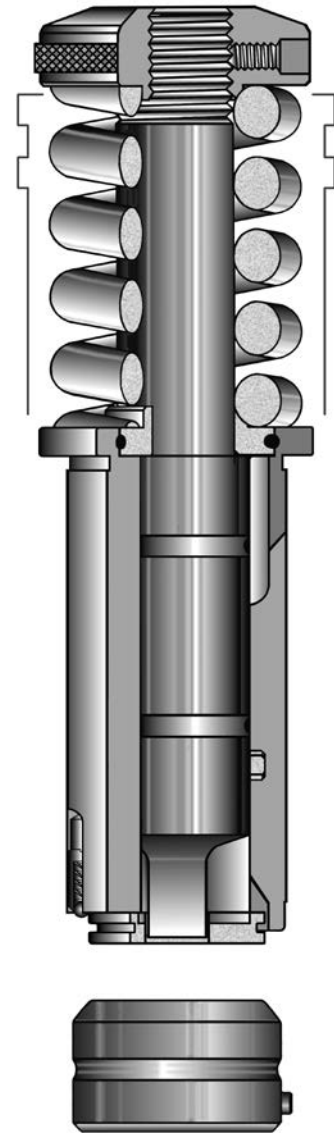

DESCRIPTION		BASIX	
		CAT. NO.	PRICE
PUNCH & GUIDE ASSEMBLY	Round	2851	
	Shape	2853	
	Optima® Coating	-	
PUNCH	Round	1827	
	Shape	1839	
	Optima® Coating	-	
GUIDE	Round	2859	
	Shape (0°)	2860	
	Shape (0° & 45°)	2861	
	Shape (0° & 90°)	2862	
STRIPPER	Round	1890	
	Shape	1917	
DIE	Round Slug Hugger®*	2194	
	Round Standard	2021	
	Shape Slug Hugger®*	2195	
	Shape Standard	13804	
	Ultima® Add on (Round)	-	
	Ultima® Add on (Shape)	-	

NOTES:

Max 'A' Dim 31.75mm

Maximum Material Thickness 6.35mm

*Slug Hugger® dies must be ordered punch size plus clearance.
Size restrictions apply.

Additional charges may apply to non-standard features.
See page 20.

For shims see page 27.

STANDARD SHAPES

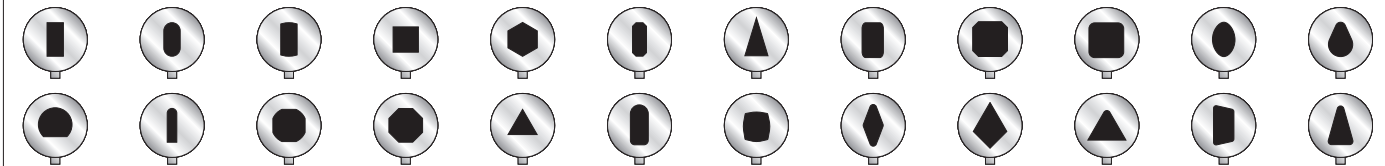

HP HEAVY DUTY A & B STATIONS

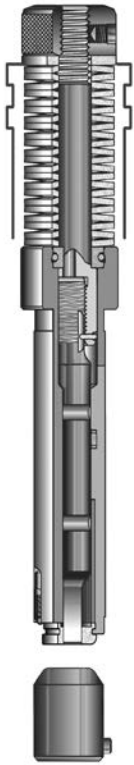

A STATION

NOTES:

Max 'A' Dim 12.7mm

Maximum Material Thickness 6.35mm

*Slug Hugger® dies must be ordered punch size plus clearance. Size restrictions apply.

Additional charges may apply to non-standard features. See page 20.

For shims see page 27.

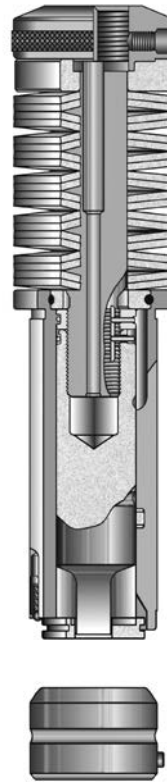

B STATION

NOTES:

Max 'A' Dim 31.75mm

Maximum Material Thickness 7.93mm

*Slug Hugger® dies must be ordered punch size plus clearance. Size restrictions apply.

Additional charges may apply to non-standard features. See page 20.

For shims see page 27.

DESCRIPTION		HP HEAVY DUTY A Station		HP ABS HEAVY DUTY A Station		HP HEAVY DUTY B Station		HP ABS HEAVY DUTY B Station	
		CAT. NO.	PRICE	CAT. NO.	PRICE	CAT. NO.	PRICE	CAT. NO.	PRICE
PUNCH & GUIDE ASSEMBLY	Round	12857		12861		12873		12877	
	Shape	13182		13185		13194		13197	
	Optima® Coating	-		-		-		-	
	Ultima® Add on (Round)	-		-		-		-	
	Ultima® Add on (Shape)	-		-		-		-	
HP PUNCH	Round	2405		2385		2407		2398	
	Shape	2406		2389		2408		2399	
	Optima® Coating	-		-		-		-	
	Ultima® Add on (Round)	-		-		-		-	
	Ultima® Add on (Shape)	-		-		-		-	
GUIDE	Round	2821		2835		2859		2881	
	Shape (0°)	2822		2836		2860		2882	
	Shape (0° & 45°)	2903		2907		2861		2883	
	Shape (0° & 90°)	2904		2908		2862		2884	
	STRIPPER	Round	13044		13045		1890		2433
Shape		13143		13152		1917		2432	
DIE	Round Slug Hugger®*	2192		2192		2194		2194	
	Round Standard	1808		1808		2021		2021	
	Shape Slug Hugger®*	2193		2193		2195		2195	
	Shape Standard	13801		13801		13804		13804	
	Ultima® Add on (Round)	-		-		-		-	
	Ultima® Add on (Shape)	-		-		-		-	

STANDARD SHAPES

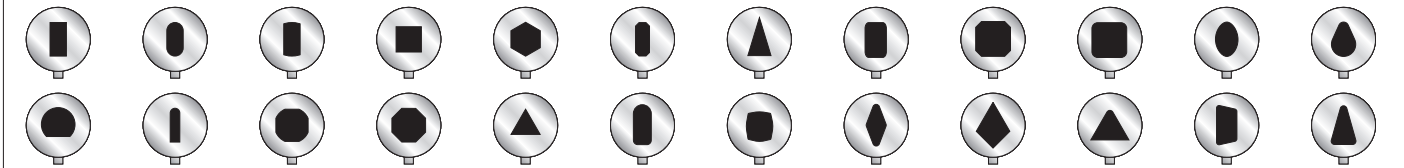

BASIX HEAVY DUTY A & B STATIONS

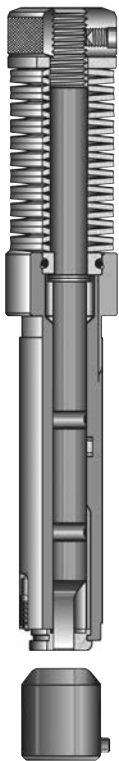

A STATION

NOTES:

Max 'A' Dim 12.7mm

Maximum Material Thickness 6.35mm

*Slug Hugger® dies must be ordered punch size plus clearance. Size restrictions apply.

Additional charges may apply to non-standard features. See page 20.

For shims see page 27.

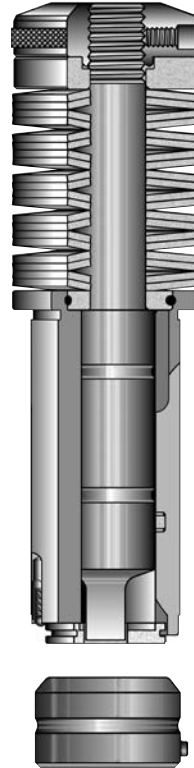

B STATION

NOTES:

Max 'A' Dim 31.75mm

Maximum Material Thickness 7.93mm

*Slug Hugger® dies must be ordered punch size plus clearance. Size restrictions apply.

Additional charges may apply to non-standard features. See page 20.

For shims see page 27.

DESCRIPTION		BASIX HEAVY DUTY	
		CAT. NO.	PRICE
PUNCH & GUIDE ASSEMBLY	Round	2292	
	Shape	2293	
	Optima® Coating	-	
PUNCH	Round	2303	
	Shape	2304	
	Optima® Coating	-	
GUIDE	Round	2821	
	Shape (0°)	2822	
	Shape (0° & 45°)	2903	
	Shape (0° & 90°)	2904	
STRIPPER	Round	13044	
	Shape	13143	
DIE	Round Slug Hugger®*	2192	
	Round Standard	1808	
	Shape Slug Hugger®*	2193	
	Shape Standard	13801	
	Ultima® Add on (Round)	-	
	Ultima® Add on (Shape)	-	

DESCRIPTION		BASIX HEAVY DUTY	
		CAT. NO.	PRICE
PUNCH & GUIDE ASSEMBLY	Round	2298	
	Shape	2299	
	Optima® Coating	-	
PUNCH	Round	2305	
	Shape	2306	
	Optima® Coating	-	
GUIDE	Round	2859	
	Shape (0°)	2860	
	Shape (0° & 45°)	2861	
	Shape (0° & 90°)	2862	
STRIPPER	Round	1890	
	Shape	1917	
DIE	Round Slug Hugger®*	2194	
	Round Standard	2021	
	Shape Slug Hugger®*	2195	
	Shape Standard	13804	
	Ultima® Add on (Round)	-	
	Ultima® Add on (Shape)	-	

STANDARD SHAPES											



HP ROUND PUNCH HOLDER



HP ABS/WLS ROUND PUNCH HOLDER

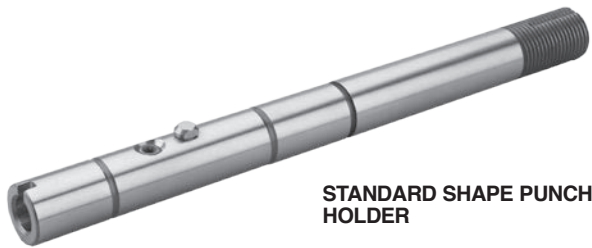

STANDARD SHAPE PUNCH HOLDER

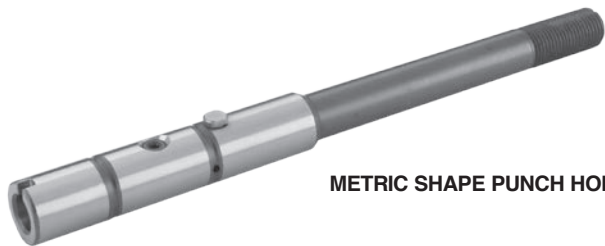

METRIC SHAPE PUNCH HOLDER

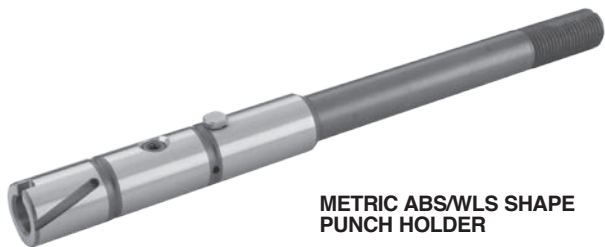

METRIC ABS/WLS SHAPE PUNCH HOLDER



ULTRA PUNCH HOLDER



ROUND PUNCH
Cat. No. 13904

DESCRIPTION		CAT. NO.	PRICE
EXP™ PUNCH	Round	13904	
	Shape	13905	
	Optima® Coating	-	
PUNCH HOLDER	HP Round	13974	
	HP Shape	13975	
	HP ABS Round	13976	
	HP ABS Shape	13906	
	Standard Round	13977	
	Standard Shape	13947	
	Metric Round	13978	
	Metric Shape	13979	
	Metric ABS Round	13980	
	Metric ABS Shape	14024	
	Ultra	15535	

DESCRIPTION		CAT. NO.	PRICE
EXP™ PUNCH	Round	13916	
	Shape	13917	
	Optima® Coating	-	
PUNCH HOLDER	HP Round	13988	
	HP Shape	13989	
	HP ABS Round	13990	
	HP ABS Shape	13918	
	Standard Round	13991	
	Standard Shape	13972	
	Metric Round	13992	
	Metric Shape	13993	
	Metric ABS Round	13994	
	Metric ABS Shape	14025	
Ultra	15537		



HP SHAPE PUNCH HOLDER



HP ABS/WLS SHAPE PUNCH HOLDER

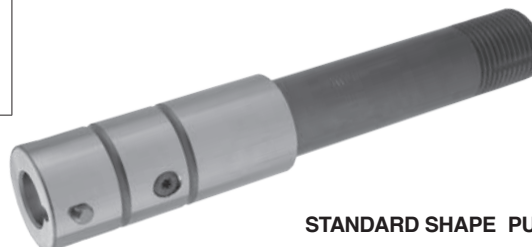

STANDARD SHAPE PUNCH HOLDER

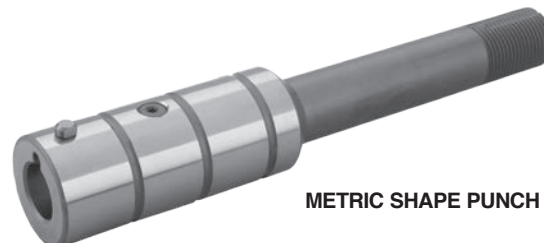

METRIC SHAPE PUNCH HOLDER

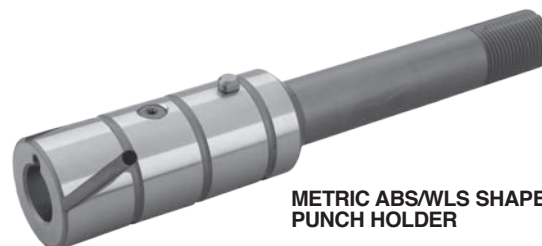

METRIC ABS/WLS SHAPE PUNCH HOLDER



ULTRA PUNCH HOLDER



PUNCH SHAPE
Cat. No. 13917



HP C STATION

With push button stripper retention

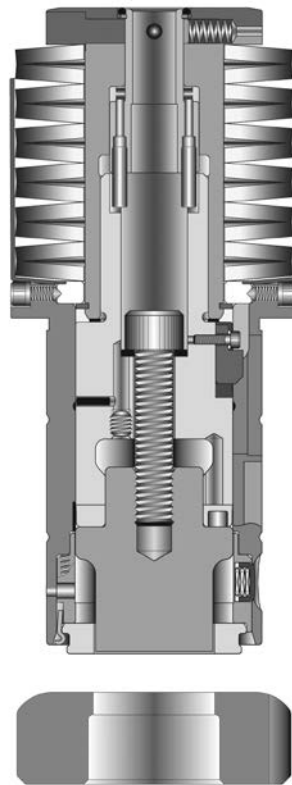

DESCRIPTION		HP		HP ABS	
		CAT. NO.	PRICE	CAT. NO.	PRICE
GUIDE ASSEMBLY		5552		5508	
PUNCH	Round	5026		5026	
	Shape	5025		5025	
	Optima® Coating	-		-	
	Ultima® Add on (Round)	-		-	
	Ultima® Add on (Shape)	-		-	
STRIPPER	Round	1848		5150	
	Shape	1854		5151	
DIE	Round Slug Hugger®*	2196		2196	
	Round Standard	1850		1850	
	Shape Slug Hugger®*	2197		2197	
	Shape Standard	13807		13807	
	Ultima® Add on (Round)	-		-	
	Ultima® Add on (Shape)	-		-	

NOTES:

Max 'A' Dim 50.8mm

Max Material 6.35mm

HP™ Guide Assys. are keyed for shapes at 0°, 45°, 90°, 180°, 225°, 270°.

All punches will be shipped with no shear unless specified.

For HP™ Station Add ons go to page 20.

* Slug Hugger® dies must be ordered punch size plus clearance. Size restrictions apply.

For shims see page 27.

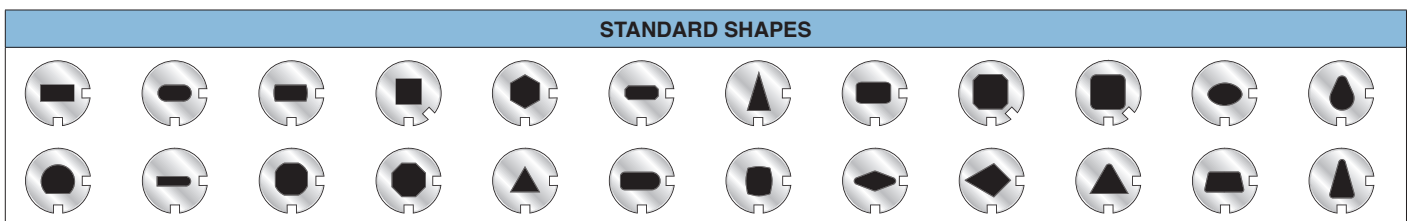

With push button stripper retention

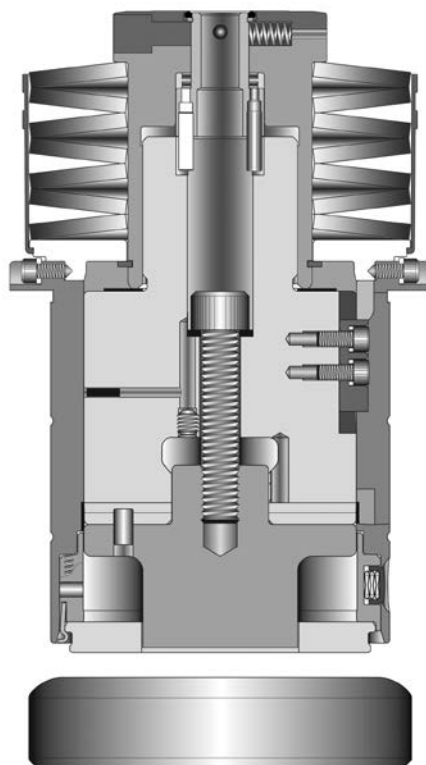

DESCRIPTION		HP		HP ABS	
		CAT. NO.	PRICE	CAT. NO.	PRICE
GUIDE ASSEMBLY		5553		5523	
PUNCH	Round	5028		5028	
	Shape	5027		5027	
	Optima® Coating	-		-	
	Ultima® Add on (Round)	-		-	
	Ultima® Add on (Shape)	-		-	
STRIPPER	Round	1864		5152	
	Shape	1869		5153	
DIE	Round Slug Hugger®*	2198		2198	
	Round Standard	1865		1865	
	Shape Slug Hugger® *	2199		2199	
	Shape Standard	13810		13810	
	Ultima® Add on (Round)	-		-	
	Ultima® Add on (Shape)	-		-	

NOTES:

Max 'A' Dim 88.9mm
 Max material 6.35mm
 HP™ Guide Assys. are keyed for shapes at 0°, 45°, 90°, 180°, 225°, 270°.
 1.6mm Rooftop shear is given to all punches with 'A' dimension† greater than 50.8mm, and width greater than 6.35mm, at no extra charge.
 All punches 6.35mm and under in width will be shipped with no shear unless specified.
 For HP™ Station Add ons go to page 20.
 *Slug Hugger® dies must be ordered punch size plus clearance. Size restrictions apply.
 For shims see page 27.

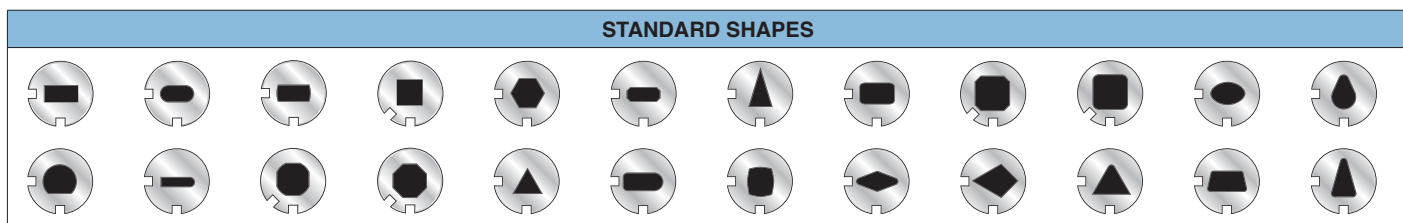

With push button stripper retention

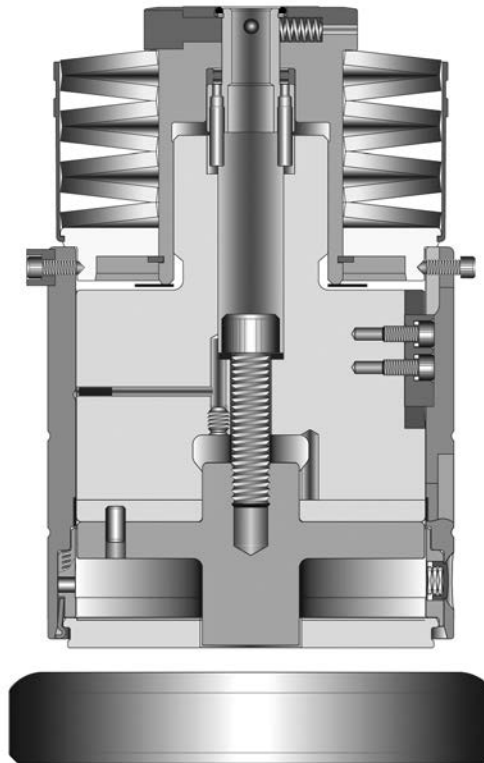

DESCRIPTION		HP		HP ABS	
		CAT. NO.	PRICE	CAT. NO.	PRICE
GUIDE ASSEMBLY		5554		5533	
PUNCH	Round	5030		5030	
	Shape	5029		5029	
	Optima® Coating	-		-	
	Ultima® Add on (Round)	-		-	
	Ultima® Add on (Shape)	-		-	
STRIPPER	Round	1877		5154	
	Shape	1882		5155	
DIE	Round Slug Hugger®*	2200		2200	
	Round Standard	1878		1878	
	Shape Slug Hugger® *	2201		2201	
	Shape Standard	13817		13817	
	Ultima® Add on (Round)	-		-	
	Ultima® Add on (Shape)	-		-	

NOTES:

Max 'A' Dim 114.3mm
 Max Material 6.35mm
 HP™ Guide Assys. are keyed for shapes at 0°, 45°, 90°, 180°, 225°, 270°.
 1.6mm Rooftop shear is given to all punches with 'A' dimension† greater than 50.8mm, and width greater than 6.35mm, at no extra charge.
 All punches 6.35mm and under in width will be shipped with no shear unless specified.
 For HP™ Station Add ons go to page 20.
 * Slug Hugger® dies must be ordered punch size plus clearance. Size restrictions apply.
 For shims see page 27.

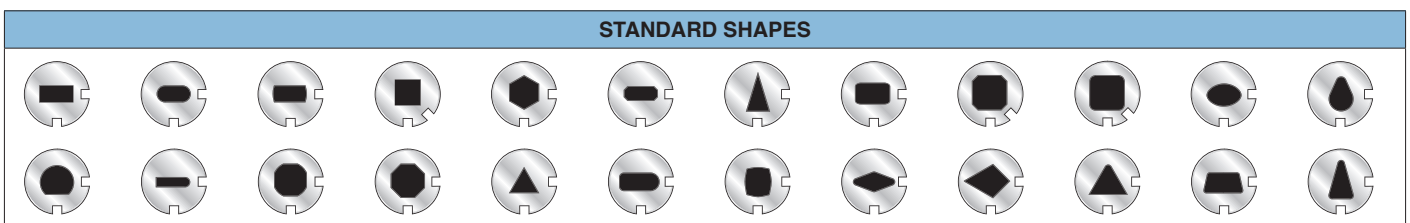

WILSON STANDARD C STATION

Stripper retained with wire lock ring or stripper clips

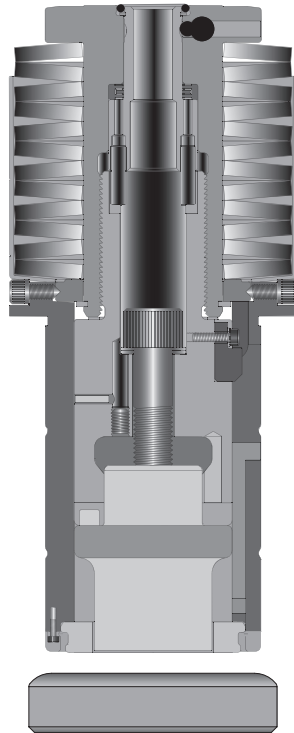

DESCRIPTION		WILSON	
		CAT. NO.	PRICE
GUIDE ASSEMBLY	Standard	5586	
	Standard (LVD)	35194	
	Standard WLS®	5595	
	Standard WLS® (LVD)	35195	
PUNCH	Round	5026	
	Shape	5025	
	Optima® Coating	-	
	Ultima® Add on (Round)	-	
	Ultima® Add on (Shape)	-	
STRIPPER	Round	1848	
	Shape	1854	
DIE	Round Slug Hugger®*	2196	
	Round Standard	1850	
	Shape Slug Hugger®*	2197	
	Shape Standard	13807	
	Ultima® Add on (Round)	-	
	Ultima® Add on (Shape)	-	

NOTES:

Max 'A' Dim 50.8mm

Max Material 6.35mm

Standard Guide Assys. are keyed for shapes at 0°, 90°, 225°.

All punches will be shipped with no shear unless specified.

For Add ons go to page 20.

* Slug Hugger® dies must be ordered punch size plus clearance. Size restrictions apply.

For shims see page 27.

STANDARD SHAPES

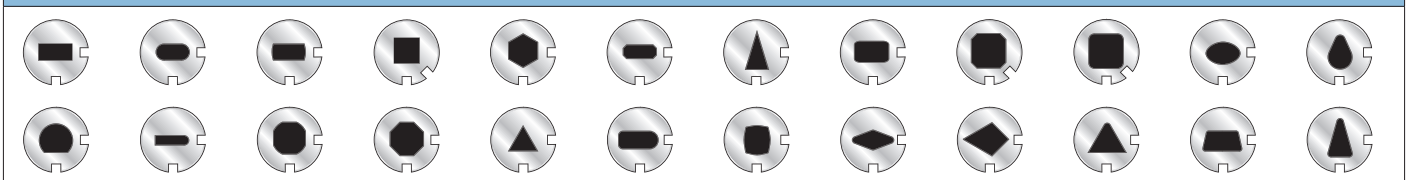

WILSON STANDARD D STATION

Stripper retained with wire lock ring or stripper clips

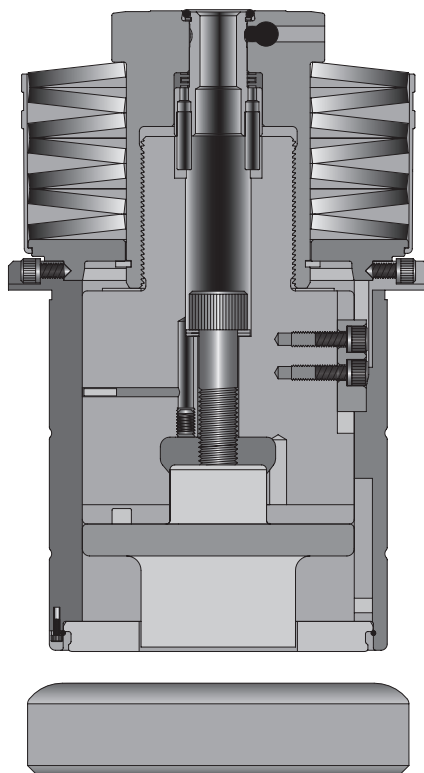

DESCRIPTION		WILSON	
		CAT. NO.	PRICE
GUIDE ASSEMBLY	Standard	5587	
	Standard (LVD)	35201	
	Standard WLS®	5596	
	Standard WLS® (LVD)	35202	
PUNCH	Round	5028	
	Shape	5027	
	Optima® Coating	-	
	Ultima® Add on (Round)	-	
	Ultima® Add on (Shape)	-	
STRIPPER	Round	1864	
	Shape	1869	
DIE	Round Slug Hugger®*	2198	
	Round Standard	1865	
	Shape Slug Hugger®*	2199	
	Shape Standard	13810	
	Ultima® Add on (Round)	-	
	Ultima® Add on (Shape)	-	

NOTES:

Max 'A' Dim 88.9mm

Max Material 6.35mm

Standard Guide Assys. are keyed for shapes at 0°, 90°, 225°.

1.6mm Rooftop shear is given to all punches with 'A' dimension[†] greater than 50.8mm, and width greater than 6.35mm, at no extra charge.

For Add ons go to page 20.

* Slug Hugger® dies must be ordered punch size plus clearance. Size restrictions apply.

For shims see page 27.

STANDARD SHAPES

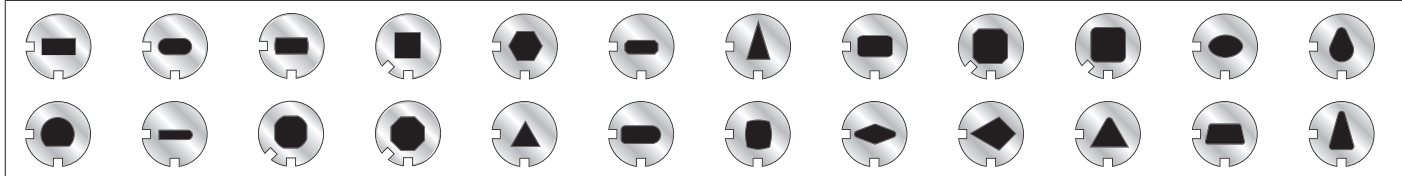

WILSON STANDARD E STATION

Stripper retained with wire lock ring or stripper clips

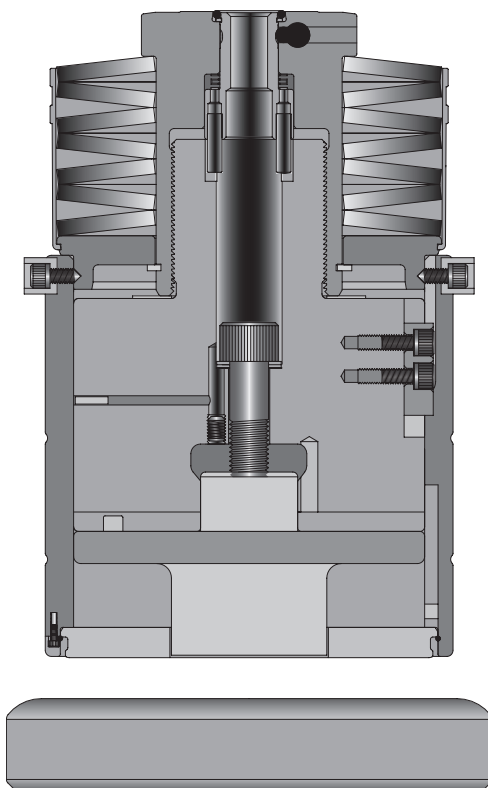

DESCRIPTION		WILSON	
		CAT. NO.	PRICE
GUIDE ASSEMBLY	Standard	5588	
	Standard (LVD)	35205	
	Standard WLS®	5597	
	Standard WLS® (LVD)	35207	
PUNCH	Round	5030	
	Shape	5029	
	Optima® Coating	-	
	Ultima® Add on (Round)	-	
STRIPPER	Round	1877	
	Shape	1882	
DIE	Round Slug Hugger®*	2200	
	Round Standard	1878	
	Shape Slug Hugger®*	2201	
	Shape Standard	13817	
	Ultima® Add on (Round)	-	
	Ultima® Add on (Shape)	-	

NOTES:

Max 'A' Dim 114.3mm

Max Material 6.35mm

Standard Guide Assys. are keyed for shapes at 0°, 90°, 225°.

1.6mm Rooftop shear is given to all punches with 'A' dimension† greater than 50.8mm, and width greater than 6.35mm, at no extra charge.

For Add ons go to page 20.

* Slug Hugger® dies must be ordered punch size plus clearance. Size restrictions apply.

For shims see page 27.

STANDARD SHAPES

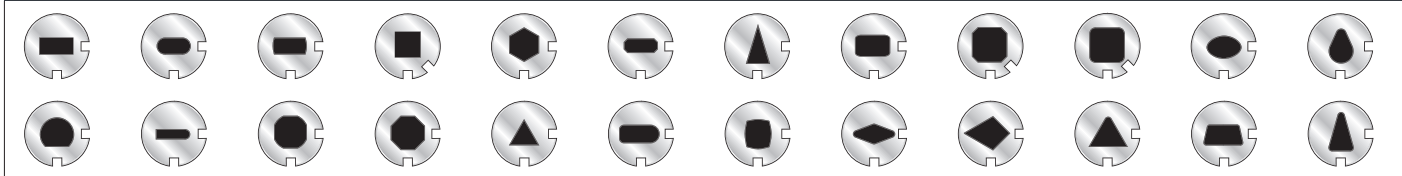

ADD ON CHARGES FOR NON-STANDARD FEATURES

A Station & Multi-Tool Add Ons			
Add ons for Rounds			
Small Diameter	Punch	Die	Stripper
0.79 - 1.50mm Clearance < 0.10mm			N/C N/C
Add ons for Shapes			
Small Width	Punch	Die	Stripper
0.79 - 1.00mm Clearance < 0.10mm			N/C

B Station Add Ons			
Add ons for Rounds			
Small Diameter	Punch	Die	Stripper
0.79 - 1.50mm Clearance < 0.10mm			N/C N/C
Add ons for Shapes			
Small Width	Punch	Die	Stripper
0.79 - 1.00mm Clearance < 0.10mm			N/C

C Station Add Ons			
Add ons for Rounds			
Small Diameter	Punch	Die	Stripper
< 25.4mm Clearance < 0.10mm		N/C	N/C N/C
Add ons for Shapes			
Small Width	Punch	Die	Stripper
0.79 - 1.0mm			
Small 'A' Dimension†			
< 29.21mm 29.22 - 31.72mm Clearance < 0.10mm		N/C N/C	N/C N/C N/C

D Station Add Ons			
Add ons for Rounds			
Small Diameter	Punch	Die	Stripper
< 48.26mm 48.27 - 50.77mm Clearance < 0.10mm		N/C N/C	N/C N/C N/C
Add ons for Shapes			
Small Width	Punch	Die	Stripper
0.79 - 1.0mm			
Small 'A' Dimension†			
< 48.26mm 48.27 - 50.77 Clearance < 0.10mm		N/C N/C	N/C N/C N/C

E Station Add Ons			
Add ons for Rounds			
Small Diameter	Punch	Die	Stripper
< 86.36mm 86.37 - 88.87mm Clearance < 0.10mm		N/C N/C	N/C N/C N/C
Add ons for Shapes			
Small Width	Punch	Die	Stripper
0.79 - 1.0mm			
Small 'A' Dimension†			
< 86.36mm 86.37 - 88.87mm Clearance < 0.10mm		N/C N/C	N/C N/C N/C

NOTES:

- Add to round or shape punch for extra straight before radius, extra back taper, or no back taper.

† 'A' Dimension = Longest distance across shape.

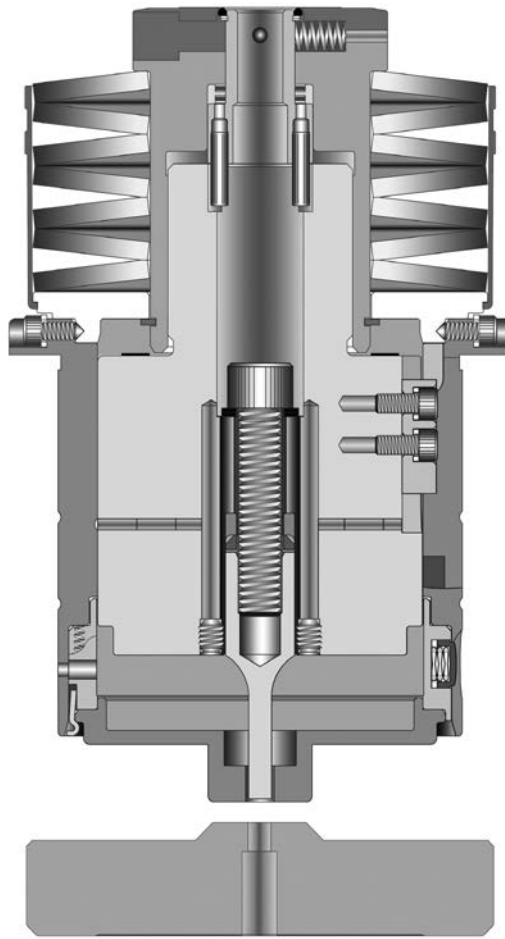

Maximum Material Thickness 6.35mm

DESCRIPTION		HP		HP ABS	
		CAT. NO.	PRICE	CAT. NO.	PRICE
GUIDE ASSEMBLY		5663		5653	
PUNCH	Blade Optima® Coating	5657 -		5657 -	
STRIPPER	One Sided Relief Two Sided Relief	5665 5656		5666 5664	
DIE - for die options see page 24					

NOTES:

HP™ Dura Blade™ Guide Assys. are keyed for shapes at 0°, 45°, 90°.

Ultima® Premium Tool Steel is standard on punch blades.

Maximum width for blade insert is 19.05mm.

For shims see page 23.

DURA-BLADE E STATION

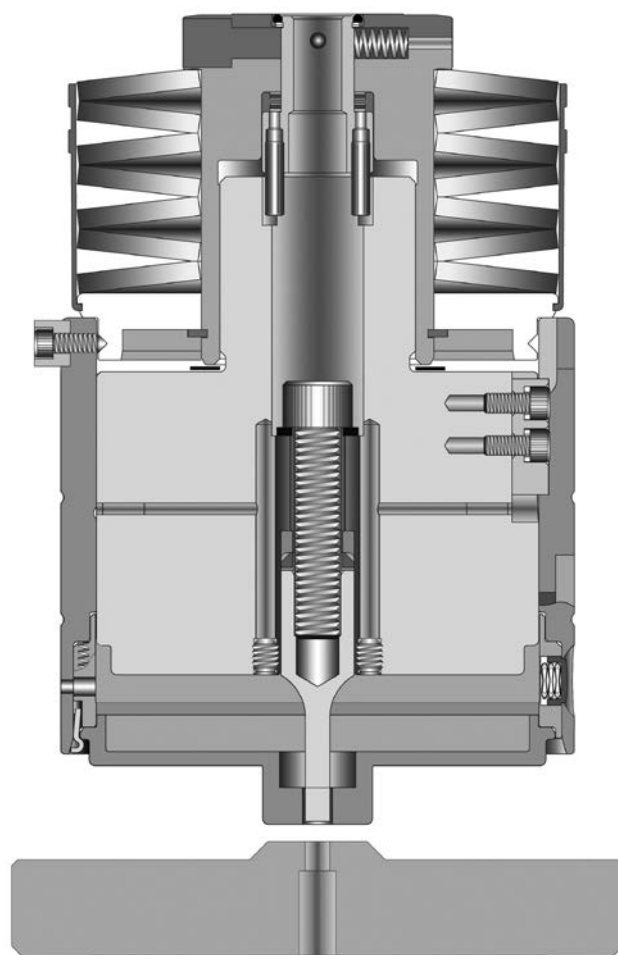

Maximum Material Thickness 6.35mm

DESCRIPTION		HP		HP ABS	
		CAT. NO.	PRICE	CAT. NO.	PRICE
GUIDE ASSEMBLY		5639		5626	
PUNCH	Blade Optima® Coating	5630 -		5630 -	
STRIPPER	One Sided Relief	5641		5642	
	Two Sided Relief	5629		5640	
DIE - for die options see page 24					

NOTES:

HP™ Dura Blade™ Guide Assys. are keyed for shapes at 0° and 90°.

Ultima® Premium Tool Steel is standard on punch blades.

Maximum width for blade insert is 19.05mm.

For shims see page 23.

C Station Slitting



D Station Slitting



D Station Close to Clamps



E Station Slitting



E Station Close to Clamps

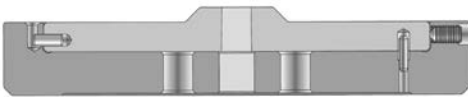

DESCRIPTION	CAT. NO.	PRICE	SIZE LIMITATIONS
C Station Slitting Dura-Die			
Insert - Positive	12991		Max length = 51mm Max width = 7mm
Insert - Slug Hugger 2	12992		
Shim Pack	12995		
*Die Base Assy	12989		
D Station Slitting Dura-Die			
Insert - Positive	13008		Max length = 86mm Max width = 7mm
Insert - Slug Hugger 2	13009		
Shim Pack	13012		
*Die Base Assy	13006		
D Station Close-to-Clamp Slitting Dura-Die			
Insert - Positive (relief 2 sides)	13281		Max length = 81mm Max width = 7mm
Insert - Slug Hugger 2 (relief 2 sides)	13282		
Die Base Assy @ 0&90	13276		
E Station Slitting Dura-Die			
Insert - Positive	13013		Max length = 111.8mm Max width = 11mm
Insert - Slug Hugger 2	13014		
Shim Pack	13017		
*Die Base Assy	13015		
E Station Close-to-Clamp Slitting Dura-Die			
Insert - Positive (relief 2 sides)	13289		Max length = 111.8mm Max width = 11mm
Insert - SlugHugger 2 (relief 2 sides)	13290		
Die Base Assy @ 0&90	13284		
*All die assemblies include the die base and knock out tool. These assemblies also include shim pack. Insert ordered seperately.			

CLOSE TO CLAMP TOOLING



D STATION		
DESCRIPTION	CAT. NO.	PRICE
PUNCH		
Thin Clamps	5027	
Thick Clamps	5114	
STRIPPER		
Thin Clamps	5100	
Thick Clamps	5115	
DIE		
Slug Hugger®† (relief 2 sides, shp at 90°)	5157	
Slug Hugger®† (relief 2 sides, shp at 0°-90°)	5330	
Slug Hugger®† (relief 1 side, shp at 90°)	2464	
Slug Hugger®† (relief 1 side, shp at 0°-90°)	5333	
Standard (relief 2 sides, shp at 90°)	13814	
Standard (relief 2 sides, shp at 0°-90°)	13813	
Standard (relief 1 side, shp at 90°)	13812	
Standard (relief 1 side, shp at 0°-90°)	13811	

E STATION		
DESCRIPTION	CAT. NO.	PRICE
PUNCH		
Thin Clamps	5029	
Thick Clamps	5109	
STRIPPER		
Thin Clamps	5094	
Thick Clamps	5110	
DIE		
Slug Hugger®† (relief 2 sides, shp at 90°)	5159	
Slug Hugger®† (relief 2 sides, shp at 0°-90°)	5340	
Slug Hugger®† (relief 1 side, shp at 90°)	2467	
Slug Hugger®† (relief 1 side, shp at 0°-90°)	5343	
Standard (relief 2 sides, shp at 90°)	13821	
Standard (relief 2 sides, shp at 0°-90°)	13820	
Standard (relief 1 side, shp at 90°)	13819	
Standard (relief 1 side, shp at 0°-90°)	13818	

* Slug Hugger® dies must be ordered punch size plus clearance. Size restrictions apply.

'A' Dimension = Longest distance across shape.

For shims see page 26.

When ordering shapes at non-standard angles, use the diagrams below.

Wilson Tool Keying Diagram

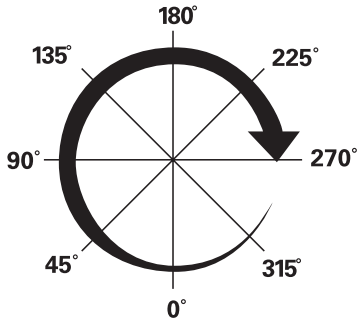

Note: Please refer to non-standard key locations by the following method:

- Example 1 "Shape at 60°"
- Example 2 "Shape at 30°"

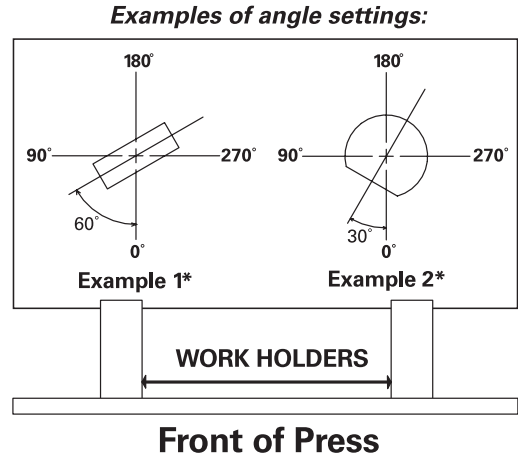

SHAPE at single angles other than standard			
Station	Punch	Die	Guide or Stripper
A	N/C		No Charge
B			Not Applicable
C			Not Applicable
D			Not Applicable
E			Not Applicable

NOTE: No additional charge on A & B stations for shape at 45° increments)

STANDARD keying, plus extra pins or keys for shapes at other than 45° increments			
Station	Punch	Die	Guide or Stripper
A	N/A	N/A	N/A
B	N/A	N/A	
C			
D			
E			

Die View

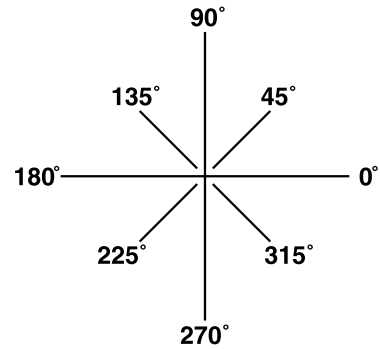



Front of Press

This key location matches Amada's® turret punch press programming method.

STANDARD keying, plus extra pins or keys for shapes at 45° increments					
Station	Punch		Die		Guide or Stripper
	Available Options	Add On Price	Available Options	Add On Price	
A	N/A	N/A	N/A	N/A	N/A
B	0° & 45°		0° & 45°		
C	0° & 180°		0° & 180°		
D	45° increments		45° increments		
E	45° increments		45° increments		

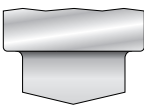
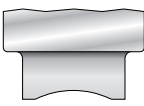
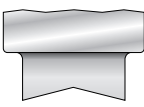
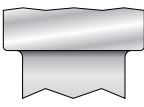
SHEAR OPTIONS

TYPE OF SHEAR	BENEFIT	LIMITATION
 Rooftop	Best shear for punching at maximum tonnages.	When nibbling, bite must be 75% of punch dimension or excessive side loading will result.
 Concave or Double Concave	Best shear for nibbling because it inverts stresses.	The punch is less resistant to breakage when punching at high tonnages because of inverted stresses.
 Inverted Rooftop	Also good shear for nibbling because it inverts stresses.	More susceptible to breakage because of a sharp focal point for stresses - use great care.
 Double Valley Shear	Best shear for nibbling when shape is long and narrow.	The punch is less resistant to breakage when punching at high tonnages because of inverted stresses.
 JK Shear	A special punch tip shear that allows you to punch high strength materials with a reduced risk of breakage.	Can only be used on punches up to 25.4mm diameter or 'A' dimension†.

SPECIAL SHEARS					
Station	'A' Dimensions †	Inverted Rooftop Single Concave		Double Valley Double Concave	
		Shear 1.6mm	Shear 3.2mm	Shear 1.6mm	Shear 3.2mm
B	Within 31.75mm		N/A		N/A
C	Within 50.8mm				
D	Within 88.9mm				
E	Within 114.3mm				

1.6mm rooftop shear is given to all punches with 'A' dimension† greater than 50.8mm and width greater than 6.35mm at no extra charge.
All punches 6.35mm and under in width will be shipped with no shear unless specified.

†'A' Dimension = Longest distance across shape.

NOTE: In some instances, inverted rooftop is substituted for single and double concave shears.

JK Shear	
Shape	Add On Price
Round	
Rectangle, Square, Hexagon, Single 'D', Double 'D'	
Obround	

NOTE: If specified: 3.2mm maximum rooftop shear can be given at N/C for any round or shape in C, D, E or F stations. For rooftop shear on any round or shape in A or B stations, add

DIE CLEARANCE SELECTION INFORMATION			
Total Clearance			
Material	Minimum	Best	Maximum
Copper, 1/2 Hard	8 %	12 %	16 %
Brass, 1/2 Hard	6 %	11 %	16 %
Mild Steel	10 %	15 %	20 %
Steel 0.50C	12 %	18 %	24 %
Aluminum, Soft	5 %	10 %	15 %
Stainless Steel	15 %	20 %	25 %

% x Material Thickness = Total Clearance

PUNCH SHIMS, DIE SHIMS AND SLUG EJECTORS

DIE SHIMS			
STATION	QUANTITY	CAT. NO.	PRICE
0.25mm Thick - Individually			
12.7mm (A)	1	2101	
31.75mm (B)	1	2097	
50.8mm (C)	1	2089	
88.9mm (D)	1	2081	
114.3mm (E)	1	2073	
0.25mm Thick - Package			
12.7mm(A)	25	2208	
31.75mm(B)	25	2209	
50.8mm(C)	10	2210	
88.9mm(D)	5	2211	
114.3mm(E)	5	2212	
0.75mm Thick - Individually			
12.7mm(A)	1	2721	
31.75mm(B)	1	2723	
50.8mm(C)	1	2725	
88.9mm(D)	1	2727	
114.3mm(E)	1	2729	
0.75mm Thick - Package			
12.7 mm(A)	25	2722	
31.75 mm(B)	25	2724	
50.8 mm(C)	10	2726	
88.9 mm(D)	5	2728	
114.3 mm(E)	5	2730	
1.5mm Thick - Individual			
12.7 mm(A)	1	2104	
31.75 mm(B)	1	2100	
50.8 mm(C)	1	2092	
88.9 mm(D)	1	2084	
114.3 mm(E)	1	2076	
1.5mm Thick - Package			
12.7 mm(A)	25	2172	
31.75 mm(B)	25	2173	
50.8 mm(C)	10	2174	
88.9 mm(D)	5	2175	
114.3 mm(E)	5	2176	

PUNCH SHIMS			
STATION	QUANTITY	CAT. NO.	PRICE
Individually			
12.7mm (A)	1	13080	
31.75mm (B)	1	152	
50.8mm (C)	1	2096	
88.9mm (D)	1	2088	
114.3mm (E)	1	2080	
Package			
31.75mm (B)	25	98	
50.8mm (C)	10	2169	
88.9mm (D)	5	2170	
114.3mm (E)	5	2171	

SLUG EJECTORS			
HOLE DIAMETER IN PUNCH	QUANTITY	CAT. NO.	PRICE
Square Urethane			
3.2mm	50	6116	
3.8mm	50	6117	
9.5mm	50	6118	
12.7mm	50	6119	
Assortment	50	6410	

HP NOTCHER STRIPPER PLATE

The Notcher Stripper Plate is:

- Hardened tool steel stripper plate.
- Precision ground to exacting tolerances.
- Uniquely designed to give the rigidity and slip fit of a special Notching Unit.

What does this mean to you?

- Better guiding, less tool deflection.
- Greater flexibility of tooling applications.
- Longer tool life.
- Standard punch can be used.

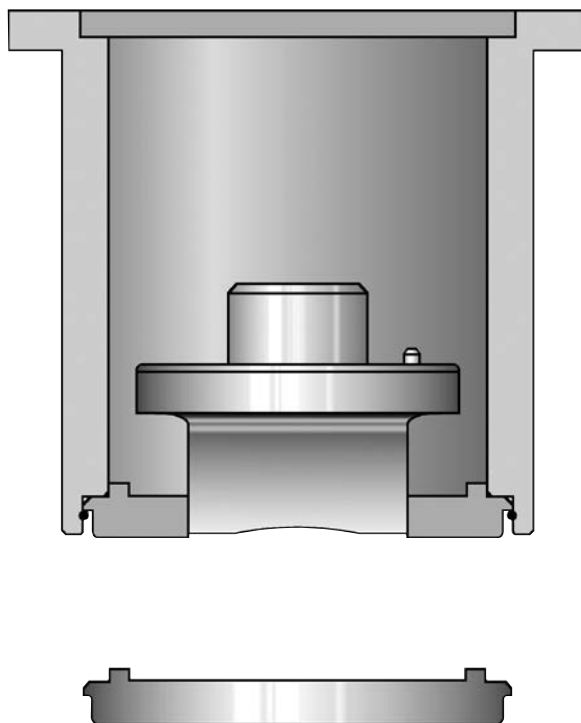

STATION	MAX Punch 'A' Dimension	SHAPE	HP		HP ABS		S-90		S-90 ABS	
			CAT. NO.	PRICE	CAT. NO.	PRICE	CAT. NO.	PRICE	CAT. NO.	PRICE
C	50.8mm	Round	2469		5643		5067		5453	
		Shape	2470		5644		5068		5454	
D	88.9mm	Round	2471		5645		5069		5455	
		Shape	2472		5646		5070		5456	
E	114.3mm	Round	2473		5647		5071		5457	
		Shape	2474		5648		5072		5458	

NOTES:

Designed to fit Wilson Tool manufactured guide assemblies only.

For larger sizes, please contact our sales desk.

'A' Dimension = Longest distance across shape. min. total clearance (patented).

For Series 90 Notcher Strippers, please consult our salesdesk.

Wilson Tool International (Europe) Ltd. - United Kingdom
Stirling Road, South Marston Industrial Estate,
Swindon, Wiltshire, SN3 4TQ, United Kingdom
Tel (Free): 0800 373 748 | Tel: +44 1793 831818
Fax (Free): 0800 373 758 | Fax: +44 1793 831945 or 46
Email: sales@wilsontool.eu.com

Wilson Tool International, Inc. - United States
Tel (Free): 800-328-9646 | Tel: 651-286-6001
Fax (Free): 800-222-0002 | Fax: 651-286-5959
Email: sales@wilsontool.com

Wilson Tool International - China
Tel: +86 21 51089638 | Fax: +86 21 64422195
Email: sales@wilsontool.cn

Wilson Tool International (Europe) Ltd. - Germany
Tel (Free): 00800-9457668665 | Tel: +49 5723 747 0
Fax (Free): 00800-945766329 | Fax: +49 5723 747 10
Email: verkauf@wilsontool.eu.com

Wilson Tool International A/S - Denmark
Tel (Free): 80 20 20 24 | Tel: +45 44 53 1699
Fax (Free): 80 20 20 26 | Fax: +45 44 53 0607
Email: sales@wilsontool.dk

Wilson Tool International (Europe) Ltd. - France
Tel: +33 (0) 164 13 47 80 | Fax: +33 (0) 164 13 47 81
Email: ventes@wilsontool.eu.com

Wilson Tool International - Argentina
Tel: +54 114 7634004 | Fax: +54 114 5084190
Email: ventasargentina@wilsontool.com

Wilson Tool - South Africa (Pty) Limited
Tel: +27 877 217 875 | Fax: 086 657 8629
Email: simon.penney@wilsontool.com

The Wilson Tool Company S. de R.L. de C.V. - Mexico
Tel: 52 (81) 8865-4820 | Fax: 52 (81) 8865-4599
Email: americalatina@wilsontool.com

Wilson Tool Canada
Punching & Stamping Division
Tel: 800-268-5573 | Fax: 800-668-9314
Email: punching@wilsontoolcanada.com

Wilson Tool Canada
Press Brake Division
Tel: 800-268-4180 | Fax: 905-840-1032
Email: bending@wilsontoolcanada.com

Distributor:
S.C. SM TECH S.R.L.
www.sm-tech.ro
office @ sm-tech.ro
Tel: 0331-401599
Tel : 0745-528494
Fax: 0374-091010