

SOLUTII DE ELIMINARE SAU REDUCERE A URMELOR LASATE PE MATERIAL LA INDOIREA PE ABKANT



ROLLERI MARK FREE BENDING

Distribuitor:
S.C. SM TECH S.R.L.
www.sm-tech.ro
office @ sm-tech.ro
Tel: 0374-991480
Tel mob: 0745-528494

Cuprins :

	Pag:
ROLL PRIME	1
ROLFILM	2
Tensioner	2
Bending Foil	2
POLYURETHANE	
Inserts and holders	2-3
Cover plate and modifications	3
SYNTHETIC DIES	4
Inserts and holders	4

Rolleri's constant research for innovation brought us towards the 3D printing world, the future of manufacturing. Roll Prime is the solution for applications which require mark-free sheet metal, reduced delivery time and dimensional precision: thanks to FDM technology (Fused Deposition Modelling) we are able to produce tools and inserts made of special plastic material, completely adaptable to customer's needs with halved production lead time compared to traditional technology.

- ▶ Totally Mark-free bending
- ▶ Halved production lead time
- ▶ 30-40% lower costs than a classic special tool
- ▶ Ideal for Rapid Prototyping
- ▶ Ideal for small production batches
- ▶ Bending result repeatability
- ▶ Easy handling thanks to 85% lower weight

Tools

Thanks to an infinite choice of shapes, we are able to study specific solutions for every customer, with the possibility of rapid prototyping.

Roll Prime tools are the right solution to produce small batches or samples, as they have between 30% and 40% lower costs and shorter delivery time than conventional tools.

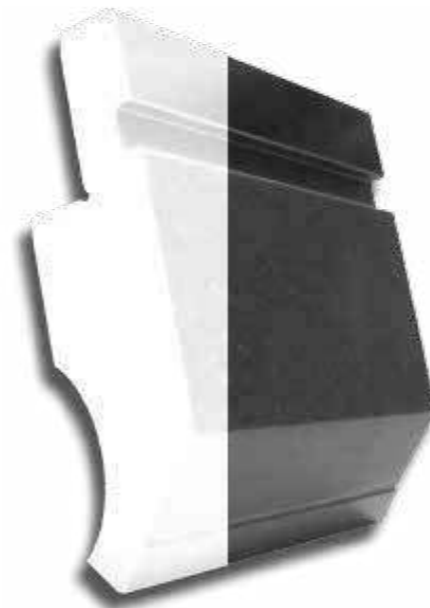

Inserts

Roll Prime inserts are an innovation in mark-free bending: thanks to their special composition they can guarantee total absence of marks on sheet metal, giving repeatable and long-lasting results, removing all the annoying problems of classic bending foils.

With our technology we are able to propose highly customizable solutions, so it is possible to design inserts which are fully adaptable to your tools.



Rolfilm and Tensioner

- ▶ Easy handling
- ▶ Flexible positioning
- ▶ Prevention of bending marks
- ▶ Decrease of post-operations of bent parts
- ▶ Increased product quality.

CT

€ 181,- 6.0 kg Per piece



ROLFILM				
Model	Thickness [mm]	Width [mm]	Length [mm]	Price
Rolfilm 3-0.4-100	0.4	100	3	€ 26,-
Rolfilm 10-0.4-100	0.4	100	10	€ 79,-
Rolfilm 20-0.4-100	0.4	100	20	€ 152,-
Rolfilm 30-0.4-100	0.4	100	30	€ 210,-
Rolfilm 3-0.4-150	0.4	150	3	€ 42,-
Rolfilm 10-0.4-150	0.4	150	10	€ 126,-
Rolfilm 20-0.4-150	0.4	150	20	€ 255,-
Rolfilm 30-0.4-150	0.4	150	30	€ 315,-
Rolfilm 3-0.6-150	0.6	150	3	€ 42,-
Rolfilm 10-0.6-150	0.6	150	10	€ 126,-
Rolfilm 20-0.6-150	0.6	150	20	€ 247,-
Rolfilm 30-0.6-150	0.6	150	30	€ 315,-
Rolfilm 3-0.6-200	0.6	200	3	€ 58,-
Rolfilm 10-0.6-200	0.6	200	10	€ 168,-
Rolfilm 20-0.6-200	0.6	200	20	€ 326,-
Rolfilm 30-0.6-200	0.6	200	30	€ 462,-
Rolfilm 3-2-150	2.0	150	3	€ 74,-
Rolfilm 10-2-150	2.0	150	10	€ 242,-
Rolfilm 20-2-150	2.0	150	20	€ 478,-
Rolfilm 30-2-150	2.0	150	30	€ 683,-



Polyurethane inserts and holders



C45: 560-710 N/mm²

MPG25

835 mm	€ 252,-	18.5 kg
415 mm	€ 147,-	9.2 kg

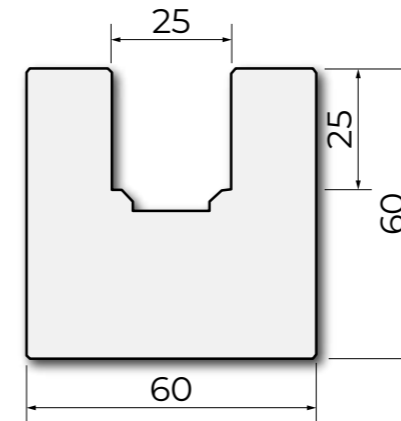

Polyurethane

GM 25X25

835 mm	€ 62,-	0.6 kg
415 mm	€ 35,-	0.3 kg

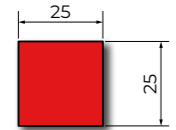

Polyurethane

GM 25X25X10

835 mm	€ 69,-	0.6 kg
415 mm	€ 39,-	0.3 kg

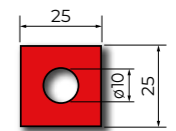

C45: 560-710 N/mm²

MPG50

835 mm	€ 453,-	46.0 kg
415 mm	€ 256,-	22.5 kg

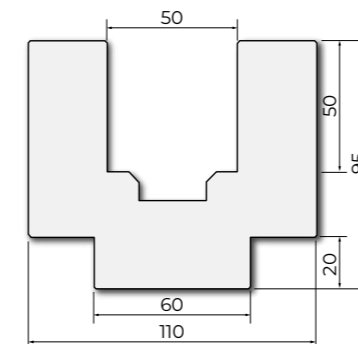

Polyurethane

GM 50X50

835 mm	€ 141,-	2.5 kg
415 mm	€ 79,-	1.2 kg

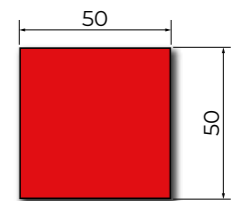

Polyurethane

GM 50X50X25

835 mm	€ 141,-	2.5 kg
415 mm	€ 78,-	1.2 kg

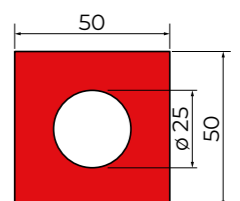

Polyurethane inserts and holders

C45: 560-710 N/mm²

MPG75

835 mm	€ 592,-	46.0 kg
415 mm	€ 336,-	22.5 kg

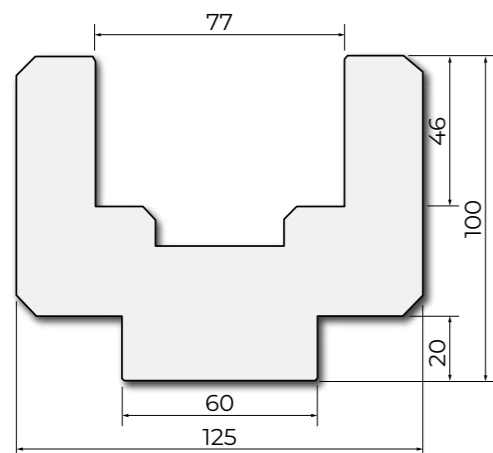

Polyurethane

GM 75X50

835 mm	€ 184,-	3.5 kg
415 mm	€ 102,-	1.7 kg

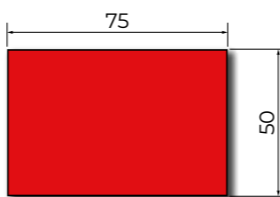

Polyurethane

GM 75X50X20

835 mm	€ 268,-	3.5 kg
415 mm	€ 148,-	1.7 kg

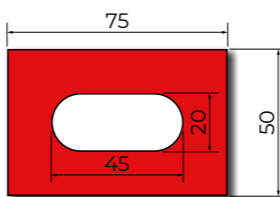

C45: 560-710 N/mm²

MPG100

835 mm	€ 710,-	55.0 kg
415 mm	€ 405,-	27.5 kg

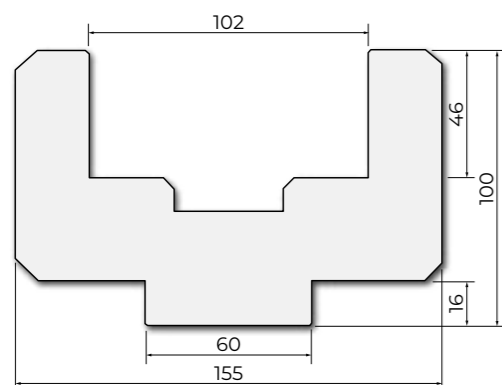

Polyurethane

GM 100X50

835 mm	€ 197,-	2.5 kg
415 mm	€ 110,-	1.2 kg

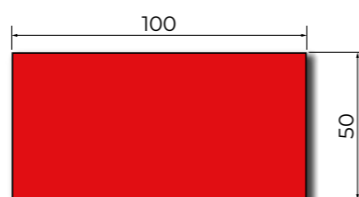

Polyurethane

GMF 100X50X20

835 mm	€ 299,-	3.0 kg
415 mm	€ 165,-	2.2 kg

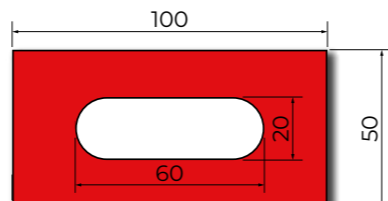

Cover plate and modifications

C45: 560-710 N/mm²

PSTCON - Cover Plate

	A [mm]	B [mm]	€	kg
PSTCON25	58	58	€ 28,-	1.2 kg
PSTCON50	108	75	€ 35,-	0.8 kg
PSTCON75	123	80	€ 38,-	1.0 kg
PSTCON100	153	80	€ 42,-	1.2 kg

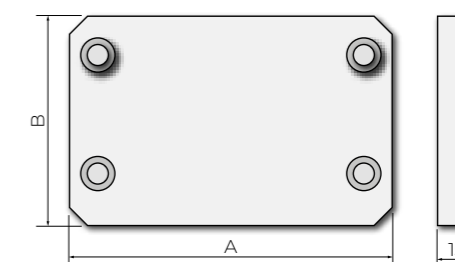

Tang modification example

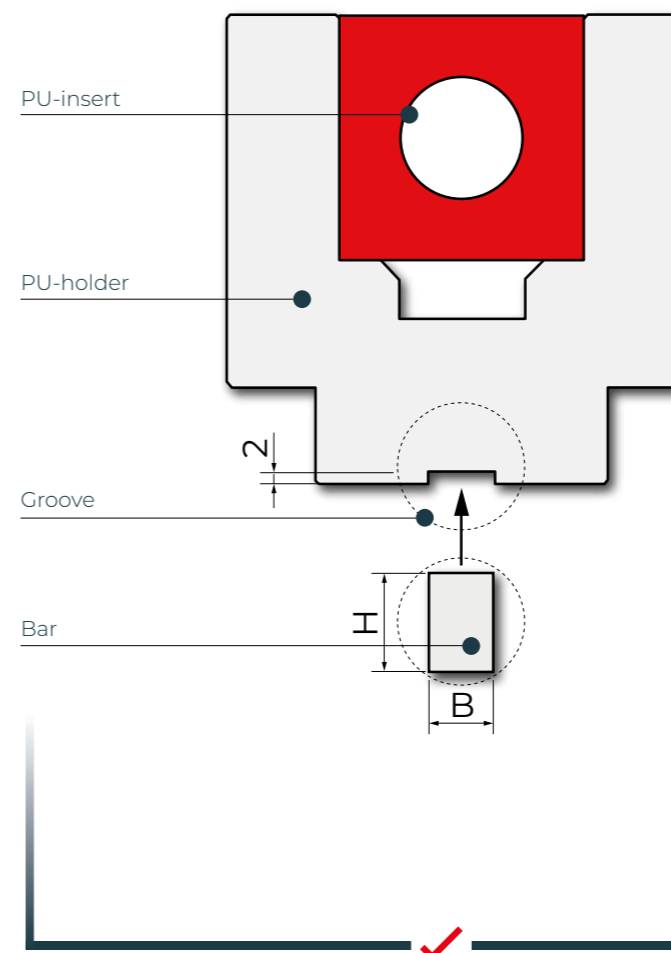

Synthetic Dies

Synthetic dies will be adjusted into the housing and secured with bolted screws

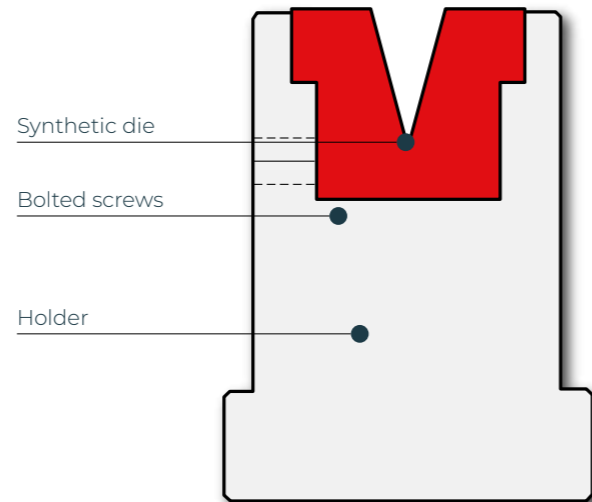
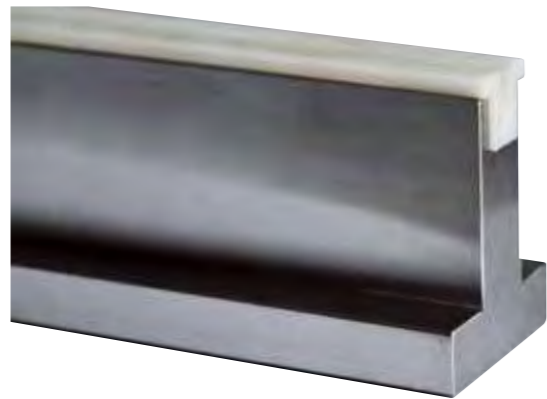

C45: 560-710 N/mm ²			1000 kN/m max.
TN80.14			(R1)
835 mm	€ 310,-	15.0 kg	
415 mm	€ 170,-	7.5 kg	

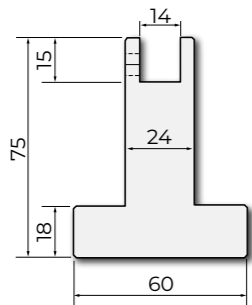

Synthetic			200 kN/m max.
INS14...			° V [mm]
835 mm	€ 143,-	0.30 kg	
415 mm	€ 84,-	0.15 kg	
INS14.06.88	88°	6	
INS14.08.88	88°	8	
INS14.10.88	88°	10	
INS14.06.60	60°	6	
INS14.08.60	60°	8	
INS14.10.60	60°	10	
INS14.06.45	45°	6	
INS14.08.45	45°	8	
INS14.10.45	45°	10	
INS14.06.30	30°	6	
INS14.08.30	30°	8	

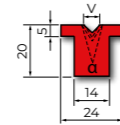

C45: 560-710 N/mm ²			1000 kN/m max.
TN80.20			(R1)
835 mm	€ 310,-	19.0 kg	
415 mm	€ 170,-	9.5 kg	

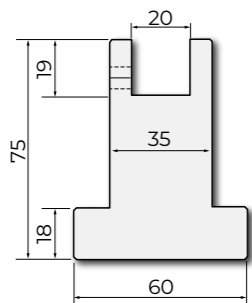

Synthetic			200 kN/m max.
INS20...			° V [mm]
835 mm	€ 158,-	0.4 kg	
415 mm	€ 89,-	0.2 kg	
INS20.06.88	88°	6	
INS20.08.88	88°	8	
INS20.10.88	88°	10	
INS20.12.88	88°	12	
INS20.16.88	88°	16	
INS20.06.60	60°	6	
INS20.08.60	60°	8	
INS20.10.60	60°	10	
INS20.12.60	60°	12	
INS20.16.60	60°	16	
INS20.06.45	45°	6	
INS20.08.45	45°	8	
INS20.10.45	45°	10	
INS20.12.45	45°	12	
INS20.06.30	30°	6	
INS20.08.30	30°	8	
INS20.10.30	30°	10	

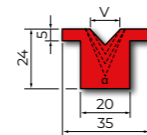

Synthetic Dies



C45: 560-710 N/mm ²			1000 kN/m max.
TN80.30			(R1)
835 mm	€ 310,-	25.0 kg	
415 mm	€ 170,-	12.5 kg	

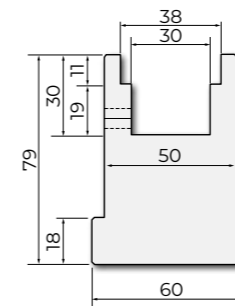

Synthetic			200 kN/m max.
INS30...			° V [mm]
835 mm	€ 158,-	0.5 kg	
415 mm	€ 89,-	0.3 kg	
INS30.06.88	88°	6	
INS30.08.88	88°	8	
INS30.10.88	88°	10	
INS30.12.88	88°	12	
INS30.16.88	88°	16	
INS30.20.88	88°	20	
INS30.25.88	88°	25	
INS30.06.60	60°	6	
INS30.08.60	60°	8	
INS30.10.60	60°	10	
INS30.12.60	60°	12	
INS30.16.60	60°	16	
INS30.20.60	60°	20	
INS30.06.45	45°	6	
INS30.08.45	45°	8	
INS30.10.45	45°	10	
INS30.12.45	45°	12	
INS30.16.45	45°	16	
INS30.20.45	45°	20	
INS30.06.30	30°	6	
INS30.08.30	30°	8	
INS30.10.30	30°	10	
INS30.12.30	30°	12	
INS30.16.30	30°	16	

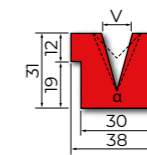

C45: 560-710 N/mm ²			1000 kN/m max.
TMN95.20			(R2) (R3)
835 mm	€ 378,-	12.0 kg	
415 mm	€ 216,-	6.0 kg	

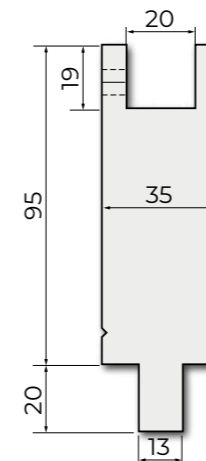

Synthetic			200 kN/m max.
INS20...			° V [mm]
835 mm	€ 158,-	0.4 kg	
415 mm	€ 89,-	0.2 kg	
INS20.06.88	88°	6	
INS20.08.88	88°	8	
INS20.10.88	88°	10	
INS20.12.88	88°	12	
INS20.16.88	88°	16	
INS20.06.60	60°	6	
INS20.08.60	60°	8	
INS20.10.60	60°	10	
INS20.12.60	60°	12	
INS20.16.60	60°	16	
INS20.06.45	45°	6	
INS20.08.45	45°	8	
INS20.10.45	45°	10	
INS20.12.45	45°	12	
INS20.06.30	30°	6	
INS20.08.30	30°	8	
INS20.10.30	30°	10	

