

Distribuitor : SM TECH SRL
S.C. SM TECH S.R.L.
<https://www.sm-tech.ro>
office@sm-tech.ro
Tel: 0374-991480
WhatsApp: 0745-528494

tools  **press**



tools**press** is a world-class designer and manufacturer of high quality press brake tooling and clamping systems.

ToolsPress is part of  **WILSON TOOL** Group of Companies since November 2012.

Through a great manufacturing program with more than thousands of standard model, we are able to guide your choice toward the best bending system in the fastest time, due to the long experience we made in 30 years.

The tight cooperation with our customers as technological partners allow us to better solve and improve their bending performance. The global market needs always more and more technology to very competitive prices in the shortest time. In this way our company develops manufacturing methods that allow us to meet the requirements of the global market.

World Presence

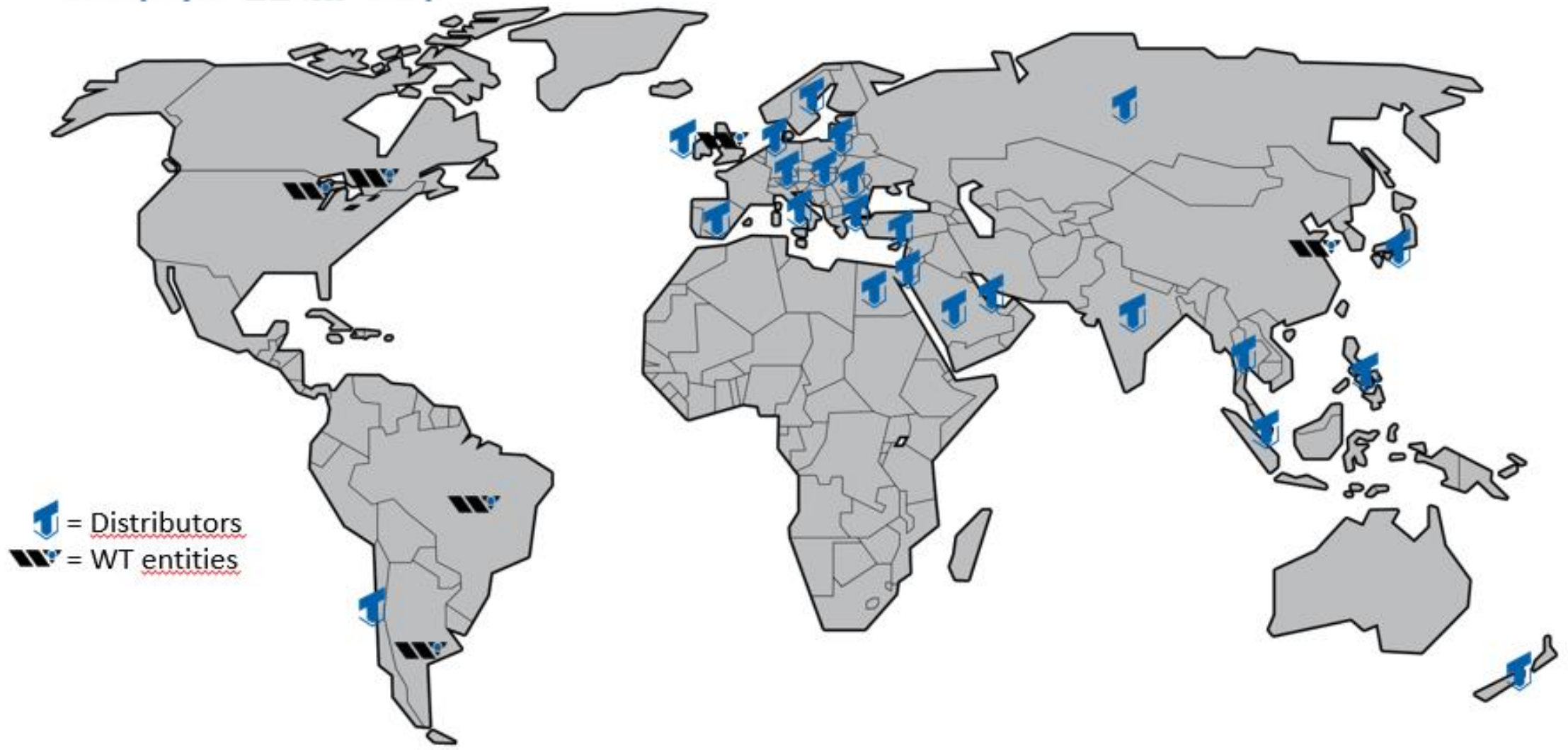

Catalogues

- **Wila Style**
- **Trumpf Style**
- **Amada Style**
- **Bystronic Style**
- **LVD (no stone radius)**

Expertise in manufacturing upon request:

- **Urzviken**
- **Colly**

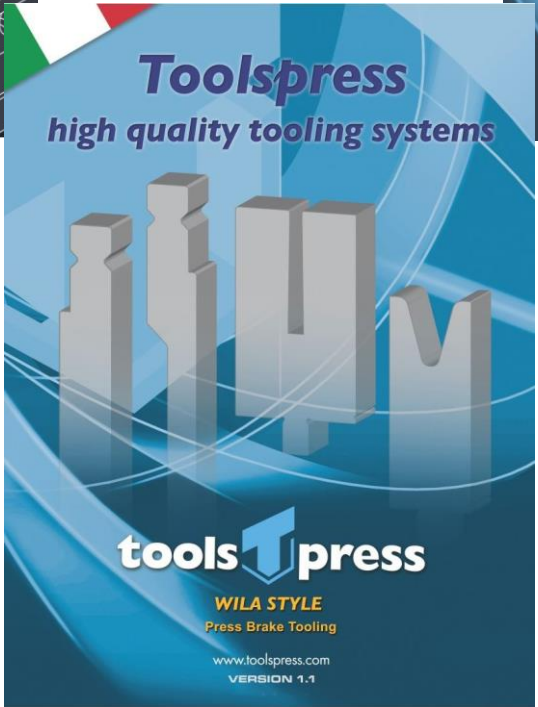
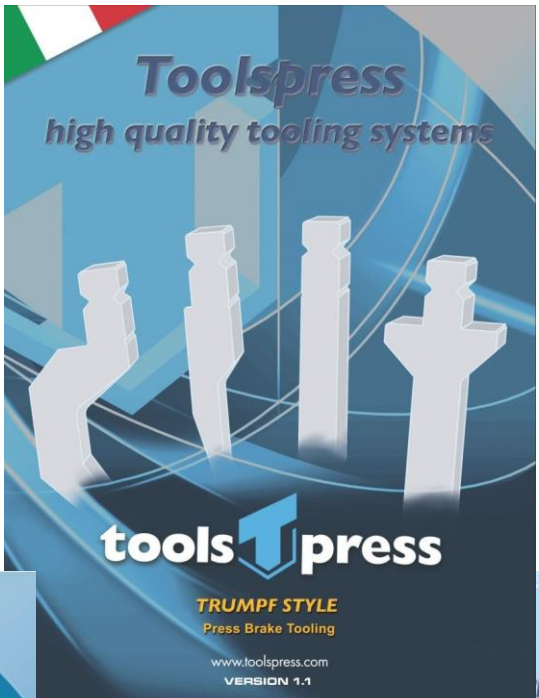



tools  **press**



Materials

We work two different quality of steel with three different types of heating treatment:

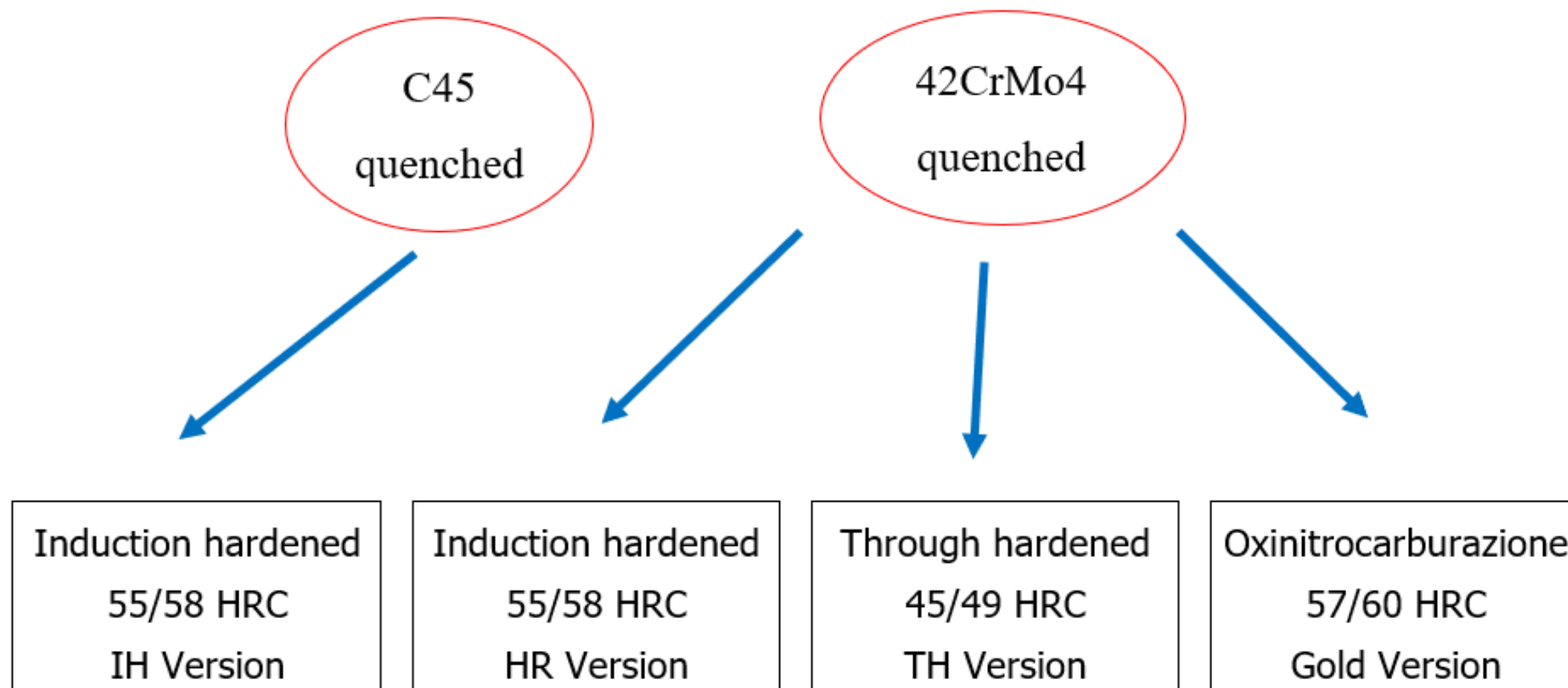

Product Range Differentiators

Induction hardening

Induction hardening treatment is the heating of the ferrous material with an inductor activated by high frequency electric voltage and in immediate succession, sudden cooling, in hot oil. Minimum induction hardening depth on working surfaces **5mm**.



Differentiators

EDM (electro-eroders) for sectional sets ensure the best possible quality surface finishing of cuts, dimensions and parallelism. Perfect matching between sections

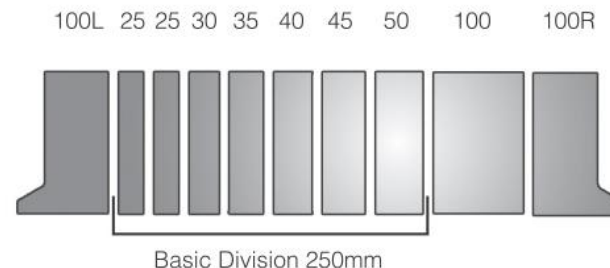
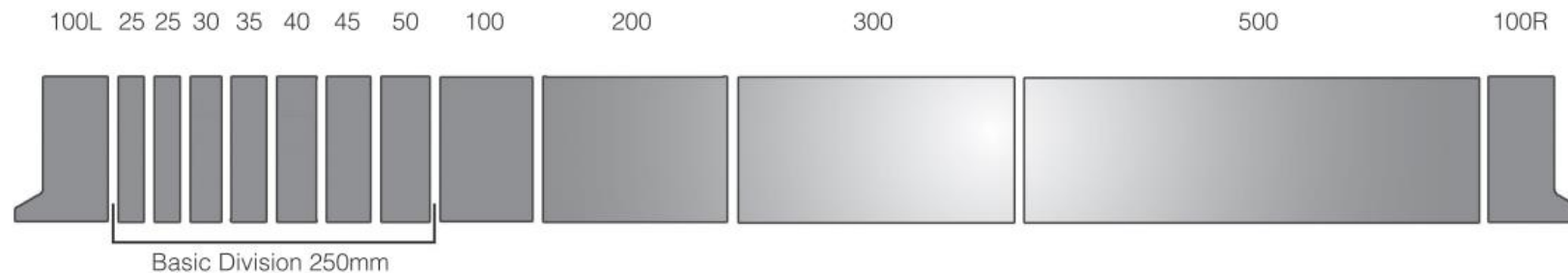



Hydraulic clamping WT style tools

EXPRESS RAIL

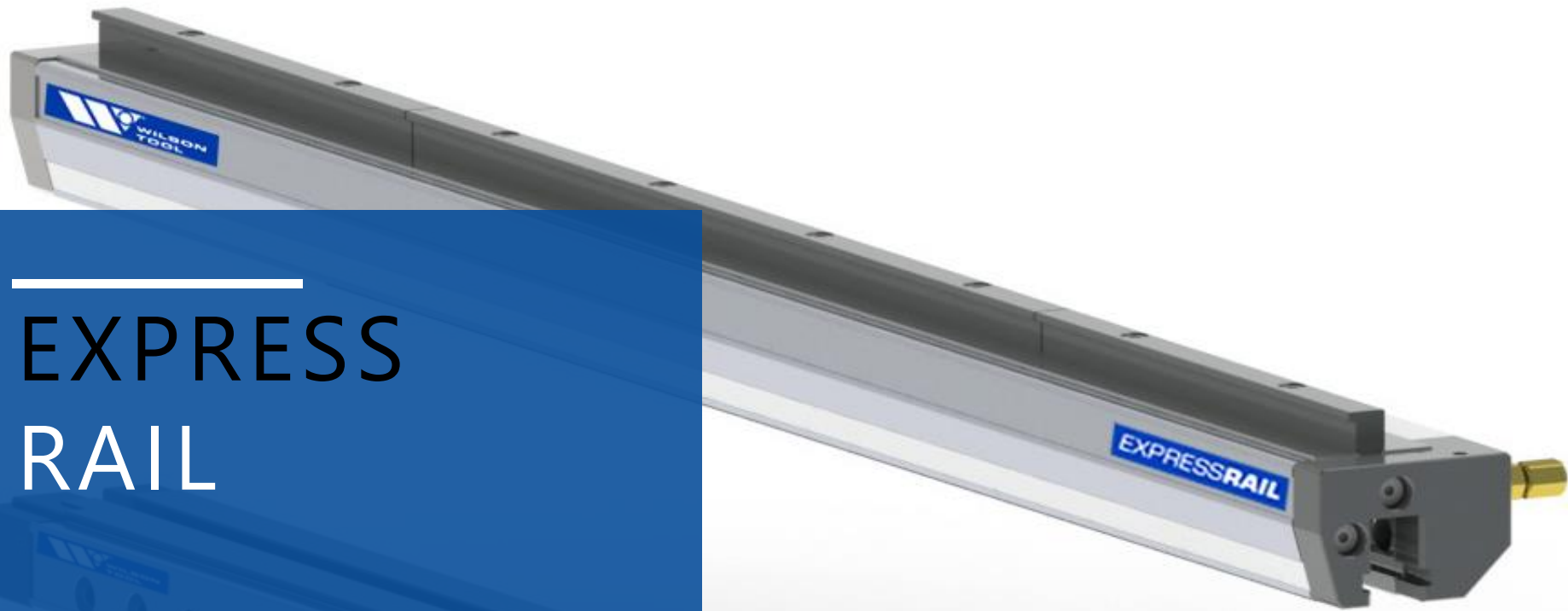

EXPRESS RAIL® 1000 | WT



Key Features

- Hydraulically clamps WT-style and all other similar 20mm wide tang punches
- Clamps tool segments as small as 15.8mm (.625")
- Low profile to maximize open height
- Nitrex® enhanced to 70 HRC
- Hydraulic power pack with multiple voltage options is needed if not able to integrate with the machine (pg. 39)

Specifications

- Operating pressure: 450-700 PSI (31-48 Bar)
- Flow Range: 5.7-8.3 l/min (1.5-2.2 GPM)
- Maximum tool lifting weight per foot is 91 kg (200 lbs)

Note: Lengths shown indicate the actual clamping surface. Add the length of the end cap to get the overall length.

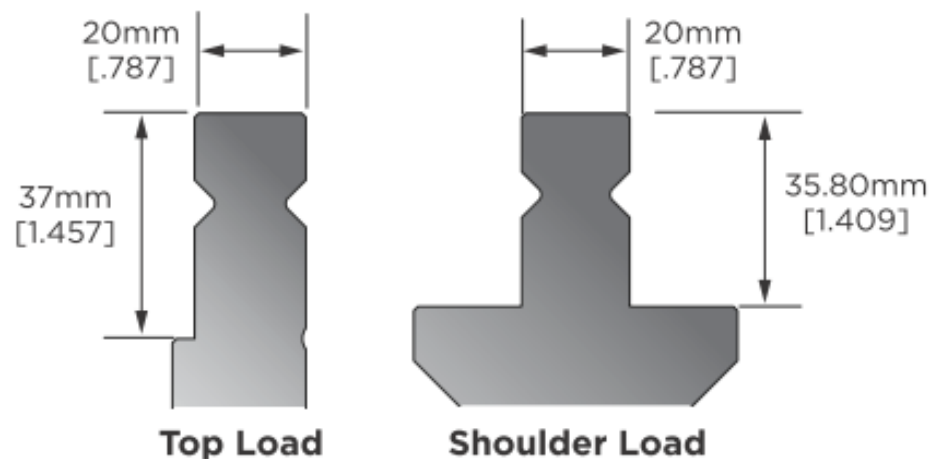

EXPRESS RAIL[®] 2000 | WT

Key Features

- Hydraulically clamps WT-style and all other similar 20mm wide tang punches
- Clamps tool segments as small as 15.8mm (.625")
- Low profile to maximize open height

- Hydraulic power pack with multiple voltage options is needed if not able to integrate with the machine (pg. 39)

Specifications

- Operating pressure: 450-700 PSI (31-48 Bar)
- Flow Range: 5.7-8.3 l/min (1.5-2.2 GPM)
- Maximum tool lifting weight per foot is 91 kg (200 lbs)

Note: Lengths shown indicate the actual clamping surface. Add the length of the end cap to get the overall length.

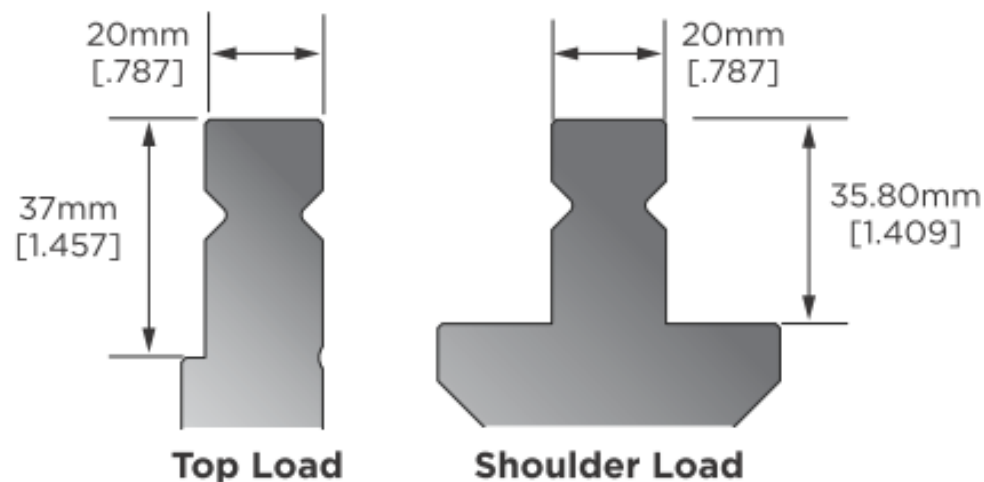

Retrofit

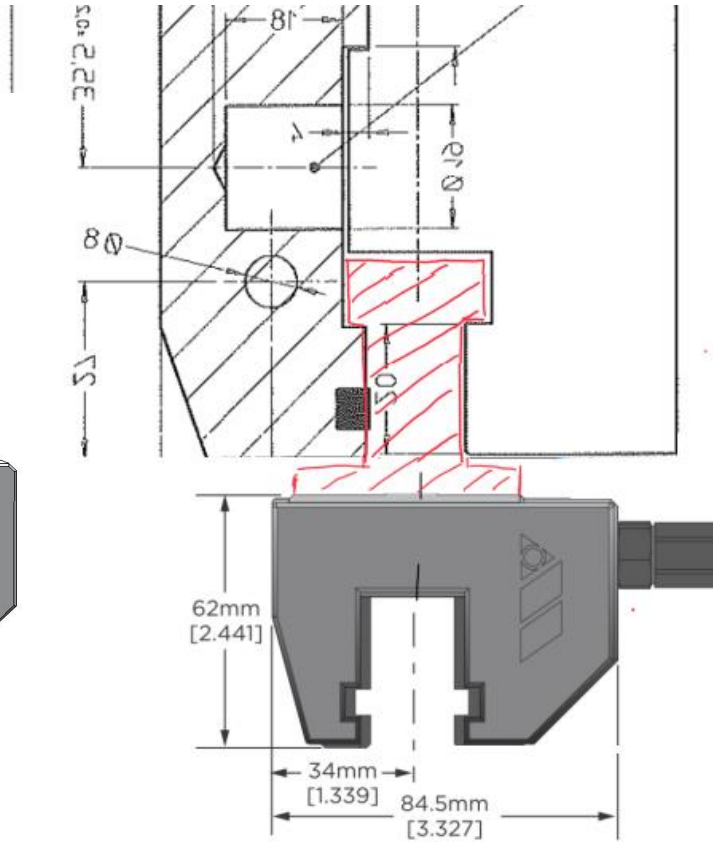
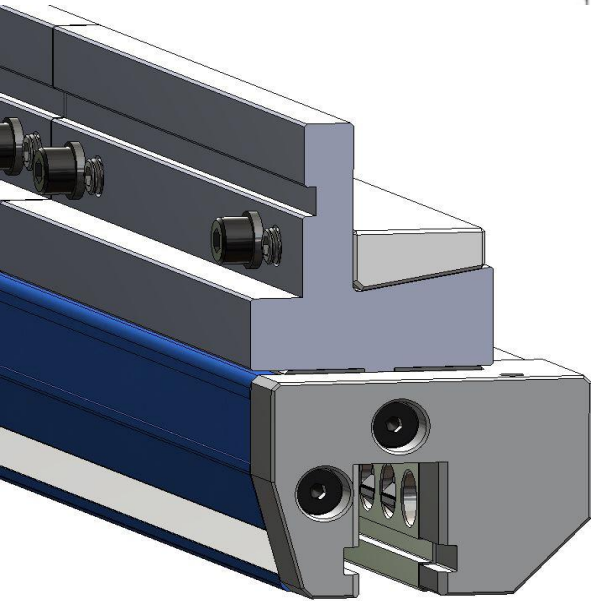

UPB

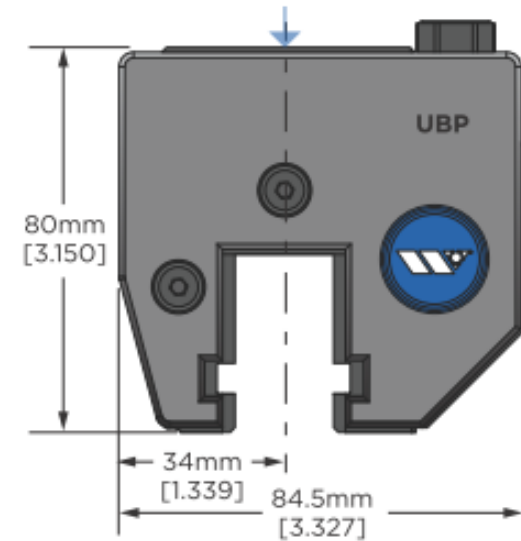

Distributor:
S.C. SM TECH S.R.L.
<https://www.sm-tech.ro>
office@sm-tech.ro
Tel: 0374-991480
WhatsApp: 0745-528494



Thank you!